

OUR PLAN OF PROGRESS



WHEELING PARK DISTRICT

A national finalist again

Park hoping to bring home the gold

There's an old saying about things being better the second time around.

Dave Phillips, Wheeling Park District superintendent, would agree. He recently learned the park district has been named a finalist for National Park and Recreation Gold Medal Award, given annually by the Sports Foundation, Inc.

The district was named in the same competition in 1977 as one of the top five park districts in the country in a city with a population under 20,000. This year, Phillips said the district is competing for the highest honor — a number one ranking and the gold medal.

"It's a tremendous honor for the district and its residents to be recognized two years in a row in this competition. We're pleased to be named again," he said.

Grand award winners chosen from the list of finalists in all population classes will be honored during the 1978 Congress for Recreation and Parks to be held Oct. 15-19 in Miami, Fla.

Until October, Phillips said the district

is working on a slide presentation and scrapbook to show to judges during the final phase of competition.

The award winners in each class are selected for improvement, service, continuing development, extent of future planning and degree of participant involvement and acceptance as determined by local needs for the respective park and recreation department program.

Phillips said he believes the district has fared well in each of those categories. He said the recreation program growth has been "outstanding."

He also cited the acquisition of Chevy Chase Golf Course and Country Club as an indicator of the "overwhelming support" of the community for the park district.

Phillips stressed the accomplishments of the park board and staff in preparing for future growth "as well as meeting existing needs." He said he thought the district's concern with open space and energy conservation would also be "considered in our behalf."

The Sports Foundation, Inc., is a

non-profit membership organization founded to stimulate interest and participation in sports-related activities. The foundation established the Gold Medal Awards for park and recreation management in 1966.

Other finalists in the under 20,000 population class are: Bend (Oregon) Metro Park and Recreation District; Bolingbrook (Illinois) Park District; the Department of Parks and Recreation for the City of Gaithersburg (Maryland); and Fairbanks (Alaska) North Star Borough Parks and Recreation Department.

Judges for the 1978 Gold Medal Awards are: Jackson M. Anderson, coordinator of graduate study, Central Michigan University; Robert M. Artz, director and general manager of Simi Valley (California) Recreation and Park District; Ted B. Fleckinger, director of the Great Lakes Region, National Recreation and Parks Association, and Ralph C. Wilson, chief recreation specialist, Department of Agriculture, Washington, D.C.



Park district is finalist

WHEELING — Wheeling park district has been selected as a National Gold Medal award finalist in park and recreation management by The Sports Foundation Inc. The Gold Medal awards recognize excellence in park and recreation administration in communities throughout the United States.

Finalists for the award are chosen from five classes, according to population size of their respective communities. The Wheeling park district is a finalist in Class V which includes all cities with a population under 20,000. The superintendent of parks and recreation in Wheeling is David Phillips.

Other finalists in Class V are: Bend (Oregon) Metro Park and Recreation district; Bolingbrook Park District; the Department of Parks and Recreation for the City of Gaithersburg, MD; and Fairbanks, AK North Star Borough Parks and Recreation department.

Grand award winners chosen from the list of finalists in all classes will be honored during the 1978 Congress for Recreation and Parks to be held Oct. 15 to 19 in Miami, FL.

The award winner in each class will be selected for improvement, service, continuing development, extent of future planning and degree of participant involvement and acceptance as determined by local needs for the respective park and recreation department program.

WHEELING PARK DISTRICT

222 S. WOLF ROAD
WHEELING, ILLINOIS
60090 312/537-2222

TO: Wheeling Park District Employees
FROM: Dave Phillips, Superintendent of Parks & Recreation
RE: Gold Medal Finalist
DATE: August 30, 1977

Just a short note to let you know that the Wheeling Park District has been chosen as one of five "Finalists" in the annual awards program sponsored by "The Sports Foundation, Inc." for excellence in park and recreation management.

This competition is among Recreation Departments and Park Districts throughout the United States and Canada. Finalists for the Gold Medal Award are chosen from five classes based on the population of the communities. The Wheeling Park District is a finalist in Class V, which includes all cities and villages with a population under 20,000.

Other finalists in Class V are:

1. The Recreation and Park Department of Mountlake Terrace, Washington
2. The Sterling Park District, Sterling, Illinois
3. The Park and Recreation Department of Sylacauga, Alabama
4. The Park & Recreation Department of Smyrna, Georgia

Grand Award winners are chosen from the five finalists and presentations will be made during the 1977 Congress for Recreation & Parks in Las Vegas (October 2 - 6th).

As employees, we all share equally in this honor. Without each of you, our programs, activities and facilities could not be enjoyed by the residents of the Wheeling Park District, and we could not be recognized, as we are now, as one of the top leisure service agencies in North America.

Thank You.

serving the community

REFERENDUMS

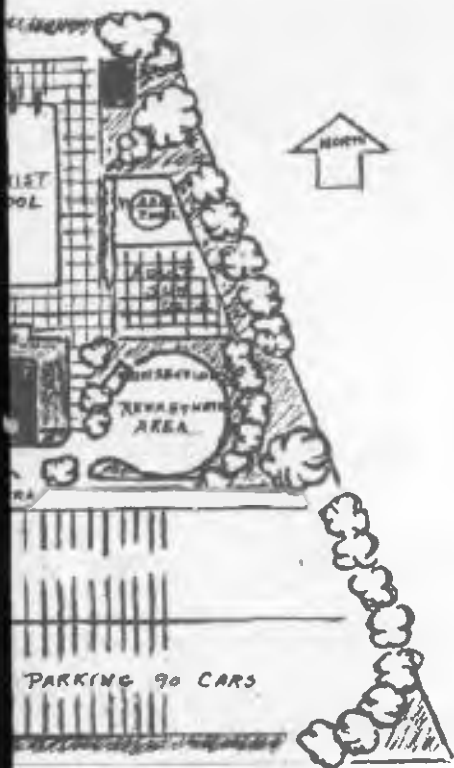

ase the present out-
ark (Wheeling Com-
f the pool, the park
facility for the enjoy-
in the existing bath-
hower facilities. The
er lighting improved.
into a "beauty spot"





Now Is Your Opportunity

It has been evident that Wheeling needs two pools. One, a pool and building that will serve as year around recreational facility and the other, the Wheeling Community Pool for summer swimming and sunning. The Wheeling Park Board has long been aware of the communities recreational needs and are offering you, the citizen of the Wheeling Park District, an opportunity to realize these facilities for you and your family. They urge you to cast your Ballot on Saturday, June 14, 1969. For your review, may we present the following information:

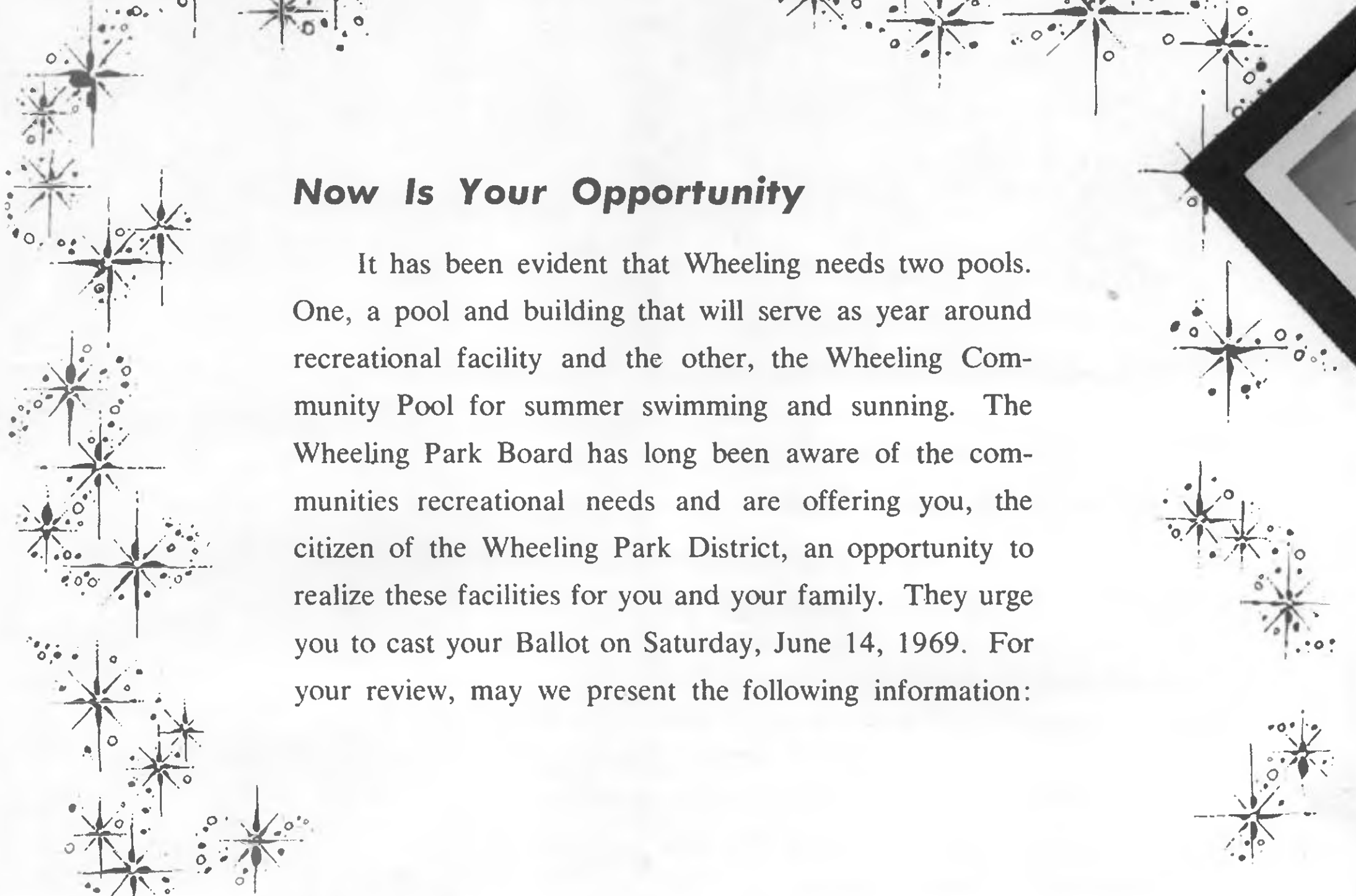

Construction Begins Soon

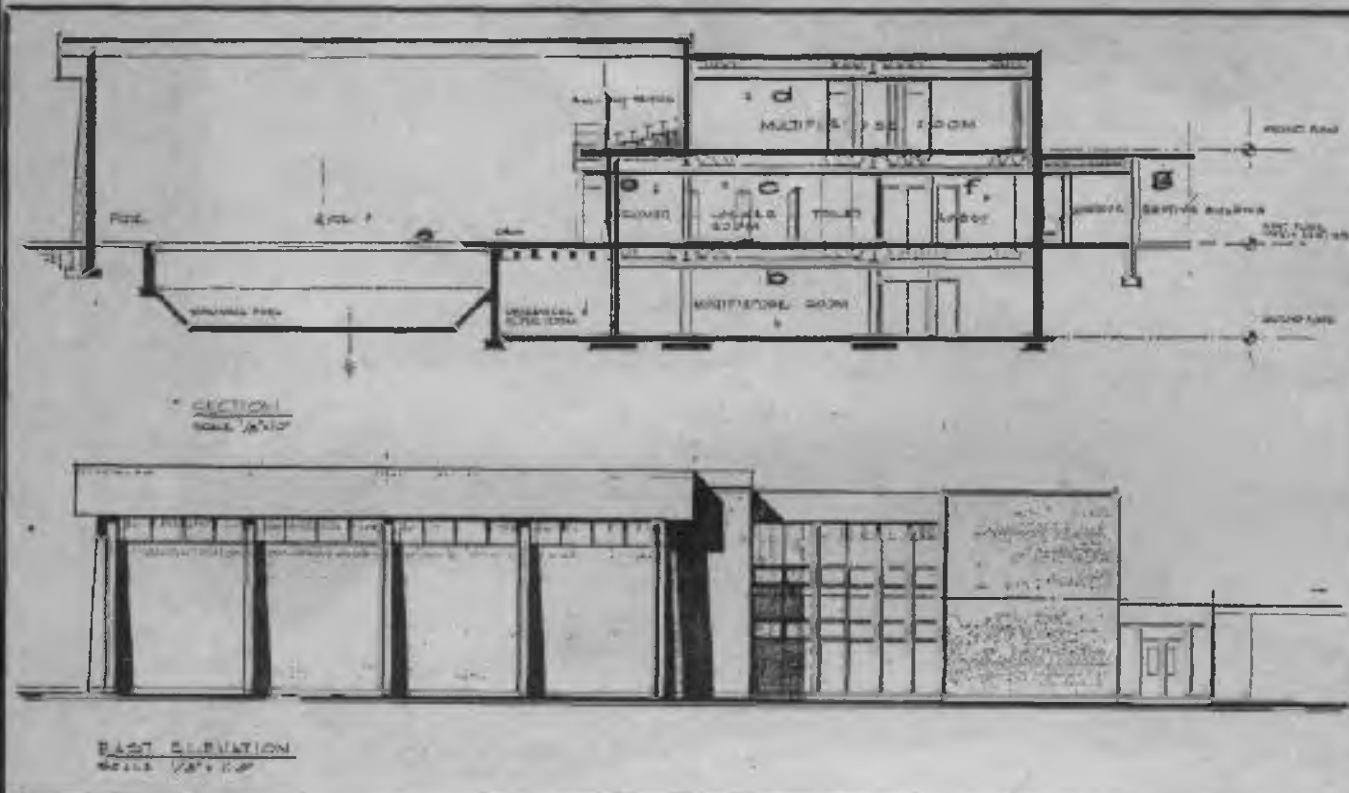

The Wheeling Park District pool will be added to WHS. The all year round pool should be in use by the fall of 1970.

- a. Pool
- b. Multipurpose room
- c. Locker room
- d. Multipurpose room
- e. Shower
- f. Lobby
- g. Existing building

This week will hopefully mark the beginning of construction of Wheeling High School's new swimming pool. A bid by Regner Olson to the job for \$658,950 was accepted by the Wheeling Park District last week. Construction of the olympic size pool, to be located in what is presently the southeast field, will be carried on throughout the winter, protected by a polyethylene shield. Completion is expected by the opening of school in the fall of 1970.

The pool will be housed by a 3-story building which will have locker facilities, various multi-purpose rooms, and the additional luxuries of a sauna bath and outdoor patio. Besides being used by swimming classes during the day, the pool will sponsor swim meets, and will be open to the public in the evenings.

HIGH SCHOOL DISTRICT #214— WHEELING PARK DISTRICT JOINT AGREEMENT

Neptune's Pool, the indoor pool adjacent to the Wheeling High School, at the corner of Hintz and Elmhurst Roads, was built in the cooperative agreement with High School District #214 and the Wheeling Park District. The Park District purchased one acre of land for \$1.00 from the school district in order to build the Indoor Swim Center Complex and entered into a 20 year renewable lease on the facility with the High School District for its "physical education and competitive programs and events."

The Park District and School District agreed to divide the "actual cost of operations, maintenance, replacement and repairs," according to percentage of use per year which is 55% to the school and 45% to the Park District. The School and the Park summed up the 1969 agreement by saying that:

"It is the purpose and intention of the parties hereto through this agreement to obtain a maximum use of the recreation and physical education facilities to be provided for the inhabitants of the park and school at the most economical cost to the residents and taxpayers of the School."



1972 REFERENDUM

BULK RATE
U. S. POSTAGE
PAID
PERMIT NO. 51
WHEELING, ILL.

*Serving Your Community
the*

WHEELING PARK DISTRICT

URGES YOU TO

VOTE!

for

A Sound, Realistic Park
Development Program
for Wheeling on this
Saturday, December 16
THINK PARKS



Will Rogers once said, "The Good Lord is makin' more people, but He ain't makin' more land."

FUNDS DONATED BY

"FRIENDS OF THE PARK"

CHAIRMAN HANS REHDEES

Help YOUR Park District Help YOU!

HOW YOUR LOCAL TAX DOLLAR SERVES YOU

WHEELING PARK DISTRICT

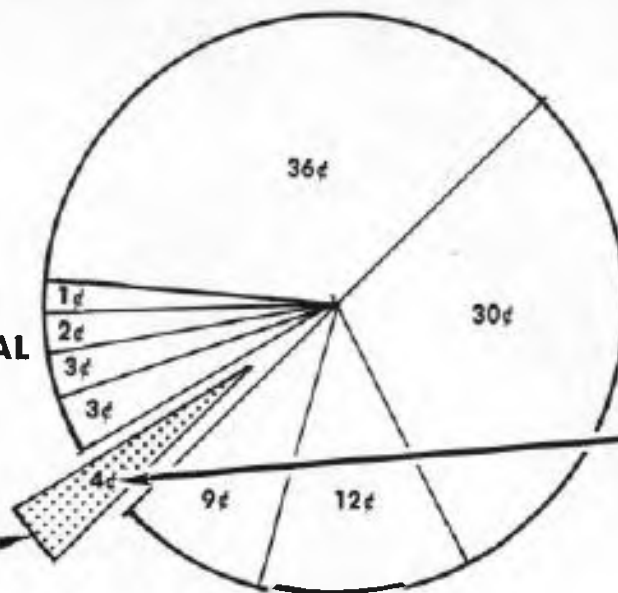

- 36¢ School District #21
- 30¢ High School District #214
- 12¢ County, Metro, Government
- 9¢ Wheeling Village
- 4¢ WHEELING PARK DISTRICT
- 3¢ Wheeling Library
- 3¢ Township Fire Protection
- 2¢ Junior College District #512
- 1¢ Wheeling Township

(The Wheeling Park
District receives
4¢ out of
your tax \$1.00)

HOW MUCH WILL THIS COST?

The total value of all development in the program — is approximately \$1.2 million of which \$700,000 is raised locally with \$500,000 Federal Grant monies.

HOW WILL THIS AFFECT REAL ESTATE TAXES ON YOUR PROPERTY?

The average cost per homeowner will be about 7.0 cents per \$100 assessed valuation. Or, to consider the relative value of the program, recognize that this program will increase your total tax bill by less than 1%.

If Your Equalized Assessed Valuation is	The Annual Tax Increase will be
4,000	2.80
7,000	4.90
10,000	7.00

As the Park District continues to grow and the total assessed valuation of the District increases—your tax bill will be lower. In other words, each new industry and each new home will share the cost of the program, and your share will be less. You can see that the total cost to you will be only a few pennies a day. In return, you and your family will enjoy all the priceless advantages of having recreational facilities designed to meet your needs—now, and in the years to come. With continually increasing costs of construction, this is an opportunity that can never again be available at a price so low.

HOURS TO VOTE:

6:00 A.M. to 6:00 P.M. — SATURDAY, DECEMBER 16, 1972

Absentee Ballots may be obtained at Heritage Park after December 1, 1972

POLLING PLACES:

- Heritage Park, 222 South Wolf Road, Wheeling, Illinois
(Homes east of the Soo Line Railroad Tracks)
- Jack London Junior High, 1001 W. Dundee Road, Wheeling, Illinois
(Homes west of the Soo Line Railroad Tracks)
- Buffalo Grove residents - 872 Sussex Court, Buffalo Grove.

Your Park Board now asks your approval to acquire and develop these park and recreation facilities.

For further information call 537-2222.

WE HAVE THE PLAN AND NEED THE LAND

Phone: (312) 537-2222



Wheeling Park District
222 South Wolf Road
Wheeling, Illinois 60090

Dear Park District Residents,

Over the last 12 months, your Park Board has researched the need for, and feasibility of, expanding our services by improving dramatically Park and School land presently in our district, by acquiring more land to better meet your needs, and by providing additional recreational facilities for year-round recreational use.

The improvements as described in this brochure can immediately become a reality in our community. The 10 park and school sites shown on the inside of this brochure are now available for park and recreation improvement. The Park District is now prepared to embark upon its next community-wide neighborhood development program.

On Saturday, December 16th, 1972, the Wheeling Park District will submit a comprehensive program for growth and development of parks and open space to YOU, the residents of our District. The program is a direct reflection of those suggestions and priorities which you have expressed as being necessary to meet the Park and Recreation needs of your community. The need for park and recreation facilities is becoming more and more critical in view of the tremendous residential growth in the Wheeling area.

We have a responsibility to our families and our community to provide open space lands while it still exists. The time to act is NOW. Our Parks and Recreational facilities can be our communities greatest asset.

Your consideration of this dynamic community improvement program and subsequent YES vote on December 16th is needed.

Lorraine E. Lark
Lorraine E. Lark
President
Board of Commissioners
Wheeling Park District

Affiliated with I.P.R.A.

BOARD OF COMMISSIONERS

Lorraine Lark President
Gus Nizzi Vice-President
Robert E. Ross Commissioner
Eugene Sackett Commissioner
Alf Wilson Commissioner
William F. Blank Treasurer
Roger A. Bjorvik Attorney

ADMINISTRATIVE STAFF

David F. Phillips Superintendent of Parks
and Recreation
Robert Ruley Director of Maintenance
Richard Haddock Recreation Supervisor
Patricia Hancock Secretary

**VOTE YES
ON DEC. 16**

• FOR BEAUTIFUL
PARK & SCHOOL
LAND

• FOR A BETTER COMMUNITY

• FOR WHOLESOME RECREATION
FOR OUR CHILDREN

THE MASTER PLAN

VOTE **YES** **X**
DECEMBER 16th
ON THE PROPOSED
PARK DISTRICT
BOND ISSUE.

WHAT IS NEEDED AND PROPOSED?

Our Master Plan points out the need for:

1. Neighborhood Park-School Development to serve as many residents as possible.
2. A Maintenance Garage
3. Land Acquisition — for a community park on the west side of Route #83.
4. Pool Improvements.
5. Heritage Recreation Center improvements.

WHY NOW? The Wheeling Park District is proposing the comprehensive park program to the people on Saturday, December 16th because:

1. Open space land is rapidly diminishing in the Wheeling area.
2. Construction costs are increasing at the rate of 1% per month, making the proposed facilities only more expensive if we wait.
3. The total assessed valuation is increasing each year with new residential and industrial development, the obligations to the homeowner will be reduced over the next few years.
4. The facilities will provide a wide range of programs and activities to satisfy the recreational demands of the residents.
5. Federal funds may not be available after January 1, 1973.

YOU, the residents of the Wheeling Park District will be given the opportunity to provide these needed facilities on December 16th.

**YOUR PARK BOARD URGES YOU TO
CAST A VOTE FOR THE FUTURE**

	YES	NO
PARK AND RECREATION IMPROVEMENTS FOR A BETTER WHEELING COMMUNITY	X	

*Serving Your Community
the*

WHEELING PARK DISTRICT

URGES YOU TO

VOTE!

for

**A Sound, Realistic Park
Development Program
for Wheeling on this
Saturday, December 16
THINK PARKS**



Will Rogers once said, "The Good Lord is makin' more people, but He ain't makin' more land."

FUNDS DONATED BY
"FRIENDS OF THE PARK"
CHAIRMAN HANS REHDERS

BASKETBALL COURT

HUSKY PARK

WITH REFERENDUM FUNDS
TOT PLAY AREA
PLAYGROUND EQUIPMENT
PARK WALK
TENNIS COURT w/BASKETBALL
GRADING AND SEEDING

WITH FEDERAL FUNDS
TOT PLAY AREA
PLAYGROUND EQUIPMENT
PARK WALK
TENNIS COURT w/BASKETBALL
GRADING AND SEEDING

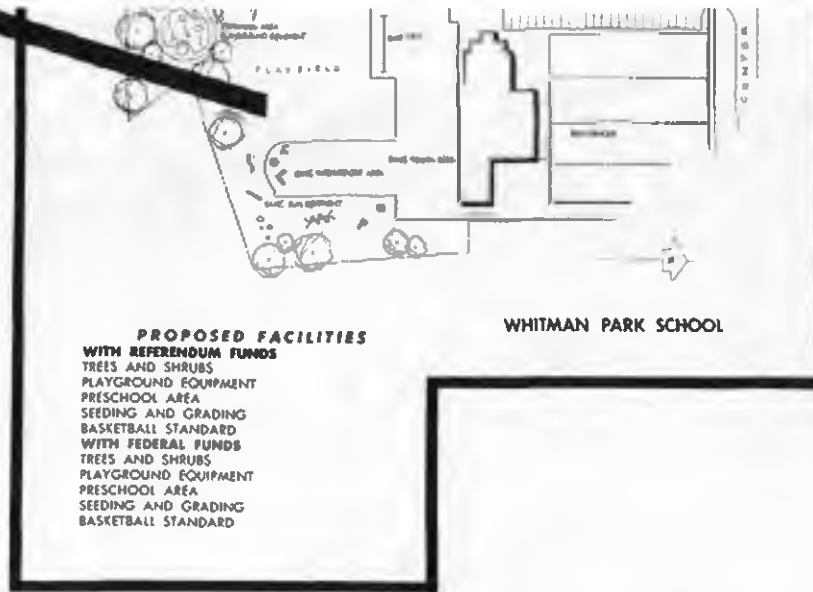
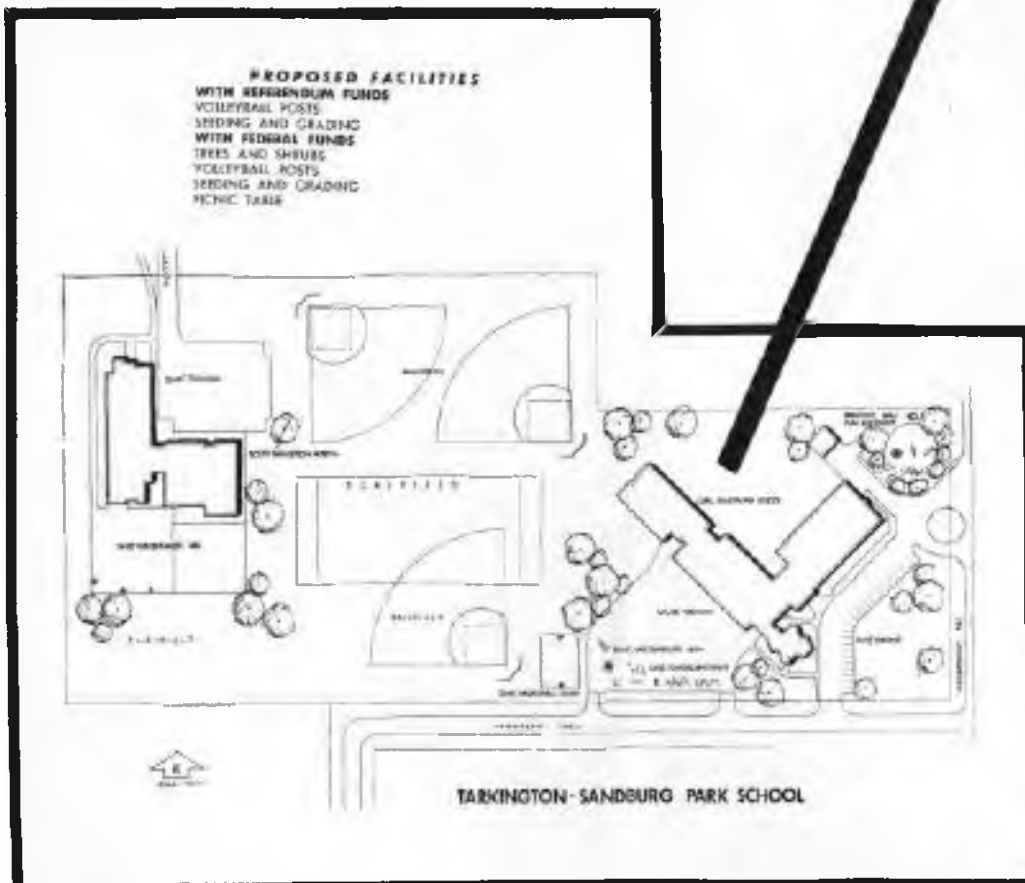

KEY

----- park district limits

●●●● neighborhood boundaries

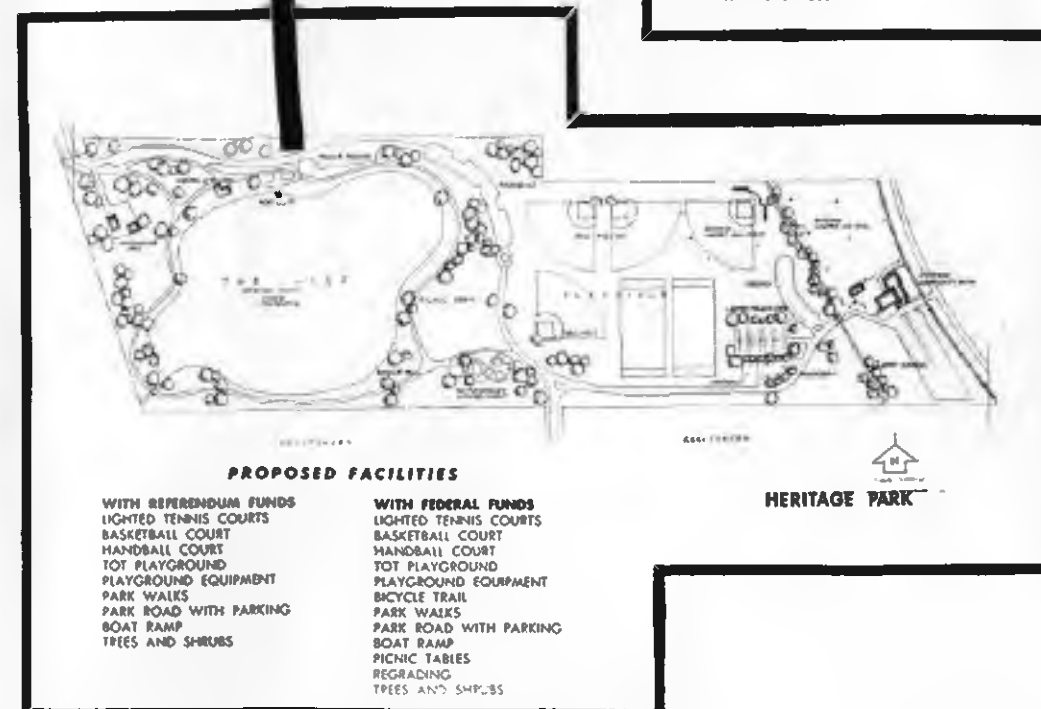
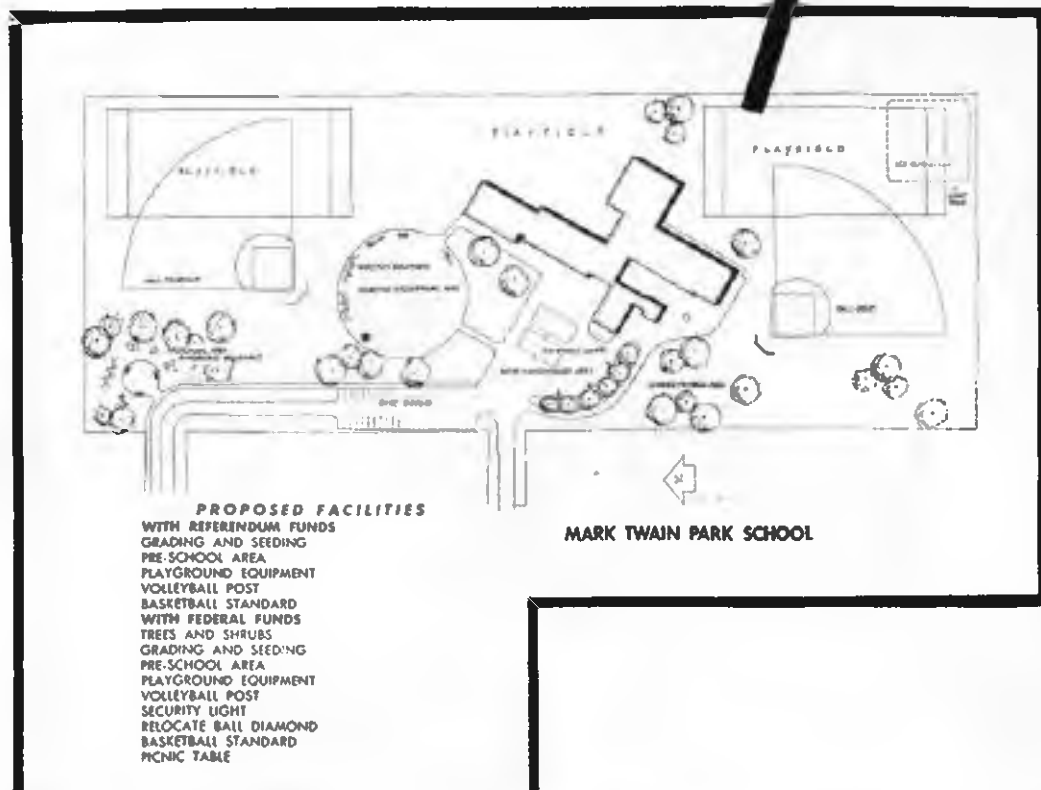
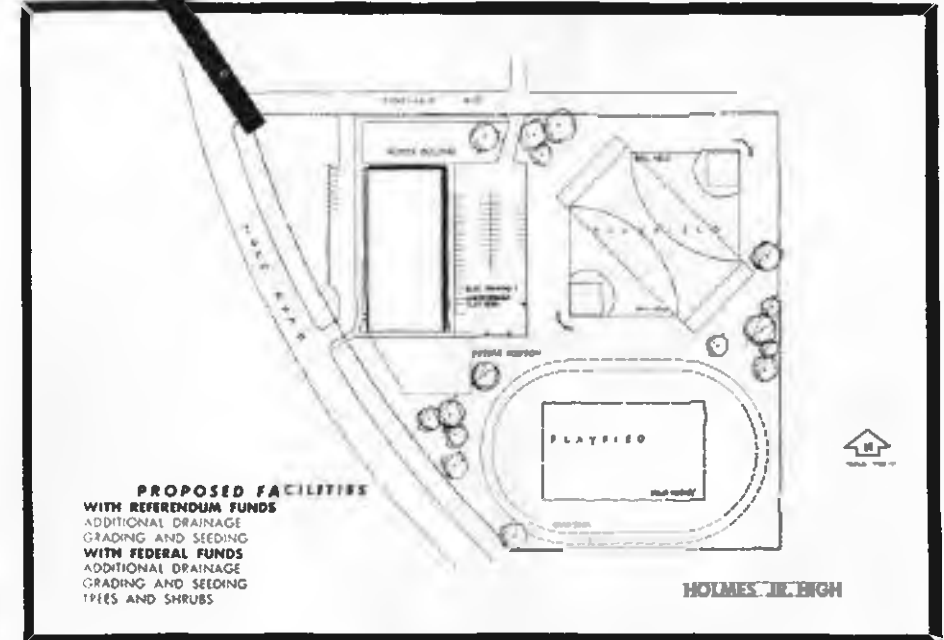

PLANS FOR YOUR LEISURE

WHEELING PARK DISTRICT

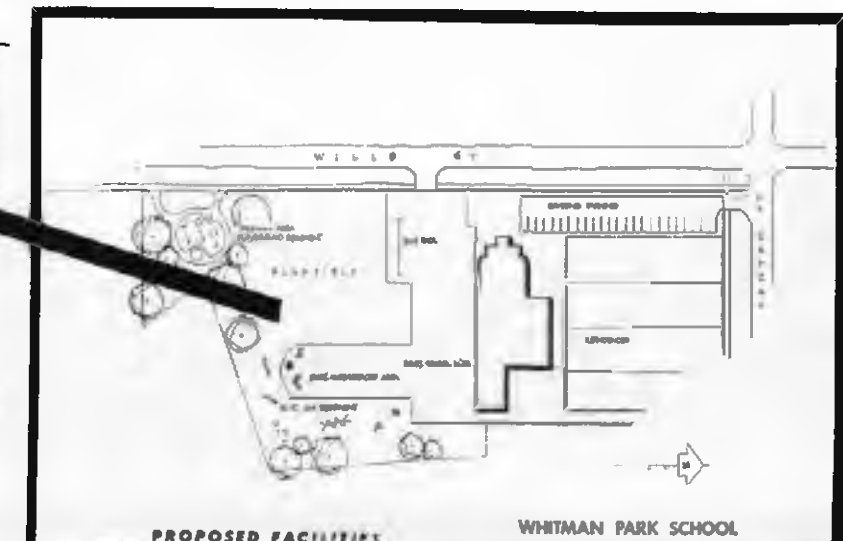
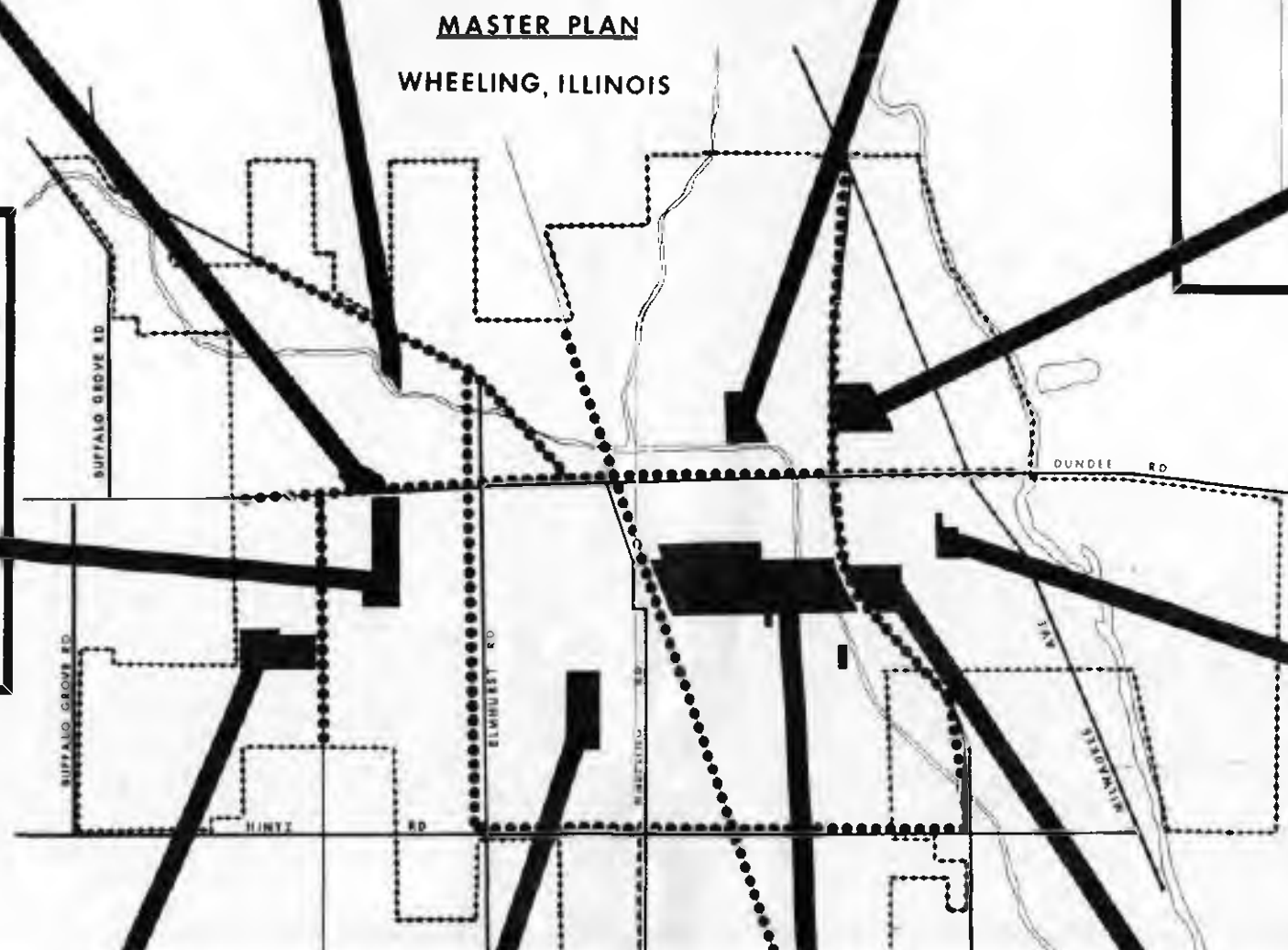
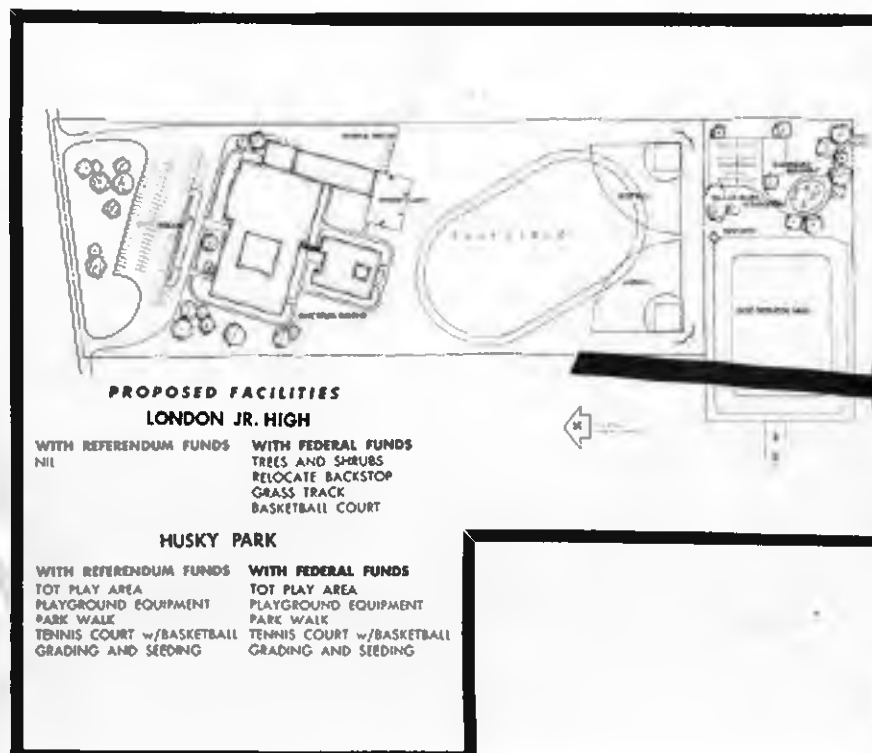
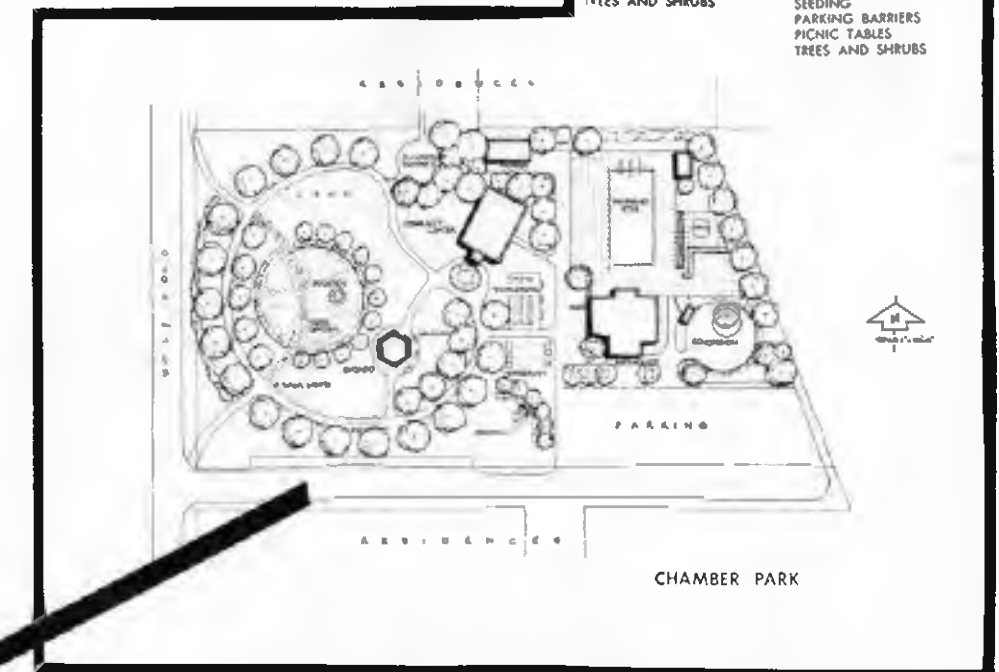
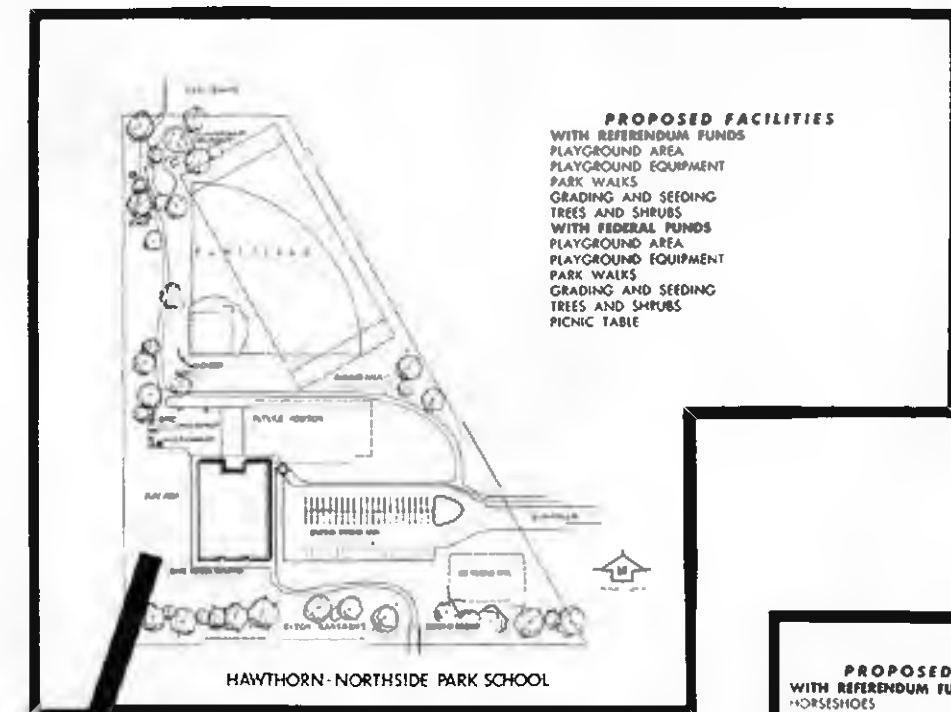
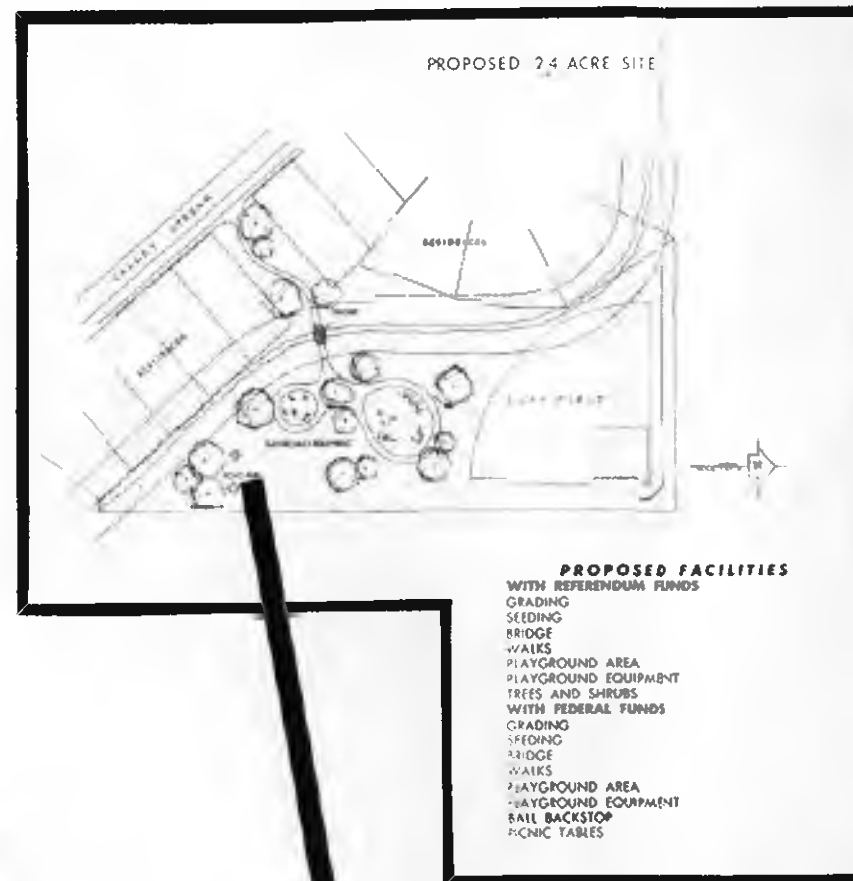
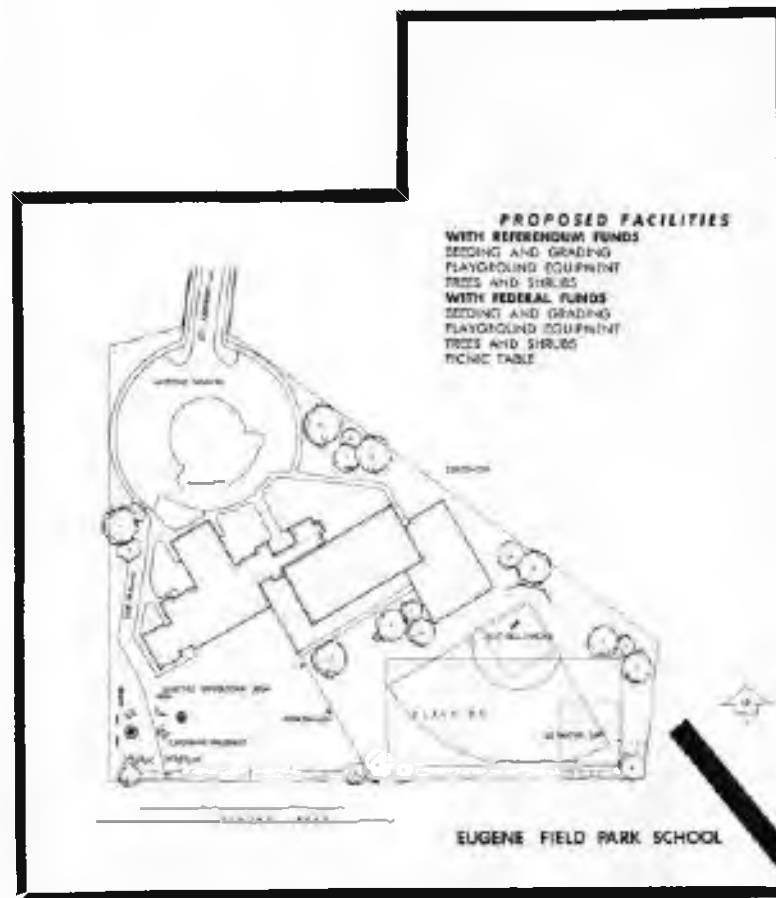

And It Will Stay That Way

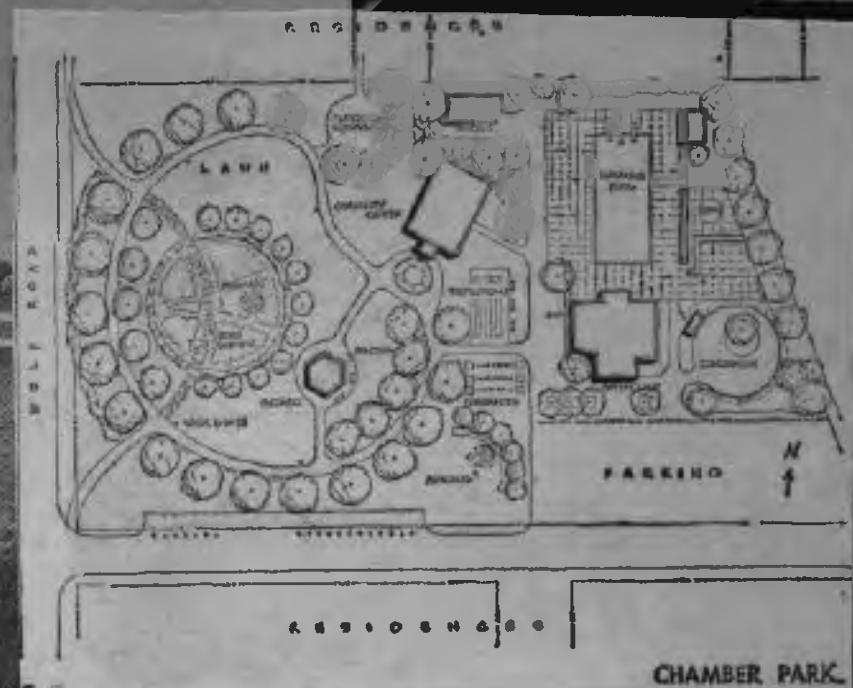

COMMUNITY CENTER

Proposed improvements would add the finishing touches to this quiet park site.

Commerce Park For All Ages—

Editor's note: This is the first in a series examining the condition of the parks in the Wheeling Park District, and the improvements planned in a \$700,000 referendum to be voted on Dec. 16.

by LYNN ASINOF

Chamber of Commerce Park has a split personality. The front three acres of park land are used mainly by adults and senior citizens. The back three acres are occupied by the outdoor community pool used mainly by children.

Because this type of double usage seems to fit Wheeling's needs, the park district plans to continue developing the park for these two purposes when it begins its park improvement program.

With funding from a bond issue that will go to the public Dec. 16, the park district plans to make the front three acres an area to be used mainly by senior citizens.

Plans now call for extensive landscaping, which would define the quiet character of the park. A rose garden will be planted with funds that have been raised by local school children. Asphalt

walks will run through the park with park benches available for afternoon conversation.

HORSESHOE pits and a shuffleboard court would provide some diversion for the senior citizens who live near the park area. Safety lighting would make the park usable at night as well as during the day.

Other basic improvements would make the park more usable. These include resurfacing of the parking lot, installation of parking barriers and seeding.

In all, approximately \$43,340 from the \$700,000 referendum is earmarked for Chamber of Commerce Park. Federal matching funds would add another \$60,940 to this amount.

If the federal funds are available, they will be used for additional landscaping, a water fountain and a gazebo that could be used for afternoon concerts in the park. Picnic tables and the relocation of the park memorial from Heritage Park would also be paid for with federal funds.

ALTHOUGH THE playground aspect of

the park is not being stressed in the proposed referendum plans, there will be a tot lot for preschool children. This play area would be set off from the rest of the park by landscaping.

Park Supt. Dave Phillips said Chamber of Commerce Park is a heavily used area because it is located in a well-traveled section of town. "It's been a very important park area because it is community oriented," he said.

Interest in the park began when the land was purchased from the Chamber of Commerce. The community building at the park is a historic church moved to the site with the help of the Historical Society and others in the village.

The church now provides one of the few places where various clubs and civic organizations can meet. The building is so popular as a meeting place that it is booked almost every day of the week.

PHILLIPS explained that Chamber of Commerce Park is one of the few recreation areas in town that has been continually upgraded. He said plans for the de-

sign of the park were originally laid out in a study done in 1968, and that the park district has closely followed these plans.

For example, the park district moved the ball field from this site to Northside Park this spring to de-emphasize the more active recreational uses of the park. Phillips explained that children who are old enough to play ball had other facilities in the area, and therefore did not miss the playfield.

Improvements for the outdoor pool section of the park will be financed completely with federal funds. Phillips said the plans call for a roof on the locker sections to reduce maintenance and protect the building from winter weather.

He said the park district also plans to install a new entrance to the pool that would direct people to the cashier's booth and establish a better traffic flow.

Phillips said that Chamber of Commerce Park is now approximately 75 per cent developed and that the referendum work would complete its development. "It's like the frosting on the cake," he said.

Is Key To Park System

Editor's note: This is the third in a series examining the condition of the parks in the Wheeling Park District, and the improvements planned in a \$700,000 referendum Dec. 16.

by LYNN ASINOF

Improvements planned by the Wheeling Park District for the school-park sites sound almost too basic to cost \$57,860, but in fact they are the heart of any park system.

Presently the playfields at the school sites are rough, rocky and full of chuckholes. They are difficult to play on, and even more difficult to mow and maintain.

So the park district is planning to use money from the upcoming \$700,000 park improvements referendum to grade, seed and landscape these sites. These basic improvements will not only provide more attractive play sites, but will also im-

prove drainage and increase their usability.

Park Supt. Dave Phillips cited Mark Twain School as a prime example of a playfield that is not suitable for recreation in its present form.

"THE KIDS really cannot play safely on land like that," he said. Phillips explained that youngsters might trip over rocks or chuckholes and end up with twisted ankles.

He added that the present condition of the sites has not kept children from using them, but does limit the number of children who play there. "Kids not only need open space to play, but they like to play at a nice ball field," he said.

According to Phillips, the most extensive grading and seeding work will be done at the Mark Twain site. In addition, drainage work will be done at Oliver Wendell Holmes Junior High, Booth Tarkington, and Carl Sandburg schools. All other sites, with the exception of Jack London Junior High School, will also be graded, seeded or landscaped.

The school-park sites are presently rather expensive to maintain. Mowing is made difficult by the rough grading, and loose rocks and chuckholes often damage the expensive mowing equipment.

PHILLIPS SAID improved grading, seeding and landscaping would substantially reduce the cost of mowing, which is presently estimated at \$3,985 per year. "If we can get the ground landscaped properly it will take us less time to mow, and therefore save money, man hours and wear on equipment," he explained.

Another important aspect of the school-park site improvements is the installation of tot lots for use by neighborhood children. Tot lots will be located at all but the two junior high school sites.

Other improvements now planned include volleyball courts at the Tarkington and Sandburg sites, basketball equipment at Walt Whitman School, and park walks at Nathaniel Hawthorne School. Volleyball and basketball equipment are

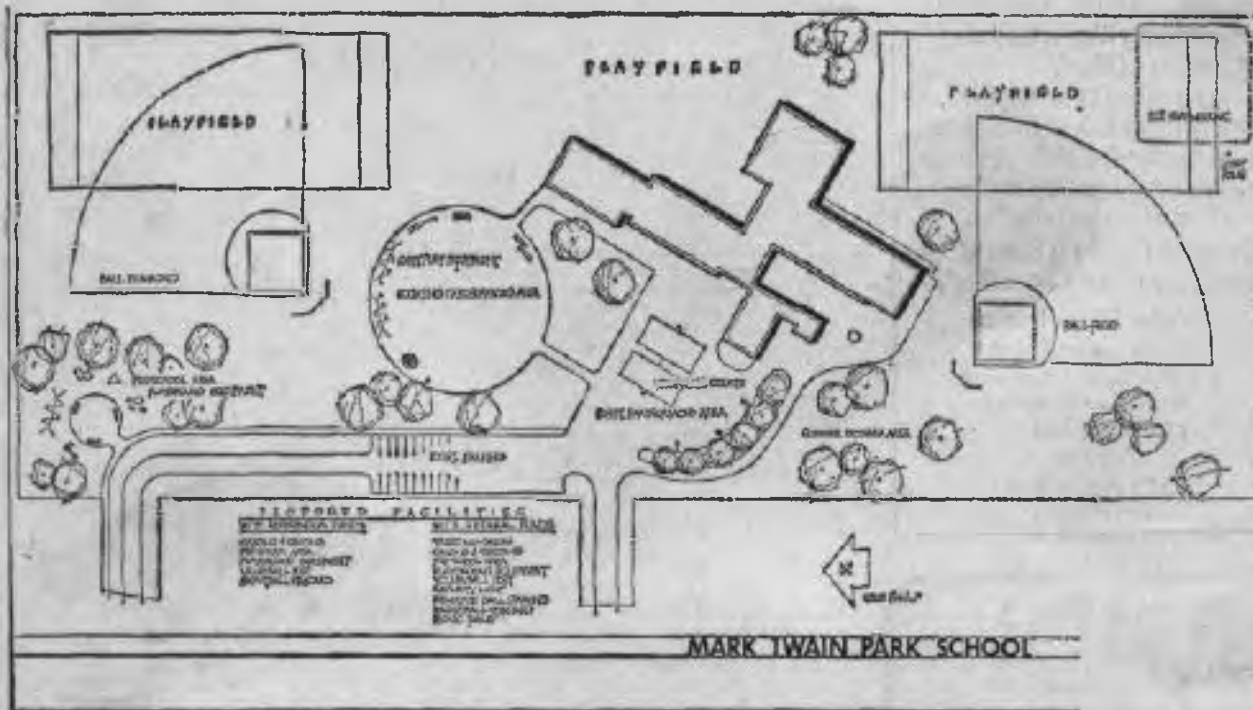

planned for the Twain site.

If matching federal funds are available, they will add \$107,940 to the park improvements program. These additional funds would be used mainly for more grading, seeding and landscaping, but would also provide for picnic tables at four sites and security lighting at several sites.

FEDERAL FUNDS would also mean improvements at the Jack London site, including a basketball court, grass track and landscaping. Local funds were not allocated for this site because of the extensive work done there previously.

The school-park sites are considered an invaluable asset to the local park system, as they add 76 acres of usable play space to the park district's 46.5 acres. In at least one neighborhood, the school sites provide the only open space in the area.

Phillips said all of the planned improvements for the school-park sites have been worked out in conjunction with Dist. 21 officials. He added that with the cooperation of the school district, the park district has been able to offer residents maximum use of the open land remaining in the village.

Park District Schedules Coffees

The Wheeling Park District has scheduled a series of coffees and presentations to acquaint village residents with the proposals of the \$700,000 park improvements referendum that will be Dec. 16.

Park district representatives will explain the proposed improvements at meetings of civic organizations and coffees held by village residents. All interested persons have been invited to attend any of the presentations.

The schedule for the presentations is:

Dec. 6 — 8 p.m., Wheeling Wheelmen Bicycle Club, Chamber of Commerce Park Community building.

Dec. 10 — 2 to 6 p.m., Open House, Heritage Park community building.

Dec. 11 — 8 p.m., Nathaniel Hawthorne PTA.

— 9 p.m., Walt Whitman PTA.

Dec. 12 — 10:30 p.m. Mrs. James Duke, 872 Sussex Ct., Buffalo Grove.

— 7:30 p.m., Mallard Lake Apartments.

— 8:30 p.m., Mark Twain PTA.

Dec. 13 — 8 p.m., Mrs. Bob Ross, 312 S. Wheeling Rd.

Dec. 14 — 7:30 p.m., Senior Citizens Club, Chamber of Commerce Park community building.

— 8:30 p.m., Jaycees and Jaycee Jills.

Dec. 15 — 8 p.m., Omni-House Board, Omni House.

SCHOOL PARK SITES

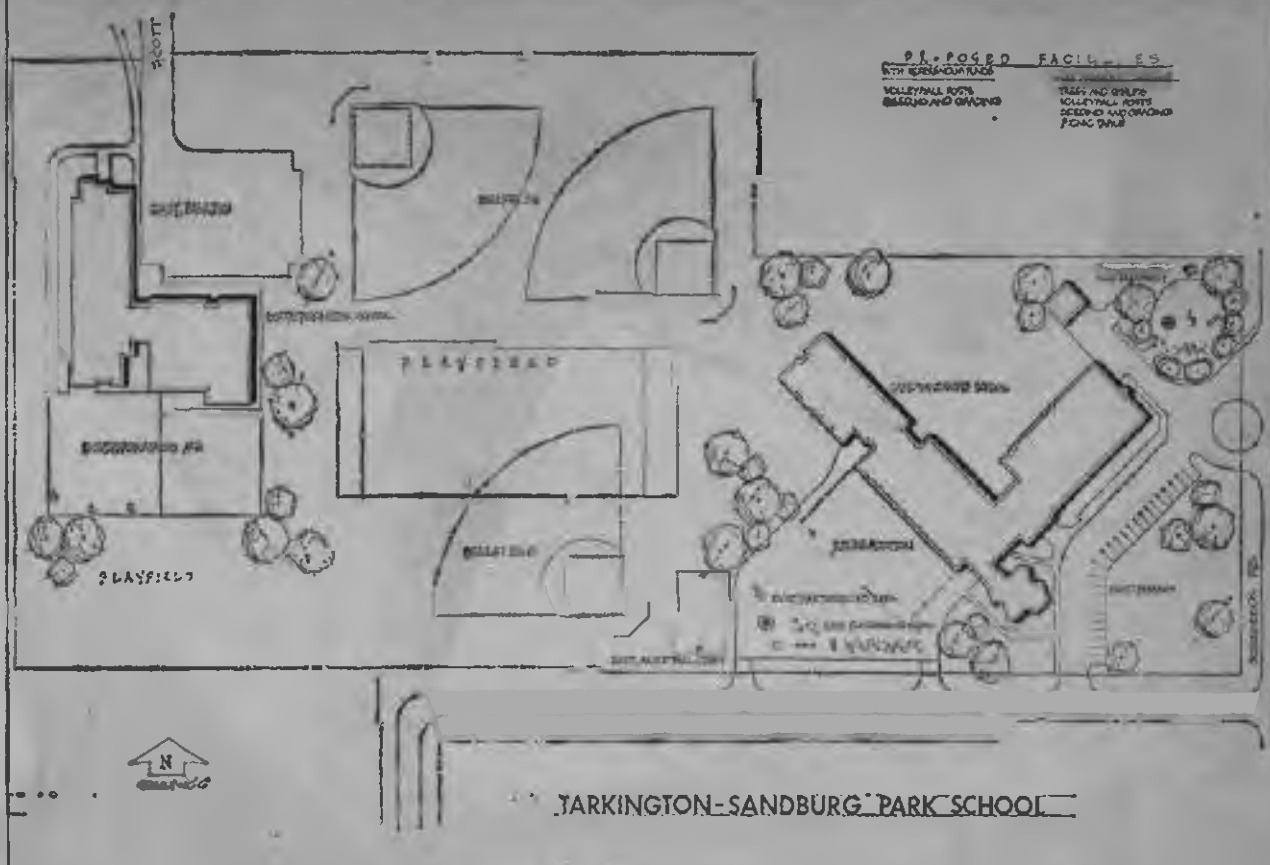

BASIC IMPROVEMENTS proposed by the Wheeling Park District for these school sites include extensive grading and seeding and the installation of field tiles to alleviate the present drainage problem. The proposed

improvements will be financed by a \$700,000 referendum, which will be Dec. 16. Matching federal funds will provide additional landscaping, volleyball courts and picnic tables.

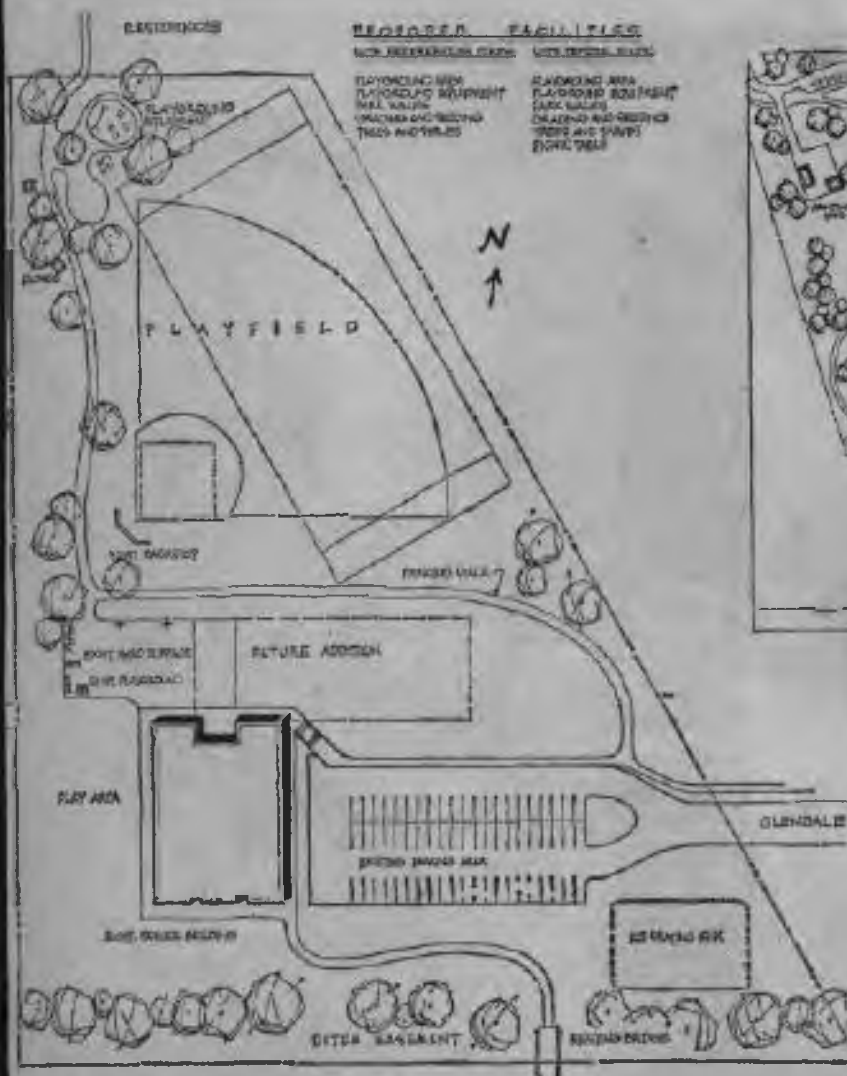

HAWTHORN-NORTHSIDE PARK SCHOOL

PROPOSED REFERENDUM improvements for this school-park site include a tot lot, park walks, grading, seeding and landscaping. Approximately \$13,750 of the \$700,000 in Wheeling park improvements is ear-

marked for this site. Matching federal funds would provide an additional \$5,350 for improvements at this park. The referendum will go to the public Dec. 16.

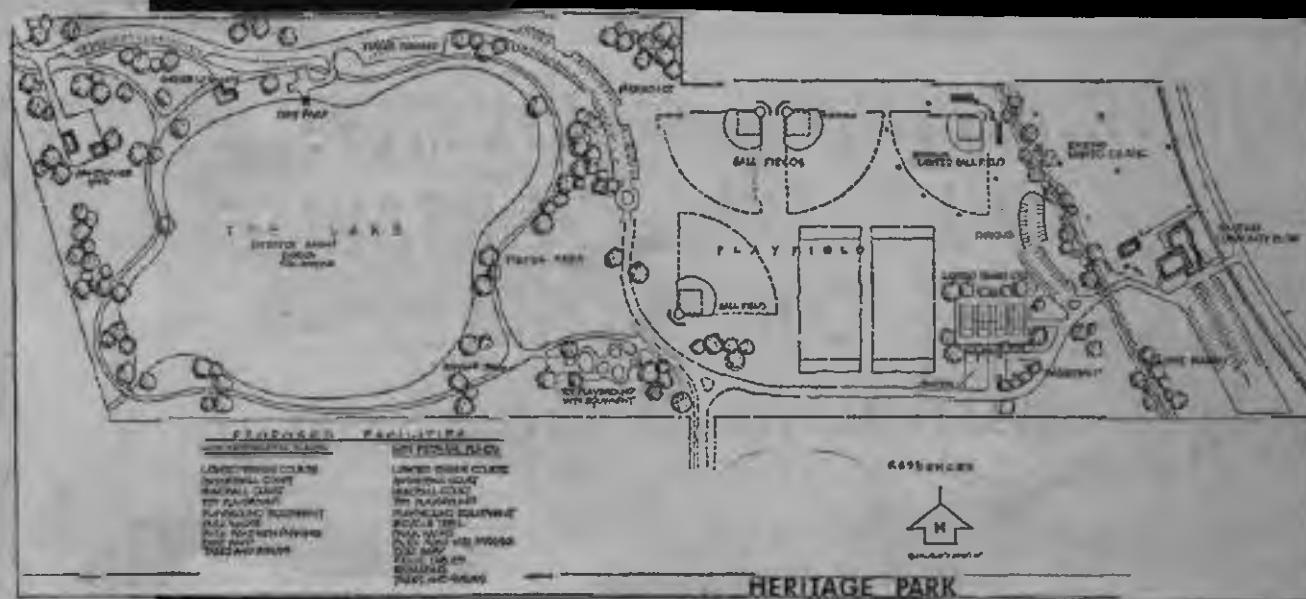



Heritage Park will offer Wheeling residents a variety of recreational activities when improvements are complete.

'Wonderland Basin' Plans Revived

Editor's note: This is the fourth in a series examining the condition of the parks in the Wheeling Park District, and the improvements planned in a \$700,000 referendum Dec. 16.

by LYNN ASINOF

Picture a spacious lake with sailboats lazily gliding across the surface. Fishermen line the shore casting for trout,

bass and perch. Not far from the lake, people are playing tennis, handball, basketball and baseball. It's Sunday afternoon in Heritage Park.

This scene once was the dream of the Wheeling Park District when the present 25-acre retention basin was first proposed. The dream, however, went sour when the basin turned out to be unusable for recreation purposes. Now it sits in the middle of Heritage Park, a gaping hole in the park district's dreams.

These dreams recently were revived when the park district began planning its \$700,000 park improvements referendum. As site plans for the park developed, a plan to improve the retention basin became the pet project of several park and village officials.

THE PLAN now under consideration would raise several hundred thousand dollars from outside sources for improvements on the Heritage Park retention basin. Park Supt. Dave Phillips said negotiations to raise this money from the Metropolitan Sanitary District (MSD), the village, private industry and the federal government have been progressing favorably.

Phillips said that if the money is raised it will be used to excavate the basin, landscape the area, provide boating ramps and stock the lake with fish.

He explained that the improvements to the retention basin will significantly affect the final development of Heritage Park. He said the park often is flooded after heavy rains, making it unusable for

recreation.

Phillips estimated that the park district lost use of the land for approximately two weeks this past summer. "We had ball diamonds under six inches of water this summer," he said.

Improvements to the basin are expected to alleviate the flooding problem. This will enhance the proposed plans for increasing the recreation facilities at Heritage Park.

WITH MONEY raised by the referendum, the park district is planning to install lighted tennis courts, a handball court, basketball courts, a tot lot, bicycle paths, park walks and landscaping.

Phillips explained that the tennis courts and handball court were first proposed in the 1964 park referendum. They were not installed however, because extensive grading and seeding at Jack London High School cost more than anticipated.

As a result, both projects head the list of priority items to be constructed.

OTHER proposed improvements to be financed with referendum funds would improve the services and the facilities of the park district. Plans now call for the construction of a new maintenance garage on the west side of the retention basin. Phillips explained that the two-car garage attached to the park's community building is too small.

Once the new garage is built, the park district plans to convert the old garage into a meeting room and use the old meeting room for additional office space

and storage. The district also plans to install a locker and shower room at the Heritage Park community building.

A new parking area will provide better access to the park facilities, and a limited use road will make maintenance of the 66-acre park easier.

Phillips estimated that Heritage Park presently is 30 to 40 per cent developed. If plans for the park improvements prove a reality, Phillips said the park site would be developed to its full potential.

1977 REFERENDUM

TO: POSTAL CUSTOMER
WHEELING PARK DISTRICT
WHEELING, ILLINOIS 60090

BULK RATE
U. S. POSTAGE
PAID
PERMIT NO. 51
WHEELING, ILL.

*Serving Your Community
the*

WHEELING PARK DISTRICT

FUNDS DONATED BY
"FRIENDS OF THE PARK"
CHAIRMAN CATHERINE RICHTER

URGES YOU TO

VOTE!

yes for



Will Rogers once said, "The Good Lord is makin' more people, but He ain't makin' more land."

The Acquisition of
Chevy Chase Golf
Course and
Acquisition/Development
of *Childerley Retreat*.
MARCH 26th

HOW MUCH WILL THIS COST?

The Park District is seeking authorization to issue 3.7 million dollars in bonds for the acquisition of the 128 acre Chevy Chase Golf Club and Club House, and for the acquisition and development of the Childerley Retreat site. The Park District received a matching acquisition grant for Childerley (\$117,250). No matching funds are available for the acquisition of Chevy Chase.

"HOW WILL THIS REFERENDUM AFFECT REAL ESTATE TAXES ON YOUR PROPERTY?"

The following examples may be used to determine an individual's cost for this referendum. The increase would not be effective until September of 1978.

If your equalized assessed value is:	The average annual tax increase will be:
\$ 6,000.00	\$10.80
\$ 8,000.00	\$14.40
\$10,000.00	\$18.00

These examples are based on conservative figures presented in detailed form by the firm of Benjamin and Lang and will lower with either a higher Assessed Valuation or a lower Bond Interest rate.

The Average equalized assessed value of a home in Wheeling is Between \$7,000 and \$8,000

DEBT LIMITATION – A SEPARATE QUESTION

The referendum will also include a question setting forth the issue of whether the Park District's debt limitation should be raised from 2½% of the equalized Assessed Valuation to 5%. Illinois Status prohibit a Park District from issuing bonds beyond 2½% of the Equalized Assessed Valuation without prior voter approval. This ballot must be supported by the voters to successfully accomplish the acquisition and development proposed. The contemplated bond issue of 3.7 million, together with the Park District existing bonded debt of 1.9 million produces a total indebtedness of \$5.6 million or 4.3% of the Equalized Assessed Valuation.

WHERE IS YOUR TAX DOLLAR GOING?

Community Consolidated School District #21	36%
Township High School District #214	28%
Community College District #512	3%
County, Metro, Gov't	13%
Wheeling Township	3%
Village of Wheeling	9%
WHEELING PARK DISTRICT	5%
Indian Trails Public Library District	3%

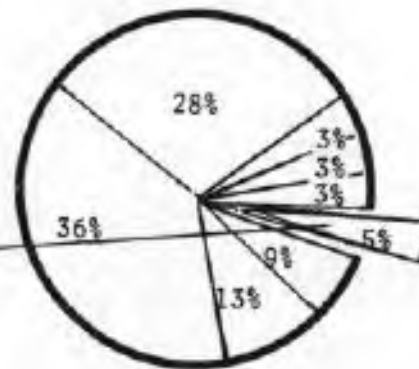

PUBLIC OPEN SPACE VS HIGH DENSITY DEVELOPMENT

The Park Board feels that the retention of open space for our children and our children's children, is of utmost importance for the continued balanced growth of our community. The Wheeling Park District now has the opportunity to retain 128 acres of valuable open space that next year could be lost from the regional open space inventory due to high density, multi-family development. We are confident that the residents of the Wheeling Park District will support this major open space referendum, and we feel this is an opportunity that must not be overlooked and should be presented to our residents for their ultimate decision.

WE HAVE THE PLAN & NEED THE LAND

WHEELING PARK DISTRICT
CHEVY CHASE GOLF COURSE & CLUB HOUSE ACQUISITION 128 ACRES
ELECTION DATE: MARCH 26, 1977

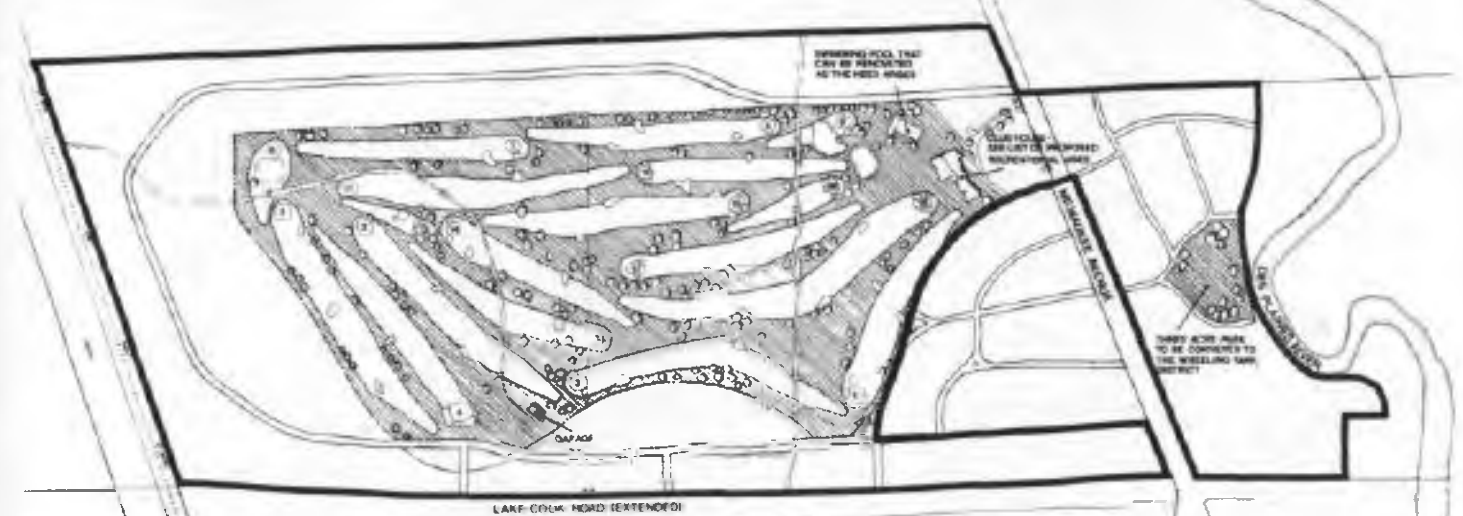

PROPOSED SEASONAL MULTI-PURPOSE RECREATIONAL USES FOR THE CHEVY CHASE PROPERTY

GOLF
JOGGING TRAIL
BICYCLE TRAIL
HORSESHOE PITS
SHUFFLE BOARD COURTS
CROSS COUNTRY SKIING
WINTER ARCHERY SHOOT
FISHING IN STOCK PONDS
ICE SKATING & WARMING HOUSE
OUTDOOR BASKETBALL COURTS

PROPOSED RECREATIONAL USES OF THE CHEVY CHASE CLUB HOUSE

RESTAURANT & BAR
BANQUETS
MEETINGS
ICE CREAM PARLOR
NURSERY
THEATER
PRO SHOP
PROGRAMS
DANCE
ARTS & CRAFTS
EXERCISE
SPECIAL EVENTS
GAME ROOM

PROPOSED AREA TO BE ANNEXED TO WHEELING PARK DISTRICT

WHEELING PARK DISTRICT
CHILDERLEY LAND ACQUISITION & PARK DEVELOPMENT
ELECTION: MARCH 26, 1977

**VOTE
YES
ON
MAR. 26**

A ONE TIME OPPORTUNITY
FOR OUR COMMUNITY!
LET'S MAKE THE BEST OF
IT!



- A VOTE FOR A BETTER COMMUNITY
- A VOTE FOR THE FUTURE

Park district pushed for Chevy Chase acquisition

By JOANNE KANTER
Correspondent

WHEELING—The park district move to acquire Chevy Chase Country club was made with the realization that if it didn't the property might go to Buffalo Grove and expansion of the Wheeling Park District would be cut off in the future, according to park district Supt. David Phillips.

Park district officials began to put out feelers to the Johnson family, owners of the property, in October 1976, and discovered the family would be interested in selling to the park district. The Wheeling Park District had been looking for a golf course to purchase for several years.

PHILLIPS SAID acquisition of Chevy Chase would round out the type of park district the people of Wheeling would have in the next 15 or 20 years. By the purchase of Chevy Chase, the park district will not be shut aside from potential open space.

Village officials are now in the process of talks with the Johnson family about annexing the property to the village. However, whether or not the plans proceed depends upon the availability of water and sewer lines and flexibility in zoning for the property, according to William Johnson.

The area being discussed for possible annexation to the village consists of 335 acres in Lake County and 109 acres in Cook County. The property south of Lake-Cook road already lies in Wheeling Park District territory.

THE AREA BEING considered for annexation to the village is generally bounded on the east by Wolf road, Milwaukee avenue and the Des Plaines river; on the west by the Soo Line Railroad tracks and the village of Buffalo Grove; on the north by a line approximately 300 feet south of and approximately parallel to Inverrary lane; and on the south by the corporate limits of the village of Wheeling.

According to Village Manager Terry Zerkle, a key factor in annexation of the property to the village is the acquisition of the 128-acre golf course by the Wheeling Park District. The park district proposes to retain the golf course for public use as well as use it for other activities.

LAND USE FOR THE property, if annexed to the

village, is consistent with the comprehensive plan, Zerkle said. Such uses tentatively be residential on the periphery of the golf course, commercial along a portion of Lake-Cook road in the vicinity of the intersection with Milwaukee avenue; and light industrial west and possibly immediately east of Soo Line track north of Lake-Cook road and south of Lake-Cook road.

Zerkle said recently, "One of the silent salient features about an annexation of this size is that it enables some flexibility to be exercised in determining specific land uses. Rarely does a municipality have an opportunity to plan for and to have input into future land use decisions in such a large scale manner."

BENEFITS TO THE COMMUNITY which would be realized if the Johnson property is annexed to the village and to the park district, according to the village manager, would be:

- **Socio/economic**—through hearings before the plan commission and the village board and consideration of the park district referendum, the community will have a say on how the land is utilized and developed. Annexation to the village and acquisition by the park district will broaden both body's tax bases.

- **Recreational**—a valuable open space would be retained if the park district referendum passes. Many golf courses have been turned over to multiple-family housing and more economically rewarding ventures for the owner than retaining the land as a golf course. This depletes the amount of open space available in the local area as well as the entire region.

- **Environmental**—retention of open space would result in less land being covered by concrete which would protect the integrity of the flood plain and minimize any adverse impact on it.

WHILE THE VILLAGE continues talks regarding annexation, the park district is working hard to inform voters on the referendum to be held March 26.

Park district officials will be appearing at public forums, PTA meetings, organization meetings, etc. to answer questions by the voters.

The referendum will have two portions: one on the acquisition of the Chevy Chase property and resultant maintenance costs in the amount of \$3.5 million and the acquisition of the Childerly property on Route 83 to be used for historical purposes and as an outdoor recreation/education and environmental awareness area in the amount of \$142,750. The remainder of the \$260,000 purchase price for Childerly will come from government grants already awarded.

Groups endorse golf course purchase

The Wheeling Park District's efforts to purchase the Chevy Chase Golf Course and develop the Childerly Retreat site have been endorsed by 12 community groups — including two political parties and two independent candidates in the village election.

Supporters of the March 26 bond referendum include the Wheeling Jaycees, the Wheeling Chamber of Commerce, the Wheeling Rotary Club board of directors, the Wheeling Women's Club, the Wheeling Historical Society, the Wheeling Village Board, the Better Environment, Service and Trust Party, the Wheeling Citizen's Party, the Tahoe Village

Condominiums Assn. executive committee, the Chelsea Cove Condominiums executive committee, Edward Fox, independent candidate, president, and Patrick Trunda, independent candidate for village clerk.

THE PARK BOARD is asking residents to vote on a \$3.7 million bond referendum to purchase the 128-acre golf course at 1003 N. Milwaukee Ave., Vernon Township. The course will be used for golfing, jogging, winter archery, cross-country skiing, bike trails, fishing, horseshoes, shuffle board and outdoor basketball.

The park district also plans to use

the 48-year-old Tudor-style clubhouse for dancing, exercise classes, yoga, theater and arts and crafts.

The 9.5-acre Childerly site, 506 Old McHenry Rd., will be developed as an outdoor education and recreation site. The park district also will work with the Wheeling Historical Society to restore historical buildings on the property.

If the referendum is approved, park officials estimate the average Wheeling park district resident with a home assessed at \$7,000 will pay a maximum of \$12.60 more a year in park taxes.



CHILDERLY - THE FIRST LITTLE HOUSE

March 26 referendum passes

\$1 a month cost for links: parks

(Continued from Page 1)

Village backs golf links purchase

A resolution supporting the Wheeling Park District's efforts to purchase the Chevy Chase Golf Course and to purchase and develop the Childerly Retreat site has been approved by the Wheeling Village Board.

The board resolution passed Monday states that trustees "consider suitable open space, park facilities and recreational programs a necessary part of the Wheeling community." It notes that Chevy Chase is "in imminent danger of being sold for high density multi-family residential development."

The board said acquisition of the

golf course and the Childerly site is "in the best interests of the citizens of the community. We join in with the citizens in support of the referendum."

The 128-acre golf course is at 1003 N. Milwaukee Ave., Vernon Township. The Childerly property is 9.5 acres at 506 Old McHenry Rd., Wheeling.

David Phillips, Wheeling Park District superintendent, said park officials have received similar resolutions of support from Edward Fox, independent candidate for village president, and Patrick Trunda, independent candidate for village clerk.

gether with the district's existing bonded debt of \$1.9 million produces a total indebtedness of \$5.6 million or 4.3 per cent of our equalized assessed valuation," he said.

The park board last month announced plans to purchase the 128-acre golf course if the referendum passes. The bond issue also will include \$20,000 for the purchase of the 9.5-acre Childerly Retreat Home, another proposed park site.

The park board has agreed to pay \$25,000 an acre or \$3.2 million for the land. The purchase price also will include \$200,000 for all buildings and equipment on the property. Park officials estimate the total cost will be

\$3.5 million, including allotments for golf course maintenance, operating equipment and building remodeling.

Plans for development of the golf course include a jogging trail, winter archery, cross-country skiing, bike trails, fishing, horseshoe pits, shuffle board courts and outdoor basketball courts.

The park district also plans to use the 48-year-old Tudor-style clubhouse for dancing, exercise classes, yoga, theater and arts and crafts.

The Childerly site will be developed as an outdoor education and recreation site. The park district also will work with the Wheeling Historical Society to restore historical buildings on the site.

\$1 a
cost
links:

by LINDA PUNCH

A dollar a month.

That's what the purchase of the Chevy Chase Golf Course will cost the average Wheeling Park District homeowner if a referendum on the issue is approved March 26.

That also is the message park officials are bringing to community organizations and others requesting in-

Golf course
future

Wheeling residents go to a free bond issue Saturday to approve or reject the park district proposal to purchase the Chevy Chase Golf Course and the Childerly Retreat site.

Passage of the \$3.7 million bond issue will increase the real estate tax by approximately 18 cents per \$100 assessed valuation.

The ballot will have two questions for voters to consider. First, they will be asked to vote "yes" or "no" on the issuance of the general obligation bonds.

The other question concerns whether the park district's debt limitation should be raised from 2½ per cent of the equalized assessed valuation to five per cent. Illinois statutes prohibit a park district from issuing bonds beyond 2½ per cent of the assessed valuation without prior voter approval.

The second question on the ballot must be supported by the voters to enable the

Childerly
hands

use the bonds for purchase of the property

The \$3.7 million bond issue, together with the park district's existing bonded debt of \$1.9 million, produces a total debt of \$5.6 million, which amounts to 4.3 per cent of the equalized assessed valuation.

Parks Supt. David Phillips stressed that both questions must have voter approval for the proposed purchase.

Polling stations will be open from 6 a.m. until 6 p.m. Voters in Precinct 1 (east of the Soo Line Railroad) will receive their ballots at Heritage Park. Precinct 2, for voters who live west of the Soo Line in Wheeling, will be voting at Jack London Junior High School.

Wheeling Park District residents who live in the Cambridge Subdivision of Buffalo Grove will vote at a private residence, 904 Sussex Court in Buffalo Grove.

Golf links, Childerly meeting topics

The 48-year-old Tudor-style clubhouse would be used for dance, exercise classes, yoga, theater and arts and crafts. Park officials said the golf course could open by June 1 if the referendum is approved.

The Childerly property, 506 McHenry Rd., would be developed as an outdoor recreation and education site and a historical area. The park district and Wheeling Historical Society plan to restore several buildings on the site, including a chapel built in 1825.

Park officials said district residents can expect their tax rates to increase an average of 18 cents per \$100 assessed valuation if the bond issue is approved. The average park district resident whose home is assessed at \$7,000 would see his tax bill increase by about \$12.60.

day: Lakeside Villa Clubhouse, Hintz Road and Lakeside Drive, 9 p.m. Tuesday; Walt Whitman School, 133 S. Wille St., 1:30 p.m. March 11; Carl Sandburg School, 3316 N. Schoenbeck Rd., 7:30 p.m. March 14; and Heritage Park, 222 S. Wolf Rd., 7:30 p.m. March 15.

Park officials said if the referendum passes Chevy Chase will be maintained as a golf course with the addition of a jogging trail, winter archery, cross-country skiing, bike trails, fishing, horseshoe pits, shuffle board courts and outdoor basketball courts. The golf course is located at 1000 N. Milwaukee Ave., Vernon Township.

Wheeling Park District officials today will meet with residents to review plans for a \$3.7 million referendum to purchase the Chevy Chase Golf Course and to purchase and develop the Childerly Retreat Home site.

Park officials will answer questions about the March 26 referendum at 9:30 a.m. at Mark Twain School, 515 Merle Lane, and at 9:30 p.m. at Chelsea Cove Clubhouse, 300 N. Denoyer Tr.

The meetings are two in a series of discussions scheduled by the park district. Others include: Oliver Wendell Holmes Jr. High, 221 S. Wolf Rd., 8 p.m. Monday; Eugene Field School, 51 St. Armand Ln., 7:30 p.m. Tues-



Few open space areas like this are left. We should keep it!

Editorials

Say yes to Chevy Chase

ON MARCH 26, Wheeling voters will have a chance to decide whether they want their park district to purchase almost 138 acres of land for open space and recreation.

If they decide yes, then they will have a golf course, a jogging trail, a winter archery shoot, cross-country skiing, bicycle trails and fishing ponds.

Part of the purchase would include the 128-acre Chevy Chase Golf course, which the park district has negotiated to purchase. Also included would be the 9.5 acre Childerly property.

WE THINK THE park district should be commended in its efforts to purchase Chevy Chase. The board tried to get outside funding but none is available, and thus they have turned to voters for their approval.

The golf course includes a clubhouse, which park officials say may be used for indoor recreation such as dance classes. And a swimming pool on the property can be renovated in the future when the need arises and the population increases. That pool will cost Wheeling taxpayers much less than construction of a new pool.

We think the proposal is a good idea, and one which Wheeling residents should support.

The cost of the package is \$3.7 million, which includes the Chevy Chase purchase price, funds for some renovation of the property and approximately \$200,000 for the purchase and renovation of the Childerly property on north McHenry road into a recreation and outdoor education area. The park district will receive \$117,250 in federal money which, when added to the \$200,000 in the referendum, will allow enough money for the \$260,000 Childerly purchase and about \$50,000 for restoration and development on of this site.

COST TO THE average homeowner will be \$12 per year, when averaged over the life of the bonds to be sold. This seems like a small amount to pay to maintain this much land for open space.

The area is so desirable that Buffalo Grove village officials and the Buffalo Grove Park District have been trying to annex it for their community. It is indeed a coup for the Wheeling Park District to have been given this purchase opportunity first.

We urge voters in the Wheeling Park District to vote "yes" on Saturday, March 26. With open space at a premium, residents are seldom given an opportunity of this magnitude to change the face of a community.

The way we see it

Golf purchase deserves OK

Voters in the Wheeling Park District Saturday have the opportunity to preserve two valuable community assets.

The Wheeling Park District is asking voters to approve a referendum authorizing \$3.7 million in bonds to purchase the 128-acre Chevy Chase Golf Course and the 9.5 acre site of the Childerly Retreat House.

The proposal is one of the most exciting referendums placed before voters in a Northwest suburban community in many years; its approval could spark a wide-ranging improvement not only in recreational facilities but in community life styles and esteem.

If the referendum succeeds, the park district will operate the golf course and will use the large Tudor-style clubhouse to house other park programs. The retreat house will be renovated by the Wheeling Historical Society and that site preserved as an historical park.

Cost of the purchase will be \$12.60 a year to the average homeowner in increased park

district taxes for the 20 year life of the bonds.

The cost of the purchase may seem high, but will, park officials note, amount to \$1 a month, a price that is reasonable for the benefits the community stands to gain.

Failing now to buy and preserve Chevy Chase will open the way for the course's purchase by a developer. Once the land is developed either for housing or business, it will be lost forever as open space. The same fate could befall the retreat house.

By buying the two properties now, the park district will preserve the land for future use. In addition to benefiting golfers, the golf course purchase will benefit joggers, bike riders and everyone else who appreciates having green open space rather than paved parking lots in their vicinity.

To assure these benefits, voters Saturday should cast two "yes" votes. The first "yes" will approve the purchase of the properties. The second will increase the district's bonding limit to make the purchase possible.

Chevy Chase future in voters' hands

Tee time by June if bonds OK'd: park board

By JEAN PERKINS

Wheeling residents could be playing golf in the park district's Chevy Chase golf course by June if the \$3.7 million bond referendum passes March 26.

If the issue passes, the park board plans to take possession as soon as possible and begin operation by June 1. David Phillips, Wheeling park superintendent said the board would open the course as soon as all paperwork could be completed.

"Little major renovation will be required," Phillips said. "Some changes would be made to be sure that all codes and standards are met, but we do not anticipate any major work. The building and the golf course are well-suited for the activities of the park district."

Phillips also said that the park district would be obligated to honor existing agreements for the operation of the golf course and building through the summer at least.

Of the \$3.7 million, \$3.2 million is for the purchase of the land at \$25,000 an acre. An additional \$200,000 will purchase all buildings and equipment on the property, plus allotments for golf course maintenance, operating equipment and some building remodeling.

If the referendum does not pass, Phillips said the owners of the golf course, the Johnson family, plan to continue operating it through the summer of 1977. Afterward it will be subdivided for high density multifamily housing development.

Wheeling Village Manager Terry Zerkle said the village has been involved for some time in discussions about the possible annexation of the Johnson property. The parcel includes 297 acres in Lake County and 109 acres south of Lake-Cook Road in Cook County. The golf course covers 128 acres, all in Lake County.

Plans for property other than the golf course include residential, commercial and light industrial development.

Zerkle said no commitments have been made relative to annexation by either the Johnson family or the Village of Wheeling.

Park Board Commissioner Robert Ross said the property will be used for a variety



Wheeling citizens will vote on purchase of Chevy Chase golf course and club facilities in \$3.7 million bond issue referendum March 26. (Staff photo)

of recreation activities, including bicycling, fishing, cross-country skiing, archery and jogging. An outdoor Olympic-sized swimming pool is part of the property, but considerable renovation would be required for its use.

"Estimates for renovation are about \$100,000," Phillips said. "After the surrounding residential area develops, we may find that such an expenditure would be desirable. We are also going to explore

the possibility of operating the existing restaurant and bar; it all depends on the revenue and return involved."

He said the Tudor-style clubhouse will be used for various classes and park activities. A portion of the clubhouse which burned last summer will not be rebuilt.

There are currently no federal funding programs to assist the park district in this kind of purchase, but the Johnson family

has agreed to installment payments for a minimum of three years if the referendum is passed. This method of payment will allow the park district to stagger the issuance of the general obligation bonds.

Village financial consultants are working on a detailed analysis of tax changes residents can expect if the issue is passed. The park board expects to hear their report at the March 3 board meeting.

Parks urge purchasing golf course

Wheeling Park officials Tuesday said they are convinced purchase of the Chevy Chase Golf Course is an economical way to preserve open space in the community.

Park officials met with about 25 residents at Heritage Park, 222 S. Wolf Rd., to review plans for the \$3.7 million referendum to purchase the golf course and to purchase and renovate the Childerly Retreat Home site, 506 N. McHenry Rd.

The session was the final scheduled public hearing on the proposal. There

has been little opposition at the other hearings.

LORRAINE LARK, Wheeling Park board president, said district officials "had been very cautious" in preparing plans for the March 26 referendum to purchase the 128-acre golf course at 1003 N. Milwaukee Ave., Vernon Township.

"It's always been our policy as a board that we have to be convinced something is popular before we present it to the people. Purchase of the Chevy Chase Golf Course is something we thought would be best for you and your families," she said.

Park officials said the average park district resident whose home is assessed at about \$7,000 is expected to pay a maximum of \$12.60 more a year in park district taxes if the golf course is purchased.

Mrs. Lark said the park board hired Benjamin & Lang Associates of Chicago to ensure the referendum would be "economical for you as a taxpayer."

DAVID PHILLIPS, Wheeling park superintendent, said the purchase price of \$25,000 per acre "is equitable." He said market values for similar size golf courses, in Evanston, Skokie and Mount Prospect range from \$50,000 per acre to \$175,000 per acre.

Phillips said the purchase price of the \$200,000 golf course clubhouse also is much lower than if the park district had to construct new buildings.

"It would cost at least 10 times as much to construct buildings with the same size and character," he said.

Plans for development of the golf

Vote set on Chevy Chase

By JOANNE KANTER
Correspondent

WHEELING—The Wheeling Park District will ask its residents to approve the purchase of the 128-acre Chevy Chase Golf Course in a referendum Saturday, March 26.

Purchase price of the acreage will be \$25,000 per acre or \$3.2 million. In addition, the park district will also purchase the buildings and equipment on the property for \$200,000. Park district officials say the purchase is contingent upon the ability of the park district to market general obligation bonds in the amount of the purchase price.

Prior to closing the sale, the Johnson family, owners of the property, will petition the park district to annex approximately 285 acres. (See map.)

OFFICIALS OF THE park district began negotiations with the Johnson family in mid-October. Officials of the village of Wheeling were also asked to participate in the talks in anticipation of possible annexation to the village of nearly 300 acres of land owned by the Johnsons.

The village of Buffalo Grove has been negotiating with the Johnsons also and according to park district Supt. David Phillips, "It was apparent...that the existing golf course, 128 acres of prime open space, was in imminent danger of being sold for high density multi-family development."

The total purchase price of the golf course, buildings and inventory with allotment for necessary new golf course maintenance and operating equipment and building remodeling is \$3.5 million. The park district has hired the firm of Benjamin & Lang as financial consultants to advise it in the purchase. Phillips said the financial consultants are working on the figures for cost to individual taxpayers.

PARK BOARD COMMISSIONER Robert Ross stressed that the park district expects to use the property for all types of recreation, not just as a golf course. He said other activities will include a jogging trail, winter archery shoot, cross-country skiing, bicycle trails and fishing in stocked ponds. In addition, the park district expects to operate the restaurant and bar presently on the property.

Phillips said the club house could be used in a variety of ways for community organization meetings and banquets and would be available for programming in the areas of dance, exercise classes, yoga, arts and crafts, etc. There is also an Olympic-sized swimming pool on the property which could be renovated for use when the population of the community needs it.

An installment method of purchase has been negotiated with the Johnson family to allow the park district to stagger the issuance of general obligation bonds which will result in a lower average tax rate for residents of the community, according to Phillips.

THE PARK BOARD has investigated possible sources of outside funding and has learned there are no monies currently available for this type of project.

A statement by the park board says, "The retention of open space for our children and our children's children is of utmost importance for the continued balanced growth of our community. The Wheeling Park District now has the opportunity to retain 128 acres of valuable open space that next year could be lost from the regional open space inventory due to high density, multi-family development. We are confident that the residents of the Wheeling Park District will support this major open space referendum."

Phillips said members of the park board will appear at meetings throughout the community during February and March to inform the community and to answer any questions which residents may have on the acquisition.

IN ADDITION TO THE CHEVY CHASE question, the park board will ask residents to approve funds for the purchase of the 9.5 acre Childerly site on Route 83. The park district will receive \$117,250 in federal monies and needs the remaining \$142,750 to make up the \$260,000 purchase price plus \$50,000 for restoration and development of the park as an outdoor recreation/education and environmental area.

Total cost of the referendum package will be \$3.7 million.

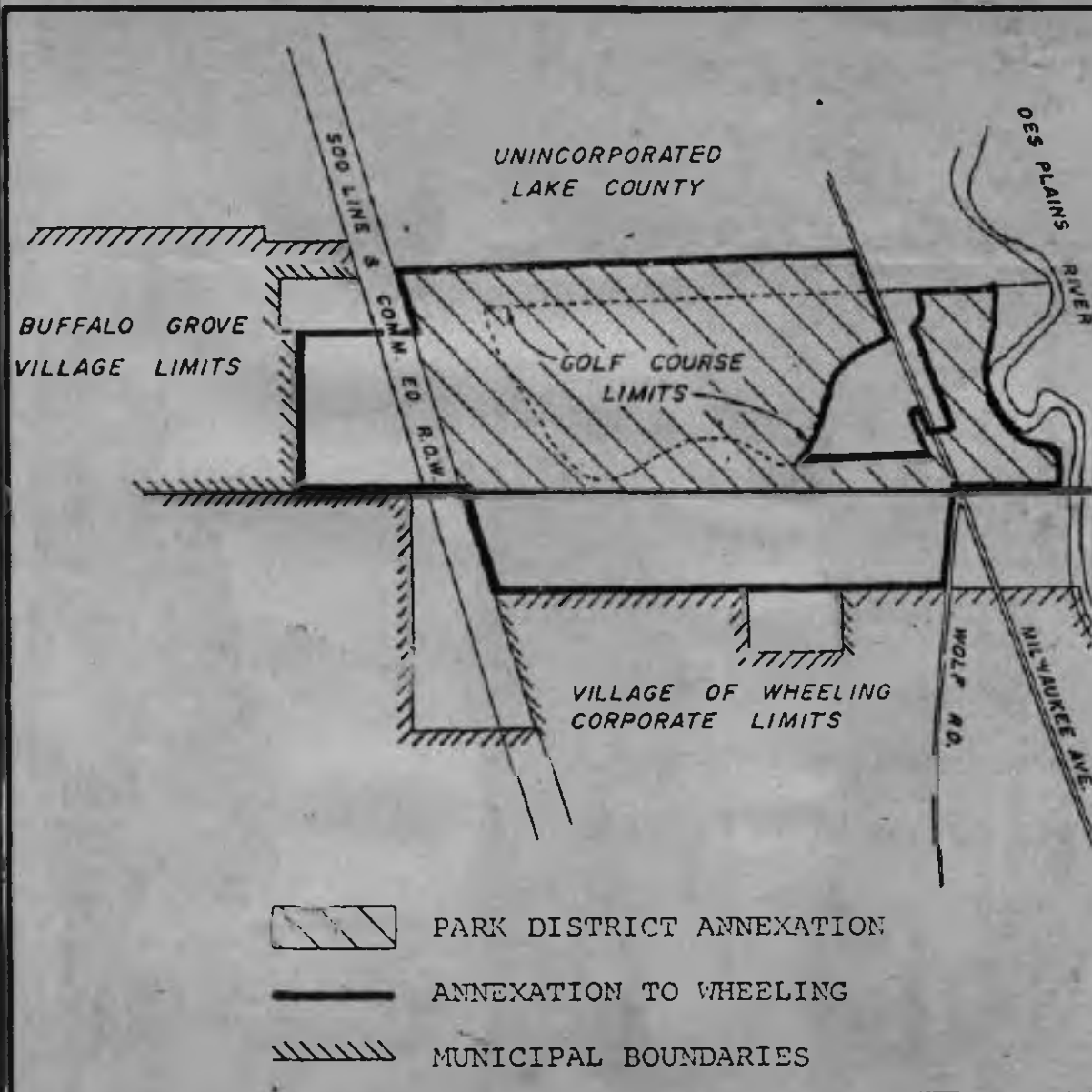

THE WHEELING PARK DISTRICT will hold a referendum to purchase the Chevy Chase Golf Course (large striped area) March 26. Other property bounded by the heavy black line also is being considered for annexation into the village of Wheeling.



Chevy Chase purchase

Park referendum wins

By JOANNE KANTER

Correspondent

WHEELING—Wheeling Park District residents approved the acquisition of Chevy Chase Country Club by a four-to-one margin in a referendum held Saturday, March 26.

According to park district Supt. David Phillips, 1,843 ballots were cast in the election. A total of 1,455 were in favor of the purchase of Chevy Chase, with 371 "no" votes recorded.

On the proposition to allow the park district to raise its bonded indebtedness to 5% of its assessed valuation, a proposition which had to pass if the purchase is to go through, 1,444 "yes" votes were cast, with 382 opposed.

PHILLIPS SAID the turnout was very heavy. "We had identified approximately 1,400 people who we felt were supporters. We were pleased to see the heavy turnout because it was a decision the community had to make and it was a decisive victory."

Lorraine Lark, president of the park district board of commissioners, said Monday, March 28, "I would like to express my appreciation to everyone for the cooperation evidenced by the participation in the

March 26 election. This has truly been a community-involved referendum." Lark noted that people called to offer assistance. "We didn't have to ask. The parks belong to the people. They have given us the ultimatum. We must carry it forward," added Lark.

Lark said she thanks the "no" voters as well as the "yes" voters because they exercised their right to vote and gave the commissioners their opinion.

The park district will sell the first group of bonds to make the Chevy Chase purchase in June. Subsequent bond issues will be sold in June, 1978 and June, 1979.

PASSAGE OF THE REFERENDUM also means the park district may proceed with the purchase of the Childerly property on north McHenry road. The park will be used for recreation and outdoor education. Some of the buildings on the site will be restored for use by the park district.

Wheeling Park District residents will be able to play golf on their own course this summer. The park district will use funds from the sale of bonds to renovate the course. In addition, park district officials have promised other forms of recreation such as bike trails, jogging trails and fishing in stocked ponds on the Chevy Chase property.

Voters OK golf course purchase

Wheeling Park District voters turned out in record numbers Saturday and approved purchase of the 128-acre Chevy Chase golf course.

Residents approved the \$3.7 million bond issue by a 4 to 1 margin, with 1,455 yes votes and 371 no votes. A second question asking authorization to increase the park district's bonding limit was approved 1,444 to 382.

"I always thought people in Wheeling were very apathetic in some respects," Park Board Pres. Lorraine Lark said Sunday. "After yesterday's

passage of the referendum on both counts, I feel apathy is now a word of the past.

PARKS SUPERINTENDENT David Phillips said the turnout "is twice as heavy as the highest vote total ever for any park district election.

Phillips said he did not expect the large voter turnout for the referendum, although park officials did foresee "about 1,400 people who were potential yes voters."

"I was hopeful but I didn't really expect this kind of a turnout. It comes

out pretty close to what we projected," he said.

Park officials will begin legal work and other preparation for issuing the bonds this week, Phillips said. He said the park district anticipates take-over of the golf course by June 1.

The park board last month announced plans to purchase the 128-acre golf course at 1003 N. Milwaukee Ave., Vernon Township, if the referendum passed. The bond issue also includes \$200,000 for the purchase of the 9.5-acre Childerly Retreat Home, 506 McHenry Rd., as a proposed park. No

date to take over the Childerly Retreat has been set.

THE PARK BOARD has agreed to pay \$25,000 an acre or \$3.2 million for the land. The purchase price also includes \$200,000 for all of the buildings and equipment on the property. Park officials estimate the total cost will be \$3.5 million, including allotments for golf course maintenance, operating equipment and building remodeling.

The average Wheeling Park District resident, whose home is assessed at \$7,000, is expected to pay a maximum of \$12.60 a year more in park district

taxes when the golf course is purchased.

Plans for development of the golf course include golf, a jogging trail, winter archery, cross-country skiing, bike trails, fishing, horseshoe pits, shuffle board court and outdoor basketball courts.

The park district also plans to use the 48-year-old Tudor-style clubhouse for dancing, exercise classes, yoga, theater and arts and crafts.

The Childerly site will be developed as an outdoor education and recreation site. The park district also will work with the Wheeling Historical

Society to restore historical buildings on the property.

Purchase of the golf course paves the way for village expansion into Lake County. Wheeling village officials are negotiating annexation of the golf course and adjoining land owned by the William Johnson family. The Johnson family is the current owner of Chevy Chase. The golf course is in Lake County.

Village Mgr. Terry L. Zerkle said the "key factor" in the annexation of the 406 acres is the purchase of the golf course by the park district.

PARKS



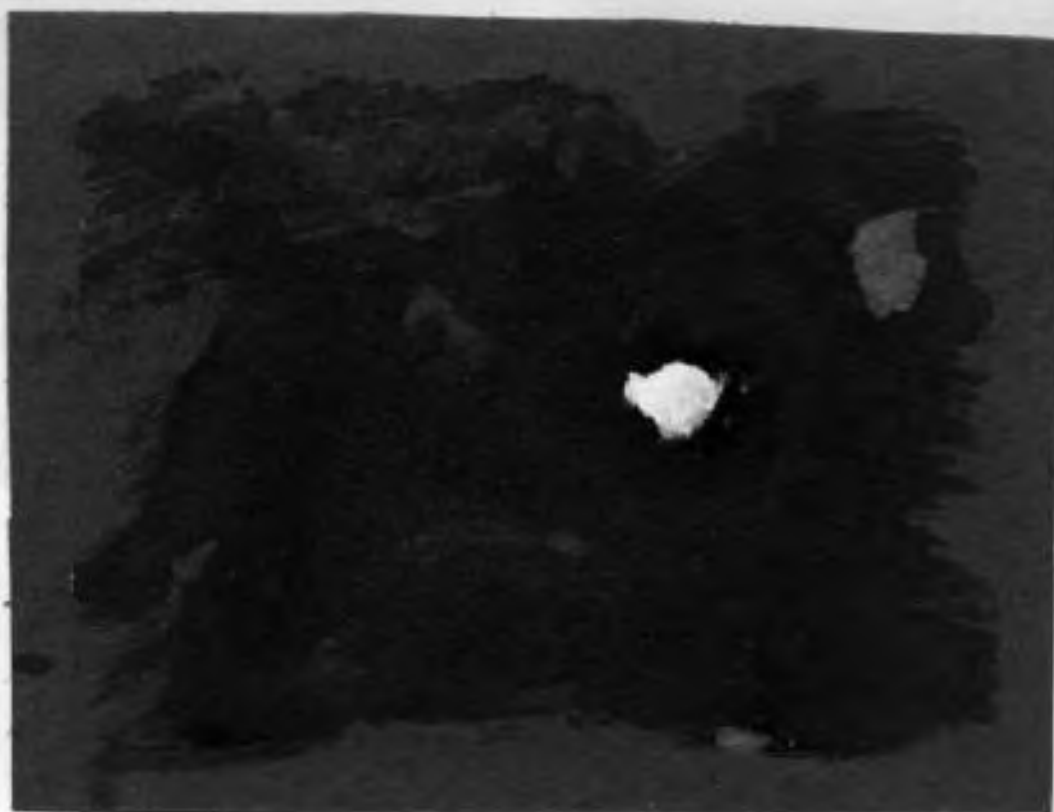

Bus tour to highlight parks

An afternoon bus tour of six Wheeling parks at 1:30 p.m. this Saturday is available on a first-come, first-serve basis for Wheeling residents.

The tour is the "Get to Know Your Parks" program, sponsored by the Wheeling Park District to promote community awareness of area parks. Although limited to 40 persons, the tour will be

repeated if demand warrants it.

Park District Supt. Dave Phillips will conduct the tour, which will highlight historical, current and possible future aspects of the local park system.

Free one-day passes for swim and sauna privileges will also be provided.

Interested persons may make reservations for the program by calling the park district at 537-2222.



Historical society move slated for mid August

The Wheeling Historical Society museum could be moved from 84 S. Milwaukee Ave. to Chamber of Commerce Park by mid-August, David Phillips, Wheeling park superintendent, said.

Phillips said the park district is awaiting final village board action on its request to move the museum but expects to have the building at its new site by the middle of August.

"The park board has approved an architect to finish plans for an addition and I've contacted the village attorney to make sure they are ready to turn over title to the building," Phillips said.

THE VILLAGE, which currently owns the museum, has agreed to sell the building to the park district for \$1. The historical society has leased the building for \$1 a year since 1966. The deed of the museum will be transferred when the museum is moved to the park site, 131 N. Wolf Rd.

Phillips said the park district is waiting for the final village board action on the district's zoning requests that will allow the building to be

moved to the park site. The village zoning board of appeals and plan commission already have approved the request and the village board has given preliminary approval. Final action is expected at Monday night's board meeting.

Phillips said he expects construction of an addition to the museum to begin within 30 to 60 days after the village board takes action. The addition will include a full basement for the museum and will provide more display and storage space for the historical society.

The museum building, erected in 1897, once served as Wheeling Village Hall. Historical society officials asked that the building be moved to the new site, saying they are concerned about the future of the structure because of plans to widen Milwaukee Avenue.

The village board in April agreed to spend \$3,500 in federal revenue sharing funds to move the historical society building to Chamber Park. The park also is the site of the 101-year-old Community Presbyterian Church.





Heritage Park okayed for HUD flood grant

By TINA LABELLARTE

The Wheeling Park District last week received official notification from Cook County that the Department of Housing and Urban Development has approved a \$100,000 grant for work on Heritage Park West.

The park district applied for the grant in February 1976, but receipt of the funds was delayed when the Cook County Legal Assistance Foundation questioned whether the facility would benefit low or moderate income families.

Having passed that hurdle, the park district is now undergoing an environmental assessment. After the assessment is finished, the district plans to hire a project engineer to develop specifications and proceed with bidding, awarding of bids and project implementation.

Implementation of the project would culminate nine years of park district effort to improve the basin constructed on park district property in 1969 by the Village of Wheeling and the Metropolitan Sanitary District.

The project involves three agencies and four phases:

— Phase I includes a low-flow bypass to route water into the Wheeling drainage ditch and Des Plaines River during non-flood conditions. This would save the storm water storage capacity of the basin for those times it is necessary.

— Phase II consists of a siltation pond. Silt in any body of water may create problems and in time make it necessary to dredge the basin to re-establish the lost storm water storage, boating or fishing area.

— Phase III includes the construction of a pumping station to stabilize the water level in the basin. A stable level increases storm water storage capacity, allows recreational use of the basin for boating and fishing, and eliminates bank erosion.

— Phase IV consists of basin improvements. This includes dredging and excavating the basin into a permanent water pond by removing the "flats."

The financial commitment of the Village of Wheeling is \$145,000 to be used for the low-flow bypass and siltation pond. The MSD is expected to provide \$45,000 for building the pumping station and the Wheeling Park District will use its \$100,000 grant for basin improvements.

The village, park district and MSD officials are meeting today to discuss responsibilities of each group. The village and park district last month rejected a MSD-proposed agreement and developed an alternate plan.

Park district and village officials had been critical of MSD's lack of cooperation on efforts to begin improvements. Park district attorney Roger Bjorvik opposed the MSD proposal because it called for the village and park district to be responsible for all basin site maintenance. The agreement would also give the sanitary district access to the basin area at any time.

The basin site is located south of the park district administration building, 222 S. Wolf Rd.



Park district leaps last grant obstacle

WHEELING—The Wheeling Park District has hurdled the last obstacle in obtaining a \$100,000 community development grant from the Department of Urban Development (HUD).

Funding was approved for recreational improvements for Heritage Park West and for revitalization of Milwaukee Avenue. However, the grant for Heritage Park West was challenged by the Cook County Legal Assistance Foundation, Inc., which questioned local compliance with the section of the Community Development Act that states funding is available for "flood drainage facilities in cases where assistance for such facilities has been determined to be unavailable under other federal laws or programs."

Questions also arose on whether the project was in compliance with HUD's Assurance number six which says, "The Community Development Program has been developed so as to give maximum feasible priority to activities which will benefit low- or moderate-income families or aid in the prevention or elimination of slums or blight."

THE WHEELING PARK DISTRICT was able to satisfy these questions and received official notification from Cook County that HUD had given final authorization for the funding on March 6.

The park district must now proceed with the required environmental assessment and upon its acceptance, will be authorized to enter into a binding agreement with a project engineer to develop specifications and proceed with bidding, award of bids and project implementation.

Implementation of this project will

culminate nine years of effort by the Wheeling Park District to improve the basin constructed in 1969 by the village of Wheeling and the Metropolitan Sanitary District (MSD) on park district property.

The total project involves three agencies — the village of Wheeling, MSD and the park district — and four phases of improvements.

• Low-flow bypass — To route water not needed to be stored in the basin directly into the Wheeling Drainage Ditch and the Des Plaines River during non-flood conditions. The purpose of the bypass is to save storm water storage capacity of the basin for those times when it is necessary to discharge non-flood waters into normal flows of the Wheeling Drainage Ditch and the Des Plaines River.

• Siltation Pond — Silt in any body of water creates problems and after a period of time, it is required that the basin be dredged to re-establish the lost storm water storage area, or boating and fishing area. The purpose of this project is to create a ponding area for incoming water so that the heavier particles filter out. This small pond or channel can then be economically cleaned out with a back hoe on an as-needed basis at a much lower cost, according to David Phillips, park district director.

• Pumping station—stabilization of a water level in the basin is extremely important said Phillips, in order to increase storm water storage capacity by maintaining the normal water surface of the pond at a lower elevation than is now possible; to maintain an adequate water accessibility and stable

water level for boating and fishing and to eliminate bank erosion. The pumping station will be designed to maintain the water level of the Heritage Park West basin at a given elevation to insure efficient multi-purpose usability.

• Basin improvements — The basin is to be dredged and/or excavated into a permanent water pond, with the "flats" being removed. (Park district officials presently refer to the basin as "Yucca Flats"). The permanent water pond would enable recreational use of the existing 20-acre site for the first time since construction began in 1969, according to Phillips.

The purpose of the basin improvements are to increase the storm water storage capacity by approximately 30% by storing more storm water in the basin and to enable the park district to use the basin for recreational purposes.

THE MSD WILL pay \$45,000 for the pumping station, while the village of Wheeling will pay an estimated \$145,000 for the low-flow bypass and the siltation pond. The park district will pay \$100,000 (money from the community development grant) for the basin improvements.

Wheeling Park District Board President Lorraine Lark said, "The completion of the Heritage Park West project has been a top priority of the Wheeling Park District for nine years. While commitments for funding the project have been a long time in coming, the \$100,000 community development grant allocation is the final funding necessary for us to proceed."

AGREEMENT - HERITAGE PARK WEST

HERITAGE PARK EAST, NORTH BASIN

HERITAGE PARK WEST - MUNICIPAL COMPLEX
STORMWATER STORAGE

Whereas, the Village of Wheeling and the Wheeling Park District have evidenced the desire to enter into an agreement for the completion of the Heritage Park West, Heritage Park East - North Basin, and the Heritage Park West - Municipal Complex Stormwater Storage facility;

Now, therefore, in consideration of the following covenants being good and valuable consideration it is agreed as follows:

I. HERITAGE PARK WEST

a. The Village of Wheeling shall:

1. Construct and maintain an enclosed low-flow bypass.
2. Construct and maintain a siltation pond west of Sault St. Marie railroad.
3. Agree to enter into a Memorandum of Understanding drafted by the Metropolitan Sanitary District of Greater Chicago in regards to the diversionary channel and drainage district improvements that will allow the \$45,000.00 committed to the pumping station by the MSD to be released, the Memorandum of Understanding must be found agreeable to the Village of Wheeling.
4. Construct and maintain the pumping station built with Metropolitan

**ENVIRONMENTAL
ASSESSMENT
Heritage Park
Improvements**

Prepared for the
WHEELING PARK DISTRICT

Prepared by
Trkla, Pettigrew, Allen & Payne

Living Memorials

The Wheeling Park District Board of Commissioners has implemented a new program in regard to "Living Memorials". A person, family or friends wishing to contribute towards the purchase of a tree to be symbolically planted in memory of a loved one will have their contribution matched by the Wheeling Park District.

If you wish to have a "Living Memorial" planted in the memory of someone special in the parks of Wheeling, please call the Park District at 537-2222 at your convenience.



Plant tree to honor Gil Messa

WHEELING—The Wheeling Park District will plant a tree in memory of Gil Messa who died in November 1977. Messa worked as a volunteer for the Wheeling Park District for several years, helping establish programs such as coaches clinics and the pee wee youth sports program.

According to officials of the park district, Messa's only objective was to "help youth of all ages and backgrounds, spiritually, mentally and physically. He offered his help however he was able."

Messa was a professional in the Boys' Clubs of America program. He worked at Boys' Clubs in California for many years before accepting a position as field representative for the Midwest region. During his years in the Midwest regional office, Messa brought 21 new clubs into Boys' Clubs of America membership.

MESSA TOOK a leave of absence from his position while suffering from a heart problem. While on leave, he organized a Chicago Blackhawk celebrity roast that raised funds for a youth injured in a hockey accident. He also started a Peanuts Club at Mallard Lake Apartments.

The Messa family moved back to California, due to Gil's health, where he died.

"Gil has left his spirit wherever he has been. He

has touched the lives of many people in Wheeling. Gil's unselfish dedication to people will always be remembered," said Dave Phillips, park district superintendent.

A Gil Messa Memorial Fund has been established through the Chicago Boys' Club to help defray hospital costs for the family.

PLANT A "LIVING MEMORIAL" IN THE PARKS WITH THE WHEELING PARK DISTRICT

The Wheeling Park District, Board of Commissioners has implemented a new program in regard to "Living Memorials." A person, family or friends wishing to contribute towards the purchase of a tree to be symbolically planted in memory of a loved one, will have their contribution matched by the Wheeling Park District.

If you wish to have a "Living Memorial" planted in the memory of someone special in the Parks of Wheeling, please fill out this card and return it to the Wheeling Park District or call the Park District (537-2222) at your convenience.

I (we), _____, wish to donate _____ dollars, to be matched by the Wheeling Park District to plant a tree in the Parks of Wheeling in memory of _____

(Signed) _____

(Address) _____

(Phone #) _____

TO: Board of Trustees, Village of Wheeling
FROM: Board of Commissioners, Wheeling Park District
RE: Pending Wheeling Land Dedication Ordinance
DATE: June 1, 1978

GENERAL BACKGROUND

The Wheeling Park District initiated action in support of a Land Dedication Ordinance in 1972. In 1975 the first ordinance was drafted. There have been five (5) drafts including the last draft completed by Village Attorney Garfield dated March 22, 1978. There have also been four (4) drafts of the Agreement to be signed by the School District's, Park District and Village. Since August 11, 1977 numerous Plan Commission meetings have been held to review and revise the ordinance until all input was submitted.

The Ordinance now before you is a composite of a number various improvements on the original Naperville Ordinance.

LEGAL BACKGROUND

The challenge to the Naperville Ordinance was enacted through the O.L. Krughoff vs. City of Naperville case which was heard in the 18th Circuit Court of DuPage County. The Naperville Ordinance was upheld, and subsequently appealed to the State Supreme Court. The opinion of the State Supreme Court was brought down in a decision dated May, 1977, and again upheld the ordinance. As of March, 1975 twenty six (26) communities had passed a similar "Naperville" type ordinance. Since the State Supreme Court's decision, many more communities are reviewing or have adopted local Land Dedication Ordinances.

RESIDENTIAL SUBDIVISION

There has been support locally shown for the enactment of the residential sections of the pending Wheeling Land Dedication Ordinance. This rationale is based on two (2) basic factors:

- 1) Wheeling is now a home rule community and has additional powers to enact and enforce this ordinance.
- 2) The impact cost of replacing open space philosophically should be borne by the developer and/or the future homeowners who create the need for that open space.

Present property owners should not be responsible for subsidizing the purchase of additional open space which would be necessary to maintain the standards the community finds necessary. (National average is 5.5 acres per 1000 persons.)

INDUSTRIAL SUBDIVISIONS- BACKGROUND

The Wheeling Park District saw the need to provide recreational services to the industries which support our district through their property taxes. Industrial employees athletic leagues in Men's Softball, Women's Softball, and Men's Flgg Football have been initiated and have been very successful. We have found that the employee that participates in these activities creates new and strong personal friendships with other employees. We feel this is beneficial to the employer in that it creates a better work atmosphere through comradery and a sharing of like interests.

CETA funding opens park district jobs

"The Comprehensive Employment Training Act (CETA) is another one of the ways we try to seek as many revenue sources as possible," Wheeling Park District Supervisor Dave Phillips said. CETA, Phillips explained, is funding available to meaning counties for sponsors, but...

mer laborers sought with this will enable the Park Department to increase the intensity of park maintenance and provide cleaner and safer parks for the need of residents of the Cook County which came from the federal 16 positions park district also Lake County which also including two grants leader. Phillips said it is the and subsidize portion of federal park district

TO: Board of Commissioners and Department Heads, Wheeling Park District
FROM: David F. Phillips, Superintendent of Parks & Recreation
RE: Comprehensive Employment Training Act
DATE: November 2, 1977

This is a summary of a meeting held with the CETA North Regional Director, Mr. James Hickey and is a review of the programs funded by Cook County, and available to the Wheeling Park District. It is meant to review current programs and familiarize those of us involved with CETA on current/pending funds available.

CODE: PSE = Public Service Employment
OJT = On The Job Training
CETA = Comprehensive Employment Training Act
ASU = Areas of Surplus Unemployment

I. BACKGROUND

CETA funds are Federal monies available to Prime Sponsors (in this case, Cook County) for distribution to Local Sponsors (Wheeling Park District) for the employment of previously unemployed persons. The purpose of CETA is to reduce unemployment costs, where persons are paid for not working, to create Public Service (Governmental) jobs which, for a specific period of time are funded positions. It is the goal of CETA to create and subsidize positions, that upon termination of federal funding may be funded by the Governmental Agency as a full-time position. This will allow the Federal Government to reduce their cost by no longer having to subsidize the CETA employee and his/her family, as the employee would be gainfully employed.

II. REVIEW OF WHEELING PARK DISTRICT'S CETA EMPLOYEES

TITLE	EMPLOYEE	POSITION	FUNDING DATES	EMPLOYMENT
I	Nathan Robertson	Maintenance	4/30/75-9/30/75	Left for other employment
I	Robert Veness	Maintenance	11/1/75-1/15/76	Full time Maintenance to Recreation Coor.
I	Mitchell Cohen	Maintenance	2/15/76-9/30/76	Full time Maintenance
VI	Richard Melton	Maintenance	2/15/76-Present	Budgeted to pick up his salary upon program termination 9/30/78

III. CETA PROGRAMS

- TITLE I - This PSE Program originated with a budget surplus given to Cook County. When funds expired, the program was not renewed.
- TITLE II - For ASU areas with unemployment figures of 6.5% or higher. This is not available to the Wheeling Park District and is only available to three (3) areas in the North Region. Most funds are spent in southern Cook County.
- TITLE VI - Three phases.
 - Phase I - A PSE Program available for communities with a population in excess of 50,000 persons and with unemployment of 4.5% or higher. Only 8 communities are eligible in the North Region. With budget surplus, a smaller employment program of 1-3 persons was instituted for smaller communities. Our Title VI program funds come from this

RECREATION

WINTER - SPRING 1978

WHEELING
PARK DISTRICT

NEPTUNE'S
POOL



SUMMER, 1978



WHEELING PARK DISTRICT

DISTRICT

**FALL
1978**

Wheeling, IL



WHEELING PARK DISTRICT

NEWSLETTER - SEPTEMBER 1978

The Wheeling Park District is now offering their fall programs. There are many to choose from for all ages. These include swimming programs, pre-school and childrens programs, youth athletics, teen activities, adult programs, and special events.

If you have not received a fall brochure in the mail, then you should stop by the park district office, 222 S. Wolf Road and pick one up. Here are a few of the September programs that may be of interest.

FALL TROUT FISHING

This special event will be run at the Community Outdoor Pool, 251 N. Wolf Road, from September 14 - 18th. Bring your own poles, hook and bait. Trophies will be given for the largest and last fish caught. For more information call 537-2222.

CHICAGO BEARS TRIP

The Park District is sponsoring a trip to Soldiers Field to see the Bears take on the Minnesota Vikings. The game is Monday, September 25th and the cost per ticket is \$10.50. The cost for the trip covers ticket, parking and transportation. The bus leaves Heritage Park at 6:00 p.m. and returns approximately 11:00 p.m. There are limited tickets so sign up early at Heritage Park, 222 S. Wolf Road.

GIRLS POWDER PUFF FLAG FOOTBALL

This is the first year we are offering flag football to girls 3rd-8th grades. Clinics, league play, tournament play and awards are all included in this program. The cost is \$10.00 per girl. Play will begin September 10th and will be run on Sundays, from 1 - 4 p.m.

COMPETITIVE SWIM STROKE CLINIC

Our qualified instructor will teach and drill all the competitive swimming strokes preparing the different age group swimmers for winter swimming meets with neighboring park districts. The fee is \$12.00 per person. The program is designed for boys and girls 3rd-12th grades. Clinics are held four times a week beginning September 18th.

LEARN TO SWIM PROGRAM

The learn to swim program is offered year'round for all ages, infants to adult. Our swim lessons follow the Red Cross method of stations. There will be 8 lessons offered each session. Registration for residents for swim lessons begins Friday, September 8th. Non-residents registration begins Monday, September 11th. Lessons are \$8.00 per session.

[Handwritten signature]

Revised 5/77

WHEELING PARK DISTRICT
LABOPATORY (FIELDWORK) JOB DESCRIPTION

A fieldwork student will perform the following duties while working with the staff of the Wheeling Park District. The Student will work a regular 40 hour work week, or as scheduled.

1. Supervise ongoing recreation programs, activities and special events.
2. Assist in all phases of development of programs.
3. Organize and carry out a Special Event.
4. Assist in the evaluation programs and Special Events in a written report to be placed in each program file. Include recommendations.
5. Learn of the close working relationship between Parks and Recreation by working with the Maintenance Department.
6. Become familiar with budget processes.
7. Learn of the elected Park Board/professional staff relationship.
8. Understand the business operation of our indoor pool, outdoor pool, golf course and main office. Assist in making use of the analysis of our business operation through clear reports to our Board.
9. Take part in weekly staff meetings.
10. Learn about the work and preparation needed for presentation of a Bond Referendum to the citizens of our community. Example: A referendum to acquire an existing 18 hole golf course and clubhouse and the acquisition and development of a nature center. The 3.7 million dollar issue passed March 16, 1977 by a 4:1 margin.

AGENCY GOALS

The Wheeling Park District feels that it is beneficial to give fieldwork students the opportunity to learn what day-to-day work is like as a professional in the field of Parks and Recreation. Both the student and the sponsoring agency are able to gain from this experience.

The following items are what we hope an intern student will accomplish during his or her fieldwork training.

1. Have student "fit in" with staff.
2. Have student accept responsibility, authority and accountability as do the other staff people.
3. Have student seek out answers & try to draw on others' experiences to assist his or her development as a professional.

We look forward to having the student assist our park district in the following areas:

1. Help us broaden our services by assisting in the development and follow through of programs.
2. Assist in program supervision.
3. By bringing in new ideas and techniques, the student will help our park district keep up-to-date on new methods of operations developed in the Universities.
4. By challenging us and making our staff extend ourselves to answer the students' questions, and lead by example.

WHEELING PARK DISTRICT

PROGRAM PLANNING

1. DEVELOP A PROGRAM IDEA:

- A. Brainstorm - share ideas with staff, be creative and don't worry about them being unrealistic or impractical. Keep records of the ideas.
- B. Survey interest of the community, good to keep in touch with service clubs, PTA groups, neighborhood groups and participants in our programs. Keep record of incoming calls of suggestions.
- C. Decide what group the program appeals to (age, sex, interests)
- B. Decide number of weeks it will run as well as number of sessions.

2. BUDGET: Develop a Program Budget Worksheet to be approved by the Director of Recreation to include:

A. Expenditures:

- 1. Staff salaries and total hours to be worked
- 2. Rental of facilities
- 3. Equipment and supplies
- 4. Trophies and awards
- 5. Umpires and referees

B. Revenue:

- 1. Decide the necessary fee for the program to cover the total cost. Define maximum participants that can be handled with budget staff and facility and minimums necessary to break even.
- 2. Decide if the program is to break even, not to cover costs or produce revenue over expenditures.

This is done prior to the start of the program. You just follow budget as stated.

3. SCHEDULING:

- A. Conflicting agencies and programs in community: check with other agencies offering programs and try to avoid duplication, go co-op or develop feed-in program or vary the scope, or go with the program.

- B. After deciding on an agreeable time and day for the program, find out what facilities are available at that time:

- *(C)
 - 1. Park District facilities
 - 2. School District #21 & #214 facilities

- D. Put the information on the calendar and/or get a contract from the School District. Define the set-up of the area for Maintenance to put on their calendar.

- * C. Consider size of group in relation to facility, time of day, attention span. Make most out of facilities and try to expose people to the Indoor Pool whenever possible.

WHEELING PARK DISTRICT
PROGRAM SURVEY

The Wheeling Park District is soliciting your comments in order to improve their recreation programs. Your comments will enable us to make the necessary adjustments in the programs to better serve you in the following session(s).

(Name of Program) _____ (Location) _____ (Instructor/Supervisor) _____

1. How do you rate the performance and the ability of the instructor to transmit the necessary skills to program participants?

Excellent _____ Fair _____ Poor _____

Comments: _____

IG SCALE

2. Did you (your child) participate in this program last year? Yes _____ No _____

3. Would you (your child) participate in the program if it is offered again?

Yes _____ No _____

4. Were you satisfied with the location, time and day the program was held?

Yes _____ No _____ Comments: _____

ood

ent

5. Do you have any suggestions concerning improvements that could be made in the program through the use of different equipment, written handouts, visual aids, instructors approach in handling the program, etc.? Comments: _____

6. In your opinion, was the class size and classroom conducive to quality instruction for all participants? Yes _____ No _____ Comments: _____

ability to

7. How did you find out about this program?

Poster _____ Brochure _____ Newspaper _____ School Flyer _____ Another person _____

ict.

workers.

8. Additional comments on this program: _____

9. What special interests or new programs would you like to see implemented by the Wheeling Park District? _____

10. Would you consider volunteering your time/talents to help with any of our programs?

Yes _____ No _____ Comments: _____

This form may be returned by folding, stamp and mail. (Return address is printed on the reverse side.)

good condition.

Thank you for your cooperation,

2/76

WHEELING PARK DISTRICT

8/27/75

Rehire _____
Not rehire _____
Salary Recommended _____

INDOOR POOL SURVEY

COMMUNITY NUMBER OF POOLS PRESENT POPULATION	WHEELING 1 INDOOR, 1 OUTDOOR 18,100	PARK DISTRICT POOL SURVEY--COMPILED BY WHEELING PARK DISTRICT ARLINGTON HEIGHTS 5 OUTDOOR, 1 INDOOR 75,000	BUFFALO GROVE 1 INDOOR, 1 OUTDOOR 18,400	ELK GROVE COMPLEX 1 INDOOR, 1 INDOOR-OUTDOOR 25,300	LOCKPORT TOWNSHIP 1 INDOOR POOL 40,000	MT. PROSPECT-4 POOLS 1 OUTDOOR-1 INDOOR/OUTDOOR COMPLEX 45,000
INDIVIDUAL FACILITY EVALUATION POOL CONSTRUCTION, COST AGREEMENTS AND LOCATION. COMMENTS: Joint use by the school and park allows maximum use and cost efficiency. Mandatory	Built in 1969-70, \$660,000 through g.o. bond issue. Adjacent to High School. P.D. reimbursed for 55% operating expense by Dist. #214, who leases the pool 12 hrs. day during school year. Also reimbursed for 36.97% of P&I payments.	Built in 1968-69, \$800,000 adjacent to High School. (Administrative offices built, also) Same agreement as Wheeling and Buffalo Grove.	Built in 1973-74, \$440,000 adjacent to High School. Same agreements as Wheeling and Arlington Heights	Built in 1969 adjacent to a Jr. High. Indoor-Outdoor Complex initial cost \$550,000 Cost sharing 60% - 40% Chemicals, etc.; 40%-60% Utilities	Built in 1973 (\$494,000) with matching money (50% HUD) Adjacent to High School 50% reimbursed by School.	Outdoor built adjacent to Jr. High in 1965-roofed over in 1972 for \$326,000 over initial cost. School use: 8:15am-3:00 pm, Mon, Tue, Thur, Fri./school year.
POOL SIZE, GALLON CAPACITY, DEPTH COMMENTS: POOL SIZE DEPENDS ON A COMMUNITIES NEEDS. RECOMMEND A SEPERATE DIVING WELL AND SHALLOW MAIN POOL, IF AT ALL POSSIBLE. MAKES THE FACILITY MORE USABLE AND FUNCTIONAL FOR SWIM LESSONS, OPEN SWIM, ETC.	25 yard - 6 lane pool (75'X42') with 2 1 meter diving boards. 148,700 gal. capacity, 3 1/2' shallow end and 12' deep end. Comments: Usually only staff 1 guard. Not enough shallow water for lessons suggest seperate diving well & shallow main pool for increased flexibility. Would increase op. cost.	25 yd, 6 lane shallow pool with 3'6" shallow water ends 5' center. diving well: 40X45 with 12' depth. 2 1 meter & 1 3 meter boards. Wading pool outside on patio. 8,000 gal Main pool: 113,906". Diving well: 144,000". Comments: Ideal	25 yd., 6 lane pool w/2 1 meter boards. 3 1/2' shallow water. 11' deep end. Comments: Seperate diving well needed. Outside wading pool desired.	25 yd., 6 lane pool w/2 1 meter diving boards. Shallow end: 3 1/2' Deep end: 12' 114,600 gal. capacity Comments:	25 yd, 6 lane pool. 2 1 meter boards. Shallow end: 3'. Deep end: 10', 137,000 gallon Comments: Pool is aluminum and paint won't adhere, water temp. hard to maintain. Good size for this community.	25 yd, 6 lane pool, 2 1 meter diving boards, 1 3 meter board. Shallow end: 3'. Deep end: 12'. Comments: Suggest diving well for diving competitive swim, open swim and lessons.
FILTRATION SYSTEM COMMENTS: Install Diatomaceous Earth filters for max. effect- iveness. Need large storage area for chemicals.	High rate sand filter "Very poor for heavily used pool."	Vacuum Diatomite "Works well, also added automatic chlorinator to eliminate human error in water chemistry."	Diatomaceous Earth Sandwich filter. "Great"	Diatomaceous Earth "Entire filter system was color coded"	Diatomaceous Earth "Good"	Diatomaceous Earth "Good" "Not enough storage area".
POOL DECK CONSTRUCTION COMMENTS: Ceramic tile a must	Ceramic tile added after 3 years of painted cement. "Was desperately needed. Mandatory to add heavy- duty waterproof barrier under all deck to elimi- nate leaks. Should have been installed with init. const.-double cost to install later."	Ceramic tile. "A little slick".	Cement deck with brush finish. "Creates a tough algae problem. Project installing ceramic tile."	Cement deck "Slippery now, will install ceramic tile."	Cement deck. "Terrible, can't keep it clean."	Ceramic tile deck. "Great".

WHEELING PARK DISTRICT 1975 GARDEN PLOT SURVEY

Please fill out the questionnaire below and return to the Wheeling Park District office in the enclosed self-addressed, stamped envelope.

This survey will enable us to receive your input as to your interest in the program and will assist us in evaluating the free garden plot program to make it better next year.

Do you feel the garden plot size of 20' X 25' was adequate in size?

YES 13 NO 7

If not, would you like the plots smaller or larger? SMALLER 24 LARGER 2

Will you attend the free instructional class held prior to the distribution of the garden plots? YES 22 NO 14

If yes, did you find the class interesting and/or helpful? YES 20 NO 2

Would you like to see a harvesting and food preparation class in the summer explaining storage, canning, freezing, etc. of your crop? YES 26 NO 7

In the future, would you be interested in forming a Gardening Club? YES 14 NO 16

Were there any problems involved in soil preparation, planting, weeding, control, etc. that perhaps the Park District could have assisted with? YES 15 NO 23 If yes, please specify: _____

Additional comments and/or suggestions were: _____

Rototiller

Reassign unused plots

Use no-earth

Water, weed control and pesticides

Keeping the same plot

Larger plots

**Land rush in 1978?
Wheeling gardens
grow in popularity**

By Mary Anne Hannemann

The Wheeling Park District is thinking about spring in the middle of winter.

District officials soon will offer free garden plots to local residents for the fourth year in a row. Recreation director Jan Schwass says the program's popularity increases every year.

"We gave away all the plots within two weeks of the start of registration last year," Schwass says. "After our first year, the waiting list was so long we expanded the land for plots about three times."

Registration for '78 plots will open Feb. 1.

The 212 plots are on Commonwealth Edison right-of-way on Wheeling Rd. south of Dundee Rd. The park district mows, plows and maintains the land in exchange for its use.

"At least half of Wheeling consists of multifamily housing, so residents don't have a lot of land to grow things on," Schwass says. "It's really nice in the summer to see everyone taking care of their plots."

"A lot of people experiment with their gardens," she adds. "They grow things they're not used to growing. We get lots of sunflowers, corn, tomatoes, beans and usually some really unusual types of vegetables."

The district offers free canning and freezing classes in the fall, Schwass adds.

Registration will be open through March 31 or until all plots are taken. Families who had plots last year will be given first choice. Only one plot per family is allowed.

Park-district residents have priority, Schwass says.



BARBARA JAVENS hopes the earth will be good to her as she tends to her Wheeling Park District garden plot on Dundee Road.

PRE-SCHOOL

Will a kiss for the Easter Bunny mean more goodies in her Easter basket? Only time will tell for Theresa Fink, who engaged in a little feminine bribery during a park district pre-school class last week. Classmate Dayna Salasche (left) is checking on her freshly dyed eggs, nesting in the basket the three-year-olds made in class. Wheeling Park District "Lots for Tots" classes meet daily from 9:00 until 10:30 a.m.

(Staff photo by Jean Perkins)





THE WORLD LOOKS very different when you're upside down, but Edward Vincent, 4, seems to enjoy the view. The boy is a participant in the Wheeling Park District's pre-school tumbling class for 4-and 5-year-old boys which meets Wednesdays.







WHEELING PARK DISTRICT
PRE-SCHOOL NEWSLETTER
CHRISTMAS 1976

We are very proud of our PRE-SCHOOL PROGRAM. STORYTIME continued.

If you've seen our programs, you know the children are busy in all sorts of activities such as games, gym time, songs, storytelling, crafts and free play. Your child is having fun and constantly growing and learning. Our goals are geared toward total development of the child, individual as well as group accomplishments. Our experienced, qualified instructors want to further explain the purpose of some of our activities.

GAMES AND SONGS

Games and songs are a large part of our Pre-School Programs. Games give the children experience in developing some of their social mannerisms. Learning how to play with their peers is an important part of their growth.

With games and songs, they also learn how to listen and react to instructions.

The use of motor skills, such as running, skipping, throwing balls and stretching, are brought into the different games and songs to help develop coordination and cooperation. The children don't realize all the development that is occurring when they play with others and do the activities.

The songs used are fun songs with some finger and body movements. Songs are helpful in getting children to work together. They must learn to sing the same

words at the same time doing a variety of simple movements. This is a very good way to develop eye-hand coordination and group participation. Many of the children are

very shy and through games and songs, some of this seems to melt away and they let

Also, the facts and experiences brought to a child through stories broaden his total scope of knowledge and enrich his total learning process.

Books can help a young child understand himself and his relationships to other people. They can reassure him about his strong feelings of anger, fear and jealousy by proving that all these feelings are universal.

Besides these skills, storytime develops listening skills, increases attention span, develops curiosity and increases memory span.

FREE PLAY

A child learns thru play. To a child play is work. Free time play is a time for the pre-school child to learn and develop many skills: productivity and creativity, sharing, pretending, inter-acting with other children, cooperation, and encourages language and initiates activities.

During this time, children are free to use paint, crayons, paste, scissors, Playdoh, puzzles, the blocks corner, the doll corner, kitchen corner, trucks and table games.

Play is a medium which young children learn about themselves, about others and about their world

ARTS AND CRAFTS

We try to offer a wide variety of experiences in the "small motor skills" field. This includes such things as

September 14, 1977

Dear Parent:

We'd like to take this opportunity to welcome you and your child to the Wheeling Park District Pre-School Program.

In order to facilitate your child's entry into his pre-school environment, we have a few suggestions that may prove helpful to you. It is best to leave your child at the door of the pre-school room and to say your good-byes quickly. If he is crying, first reassure him that you will be back when it's time to go home, then leave. We will soothe and reassure him and chances are he will stop crying very quickly.

It is extremely important to your child that you be on time when you drop him off and prompt when you pick him up. It is difficult to be the last person to come into a roomful of children already engaged in an activity. Even more important, being a couple of minutes late can seem like an eternity to a small child and can make him fearful that you may forget him in the future.

It is best that playclothes be worn to school because even though we try to be careful with smocks, spills do occur. We will also be working on the floor such as crawling, tumbling, etc.

In order to help develop your child's coordination and his feeling of independence, let him put on his own coat and button or zip it himself, if possible, without pressuring him beyond his capability. Also, let him hang his own coat in the hall closet, but please make sure all things are clearly labeled with his name.

It is important that your child be dressed properly for the weather for we will be engaging in many outdoor activities. Of course, we won't be going out when it's raining, but we will go out when there is snow on the ground, so boots and mittens are a must.

It will be greatly appreciated if you contact us when your child has a contagious disease so we can notify other parents of the exposure. Some diseases such as strep throat can have serious side effects if untreated, even though the child's symptoms may be very mild. We are also asking that your child be kept at home if he has a fever or active cold (coughing, sneezing and running nose). Allergies, of course, are not contagious.

SWIM PROGRAM





Splashing away to water safety

Muffled cries and soft sobs blend with the sounds of water splashing against the edges of Neptune's Pool during infant swim classes. The 2 month to 2-year-old youngsters, aided by parents and instructor Pat Reichman, are introduced to the water to begin learning basic swim movements. The class also attempts to pattern the youngsters reactions, teaching them to turn to the sides of the pool and lift themselves out to safety. At Saturday's class Bart Boris-Blaisdell, left, found more interest in his favorite toy and comfort in the arms of his mother, Beth Boris. Heather Oakes, above, is coached by her father, Willis, as she attempts to pull herself out of the water. Infant Marjie Becker, below, seems to adapt well to the wet environment as she floats between the arms of Reichman and her mother, Sandy, far right. (Staff photos by Kathi Hostert)



Splash down

Laurin, 14 month-old daughter of Kandi Skrabala, splashes happily after her plastic whale during the last session of the infant swimming classes offered by the Wheeling Park District. The infants are taught to kick, hold their breath and work their way to the side of the pool. (Staff Photos)

Wheeling team needs to have more swimmers

By KEITH FREEMAN
Correspondent

EVEN THOUGH the Coho swim club defeated the Wheeling park district team, the Neptunes, by almost 200 points (332-142) on Thursday, Aug. 2, Wheeling age-group program coach Matt Zukowski would like that fact publicized. Since they don't have a team in either of the park district league's closed or open divisions, Zukowski's team has no set schedule, they compete against other park districts in pick-up meets.

"The kids I have are really pretty good, the problem is that I just don't have enough of them," said Zukowski, whose team now has 40 kids in the summer, 25 of whom he expects to see in the winter as well. "Our 11- and 12-year-old boys on our team that hang around together and they're all extremely interested in football, which might cause them to leave competitive swimming before high school.

"WITH SWIMMING," says Zukowski, "the swimmer has to be willing to stick it out. Practice is not easy, the kids see the same wall lap after lap. The kids can get tired of that and quit the program. As I said, our 11- and 12-year-old boys are really fine. And two of our 9- and 10-year-old girls, Val Sabal and Gina McInerney, are coming along faster than usual; placing well in every meet with only about a year's experience behind them."

Ronny and Steve Ray, Kenny Pierini and Marc Czaja are the four 11- and 12-year-old boys that Zukowski is proud of. As for the girls, Sabal just started swimming competitively this year, but she took three seconds and a first in the freestyle, butterfly and backstroke races. In her freestyle and butterfly races, McInerney had three first-place finishes against Coho. Zukowski now feels that he can count on Sabal and McInerney to regularly become a one-two punch, in terms of their swimming finishes.

Zukowski would love to see more Wheeling youngsters join the park district team in the future. He lets all his swimmers know that the practices can get tedious, but Zukowski has learned that practice is not the only needed ingredient in a swimmer's success.

"I used to have the kids swim once a day, two hours each time during the summer," said Zukowski, who will try to enter Wheeling as a closed division team in the park district league next

summer. "In the winter, practice would be held four days a week, for an hour and a half each time. The swimmers became burned out with practicing so much. I've now noticed that I've had better success with just holding practice on every other day. As I've become more experienced in coaching swimmers, I've noticed that the added rest is the best thing for them."

THE COHO SWIM club has 150 swimmers on its roster, but sent 40 of the kids who don't swim regularly to the meet, according to Coho assistant coach Jo Anderson.

Betsy Paletti and Billy Merkle are two 10-year-olds on the Coho club who can win their races almost every time out. Merkle's times are reportable nationally, making him rank in the top 10 for his age group.

Coho coach Art Edstrom hosted Merkle's family at his summer home on the Michigan peninsula during the past weekend. Edstrom, who is also the Deerfield high swimming coach, is helping to get Merkle ready for the Schroeder hotel AAU meet in Milwaukee on Aug. 16, 17 and 18.

"That pool at the Schroeder swim club is considered to be the fastest pool in the United States," said Coho publicity director Linda Steffl. "The shallowest part of that pool is seven feet deep, with the deepest part being 17 feet. The swimming lanes are seven feet wide, which is much larger than usual. The added depth adds buoyancy to the swimmer, and the added width of the lanes makes the water less turbulent. That is why that pool is considered to be the fastest in this country."

MERKLE AND PALETTI were just two of the Coho regulars who weren't needed at Wheeling, for that novice meet.

"The Wheeling meet was good because it allowed the kids who barely swim a chance to win first-place ribbons," said Anderson. "Our better swimmers weren't allowed to go. We used 11- and 12-year olds at the 15-and-over age groups and they were winning races. Wheeling has the nucleus for a good program, they just haven't been swimming together very long. As for us, I sometimes wonder if we have too many stars and not enough depth. Billy Merkle is good for three first places every time, but he can't also go out and take seconds and thirds for you. You have to get a team effort out of all your kids."

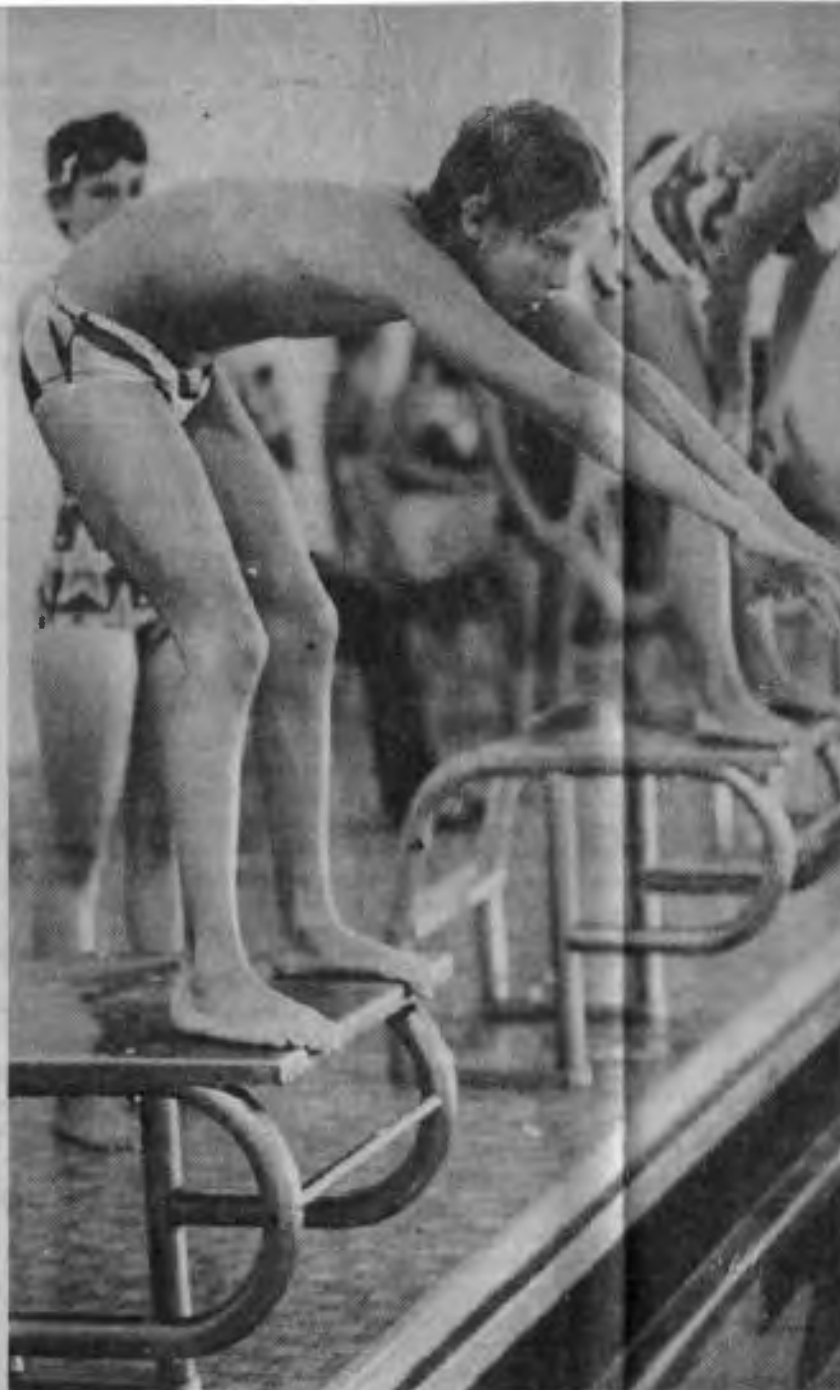

RONNY RAY GETS ready to dive, during last week's swim meet with Deerfield's Cohos. (Photos by Steve Donisch)



JAMIE ACKS LOOKS amazed at her place and time at the finish of the 100 freestyle.

Photos by Steve Donisch

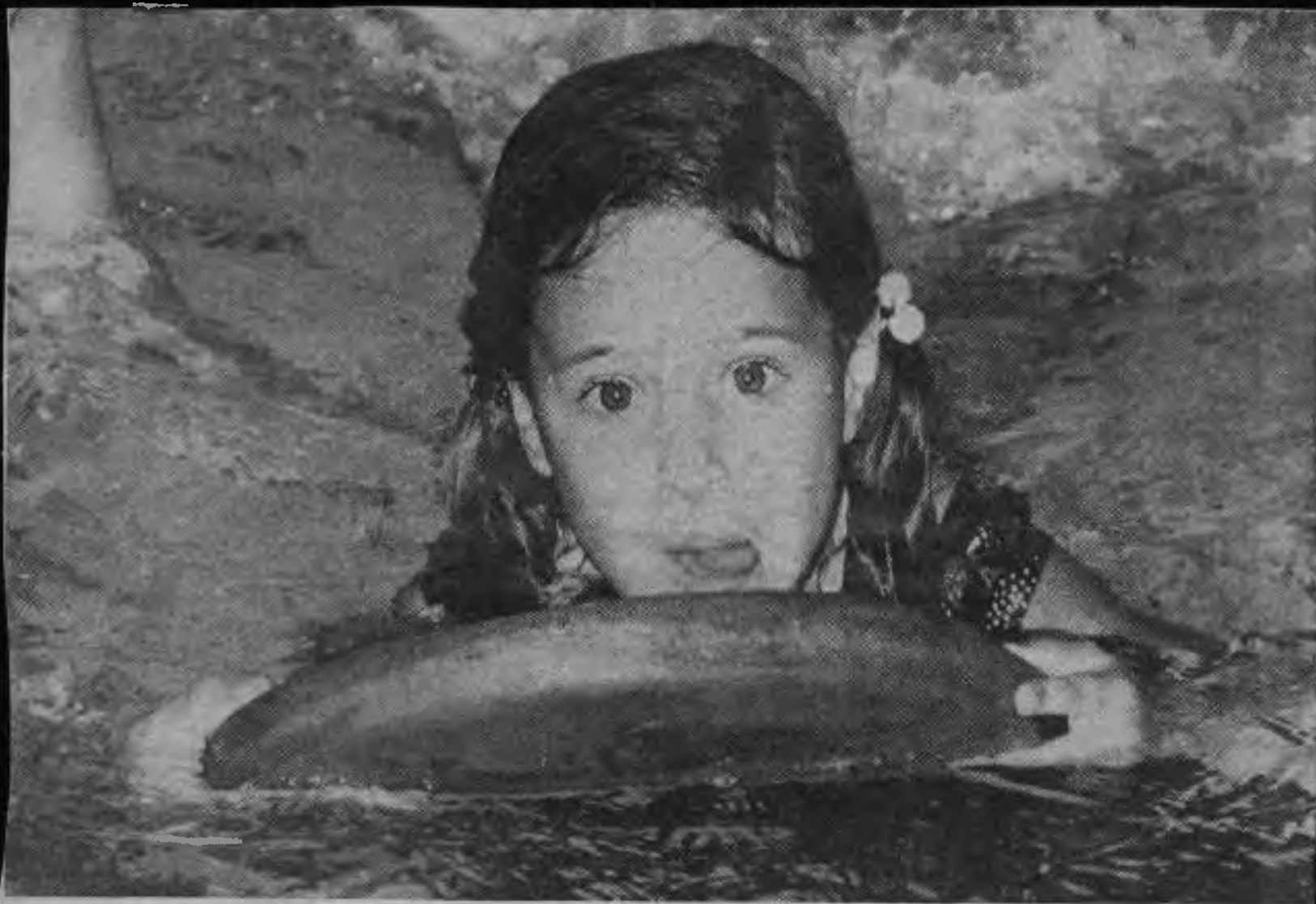

SHEPENE AZARBARZIN, 5, looks a little apprehensive as she maintains a floating posi-

tion in a learn-to-swim class sponsored by the Wheeling Park District.



Neptune's Pool, located adjacent to Wheeling High School, 900 S. Elmhurst Rd., is now open from 7:00 to 9:00 p.m. on Friday nights.



EYES are on the instructor during an adult be- Wheeling Park District swim class meets Mondays
g swimming class at Neptune's Pool. The

WHEELING PARK DISTRICT
INFORMATION ABOUT YOUR POOL PASS

1978-1979

Your annual pool pass is valid from May 1, 1978 until May 31, 1979 at Neptune's Indoor Pool (adjacent to the Wheeling High School, corner of Hintz and Route 83) and the Wheeling Community Outdoor Pool, 251 N. Wolf Road.

PATCHES MUST BE SEWN ON BATHING SUITS. Your pass is not transferable. Due to past situations, you will not be admitted into the pool unless the patch is sewn on your bathing suit. Pool personnel may be questioning individuals before admittance to the pool is granted. Your pool pass is a privilege and will be confiscated without a refund if abused in anyway.

A pool pass lost by a passholder may be replaced for \$5.00. A guest pass may be purchased by Wheeling Park District residents having a family pool pass for out of town visitors. The fee is \$5.00 for 10 swims. Guest passes are available at Heritage Park only.

All rules concerning safety and health as suggested by the State of Illinois will be enforced. All conduct rules and regulations will be enforced.

Street clothes and shoes will not be permitted on the pool decks. Street clothes must be placed in lockers provided. Lockers require 10¢ and the Park District strongly suggests that they are locked.

Both pools are heated for your comfort. There are saunas for men and women located in the exercise room at Neptune's Pool at no charge.

Bathing caps are available and hair longer than 5" must be tied back. Children 6 years of age and under must be accompanied by an adult.

COMMUNITY OUTDOOR POOL SWIM HOURS

MONDAY thru SATURDAY	1:00 - 5:00 & 7:00 - 9:00 pm
SUNDAY and HOLIDAYS	1:00 - 5:00 pm

The outdoor pool will be open Saturday, June 17, 1978 and will remain open until Labor Day at 5:00 pm.

NEPTUNE'S INDOOR POOL SWIM HOURS:

Neptune's Pool Spring hours will be in effect until Sunday, June 11, 1978.

The following summer hours will begin Monday, June 12, 1978:

MONDAY thru FRIDAY	2:00 - 5:00 pm & 7:00 - 9:00 pm OPEN
	9:00 - 9:45 pm ADULTS ONLY
SATURDAY	1:00 - 5:00 pm & 7:00 - 9:00 pm OPEN
SUNDAY & HOLIDAYS	1:00 - 5:00 OPEN



YOUTH ATHLETICS



Watch out, Cubs!

Brett Pollard, 6, soon will be ready to step up to the plate, with the help of Joe Riddle and the Wheeling Park District baseball clinic.

Photo by Michael Wirtz



4/22/77

WHEELING PARK DISTRICT
MASTER PLAN FOR YOUTH SPORTS

PURPOSE AND FORMATION OF AD HOC COMMITTEE:

The purpose of the Ad Hoc Committee is to assist the Wheeling Park District in compiling a master plan that states our Youth Sports philosophy by re-evaluating the goals and directions of our Youth Sports program.

The Wheeling Park District's Youth Sports Ad Hoc Committee will be composed of the Recreation Staff and three (3) residents of the Wheeling Park District. Those residents are chosen to be members of the committee by the Park District staff, with the approval and consent of the Board of Commissioners. The Ad Hoc Committee will meet after every major Youth Sport program to review and give input on the program evaluation. The three lay people will serve on the committee for a period of one year, will serve as required and when called upon by the staff. These members will be reviewed at the end of one (1) year and either be reappointed to serve another year or a new member will be chosen to serve for one year.

The members are parents and chosen based on their positive involvement in two or more Youth Sports activities. The Ad Hoc Committee will receive a booklet of information concerning each of the programs they will be reviewing (rules, inventory of supplies, evaluations, questionnaires, etc.). The Board of Commissioners will be given a progress report from the Ad Hoc Committee of their review process. However, all final decisions are made by the Board of Commissioners. It is further stated that this master plan, when approved by the Board of Commissioners, replaces all other advisory groups of the Wheeling Park District.

GOALS & OBJECTIVES:

1. To insure that all youth have fun, have a good experience and become physically fit.
2. To keep competition and winning in perspective.
3. To insure that every child participates in all games regardless of degree of ability.
4. To keep fees to a minimum in every sport.
5. To stress fair play and team work, values and attitude.
6. To teach the proper basic skills and fundamentals throughout the program.
7. To give positive motivation to the children and allow them to develop their skills at their own speed and to their maximum performance level.
8. To teach the children respect for rules, officials and individuals on the other teams.
9. To involve the parents and volunteers in conveying the values of skills of sport to the children.
10. To hold mandatory coaches clinics that stress our philosophy, the skills and attitudes to be taught.

ACTION STEPS:

There will be no try-outs (everyone plays) and no all star teams (all participants are equal). In choosing teams, the Recreation Coordinator and League Supervisor will divide the children into teams after the clinics by skills so the teams are evenly balanced. In football, they will further be divided by weight and age. Players will be randomly assigned to new teams as they progress to the next division (from Flag to Jr. Tackle, from Jr. Tackle to Sr. Tackle). We will continue to cooperate with neighboring park districts and invite teams into our park district Youth Sports programs. We will, however, make it clear that all players and coaches must abide by the Wheeling Park District rules and philosophies. This will help keep competition low keyed.

Youth sports program is a success

By JOANNE KANTER
Correspondent

WHEELING — A master plan for youth sports implemented a year ago by the Wheeling Park District is very successful, according to Janet Schwass, director of recreation.

Schwass said the youth sports programs are the most popular given by the park district and involve 150 to 350 boys and girls at any one time. She said last year the need was felt to solidify the efforts of the park district and establish goals in the programs. An ad hoc committee was formed which oversees the programs.

The park district has just hired Ralph Baker as its recreation leader. Baker will work in all sports and will be available while the programs are going on. This will "open up communications" between the park district and parents, said Schwass.

David Phillips, superintendent of the park district, said, "It is important for children to have fun while they are learning skills." In the youth sports programs everyone gets a ribbon at the end. "We have the philosophy that everybody wins," noted Phillips. The youth sports programs are not highly competitive, but are instructional, according to the superintendent.

THERE ARE INSTRUCTIONAL clinics for two weeks before each sport is commenced (more for football so the players are in shape to avoid injury).

"We try to have the kids work up to their own level," said Schwass. She said after the instructional clinics are held teams are balanced for ability.

Referees stop the game and explain what the youth are doing wrong if they are penalized, said Schwass.

Phillips said children who are more competitive have other programs, like Little League, in which to play baseball. The park district baseball program is much more low key, he explained. The players receive hats and tee-shirts instead of fancy uniforms and have a lot of fun.

According to Phillips, "Once the coaches and parents understand the philosophy, it (the experience) becomes smooth-flowing and not high-tension."

Schwass explained that there are 20-minute drills before each game (no matter what the sport). The drills are learned in the instructional clinics. In this way, the sports are taught and youth sports become more of a learning experience than a competitive one.

SCHWASS SAID the park district expects close to 400 youths to sign up for baseball this year. She said there will be two sites for games this year, at Wheeling High School, where the games have been held until this year, and at Heritage Park. "Up until two years ago we didn't have a youth baseball program," said Phillips. "It has gone from zero to over 300."

Soccer is a new sport for the park district and will be taught in the spring at the same time as baseball. Schwass said she is sure soccer will grow as fast as the other sports have.

Phillips noted that fees for youth sports programs are low so that everyone who wants to can play. He said the

Wheeling Park District fees are comparable, if not lower than other districts in the area.

GOALS AND OBJECTIVES listed in the master plan:

- To insure that all youth have fun, have good experience and become physically fit.
- To keep competition and winning in perspective.
- To insure that every child participates in all games regardless of degree of ability.
- To keep fees to a minimum in every sport.
- To stress fair play and team work, values and attitude.
- To teach the proper basic skills and fundamentals throughout the program.
- To give positive motivation to the children and allow them to develop their skills at their own speed and to their maximum performance level.
- To involve the parents and volunteers in conveying the values of skills of sport to the children.
- To teach the children respect for rules, officials and individuals on the other team. Phillips said after each game the teams line up and shake hands as is done in professional hockey.
- To hold mandatory coaches clinics that stress the philosophy, skills and attitudes to be taught.

THERE ARE NO try-outs and no all-star teams. Teams are balanced for ability and in football by weight and age as well.

Phillips said there are no fund-raising events for participants in youth sports. "We feel the park district should back these sports," he said. "We don't feel as a tax-supported agency we should seek that type of funding," he added.

The park district has even done away with football banquets and award dinners also. At the culmination of each sport, a party is held with juice and cookies and the ribbons are given out.

Schwass and Phillips are very enthusiastic about the youth sports program, and if the numbers of participants are any indication, so is the youth of Wheeling.



Eye on the ball

Wheeling Park District peewee baseball player Judd Zusel kept his eye on the ball all the way but it didn't do him much good on this particular pitch as he practiced his hitting and other ballplaying skills in a Park District sponsored clinic for the youngsters. About 150 kids are expected for this year's league play. (Photo by Don Preisler)



Mike shows Jim Annis the finer points of making a forehand in classes for inter-

mediate tennis players sponsored by the Wheeling Park District. Classes are held

three times a week for beginners and intermediates at Heritage Park's outdoor courts.

Park District Football



Football season has started at park districts throughout the suburbs. Here the Cardinals are playing the Packards, and the Cards won by a touchdown. These aren't the "Greenbay Packards," but Wheeling Park District Tackle football teams.



IT'S UP AND — hopefully — over at a practice session of the Wheeling Park District's girls' junior high school volleyball team. The girls are preparing for their first league game Saturday. The league will run for seven weeks, placing the girls against seventh and eighth graders from five area park districts.



THE size of these aspiring basketball players does not seem to daunt their enthusiasm as they practice in the Wheeling Park District's program on Saturday mornings. (Photo by Carole Cantrell)

Floor hockey leagues planned by park district

The Wheeling Park District will sponsor floor hockey leagues for girls and boys beginning Saturday Jan. 10.

The girls' league will offer divisions for third and fourth graders, and fifth and sixth graders. Games will be at Heritage Park gym, 222 S. Wolf Rd.

The boys' league will offer four divisions — first and second grade, third and fourth grade, fifth and sixth grade, and seventh and eighth grade. The east league for boys will play at Heritage Park and the west league at Field School, 51 S. Armand Ln.

Individual trophies will be awarded to first place winners and ribbons to second and third place winners.

Registration is now under way at Heritage Park. The deadline is Jan. 7 and teams will be announced Jan. 9. The fee is \$8 for the first child in a family, \$7 for the second child and \$5 for each additional child.

For further information, call 537-2222.



WHEELING HIGH School student Chuck Carlberg lines up a shot during a drop-in basketball session at Heritage Park.



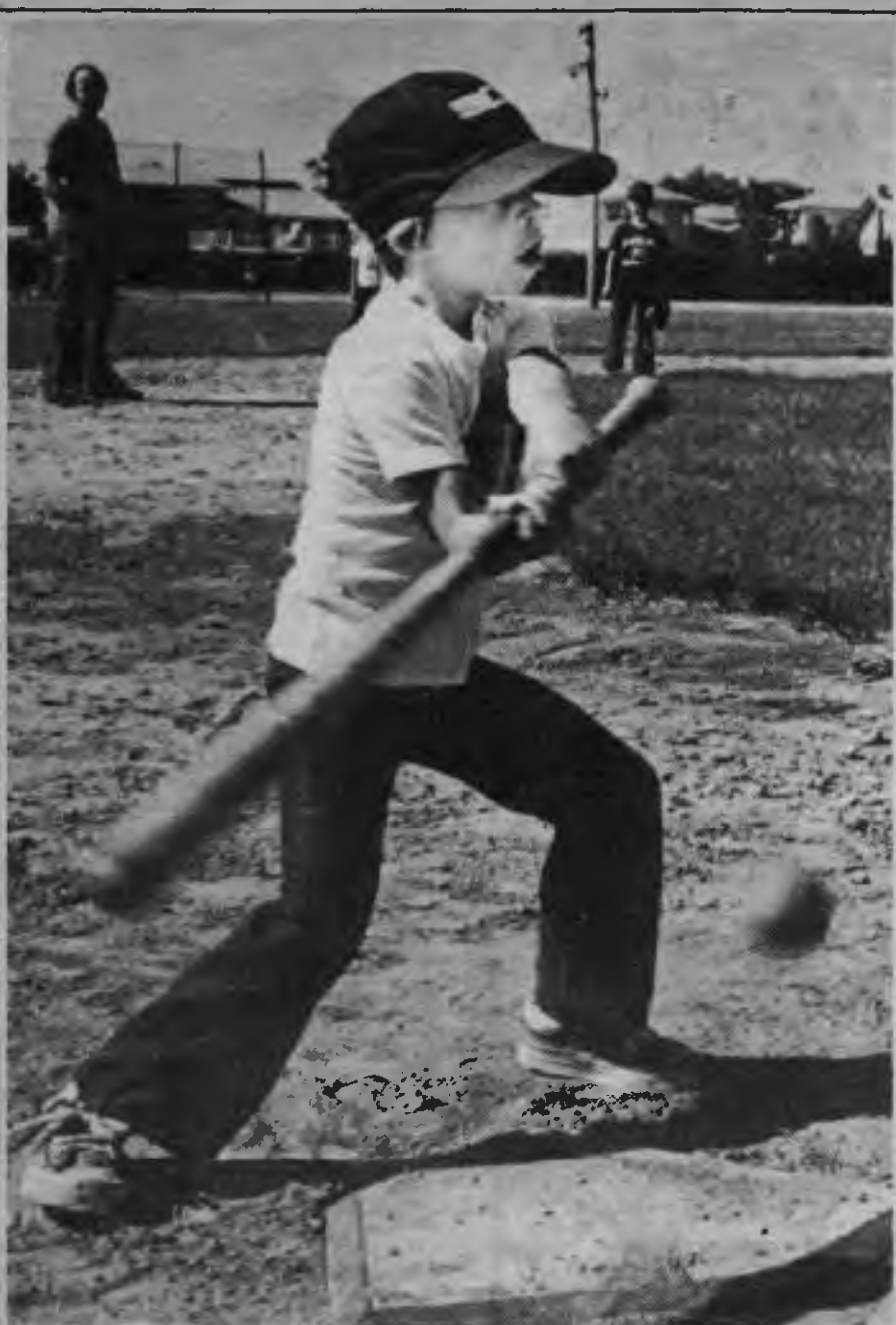

Swing batter

Batter Mike Helfgot takes a wicked cut at a low-and-away pitch in the Wheeling Park peewee baseball clinic held recently for some of the 150 youngsters expected to turn out for league play this year. (Photo by Don Preisler)



A helping hand from Elizabeth Stump-hauser, coach for the Wheeling Park District, steadies Dawn Ebert during her practice on the balance beam at Wheeling High School.



Practice makes perfect

A member of the Wheeling Park District gymnastic team is instructed by assistant coach Shela Edens about her form on the balance beam during the practice session at Wheeling High School. The team practices every Sunday in preparation for their meet at 10:00 a.m., May 20 at Navy Pier in Chicago. (Staff photo by Dean Rutz)



Trib photos by George Thompson

Spring training

Our baseball tip for today is you are never too young to swing a bat — just ask Scott Kier, 6, who learned the basics last week in a Wheeling Park District class. The "pitcher" — feeding an automatic ball-thrower — is Bobbie Neuman. No spitballs or fancy curves, please.



Got no strings

Puppeteer Jenny Arwine, 4, doesn't rely on strings to operate her newly constructed sock puppet — just finger-power on her creation at the Wheeling Park District Heritage Park puppet making class for pre-schoolers. (Staff photo)

CHILDREN



Children



SHUFFLING through a Wheeling Park District dance program. Saturday's recital was at Wheeling High School, Wheeling.

SPECIAL ACTIVITIES



DEBBIE Carlson (left) a member of the Wheeling Park district staff weighs a trout caught by 11 year-old Cheryl Perricone during the trout fishing derby at the Chamber Park pool Saturday, Sept. 18. The trout weighed one and one-half pounds. (Photo by Daniel Kiliarsky)





Swinging into action

Concentrating on tossing the ball is the key for Greg Mueller to put the power into his swing at the Wheeling Park District Pitch, Hit and Run Contest. Every contestant received points in accord with their degree of skill in accurate pitching, farthest distance in hitting a ball and fastest time in running the bases. The winners from each age group will compete in the district contest June 3 in Heritage Park. (Staff Photos)



JULIE GRONLAND TOOK first place in her event —hitting the ball as far as you can from the tee— during the Wheeling park district's Superstars competition held last week. (Photo by Steve Donisch)



Simply smashing

Jay Woldenburg, 12, smashes for the final game and match winning point in the Wheeling Park District table tennis tournament held Sunday at Heritage Park. Though he dropped his first game of the match, Jay came back to take the last two games in decisive fashion. (Staff photo)



Easy runner

With nary another runner in sight, a competitor in the Wheeling Park District turkey trot rounds the cones and heads for home and a high placing at the Heritage Park event Sunday. (Photo by Dean Rutz)



Snowmobile pilot's license now available in special class

A Wheeling snowmobile club, in conjunction with the Wheeling Park District and the Illinois Department of Conservation, will sponsor a snowmobile certification course Monday and Tuesday.

Under Illinois law, youths 12 to 16 years of age must be certified to operate a snowmobile. Wheeling police Lt. Tom Conti, a member of the All in the Family Snowmobile Club, said people passing the course will receive their certification.

Interested residents may sign up in person at Heritage Park, 222 S. Wolf Road, between now and Monday. Registration fee is \$3.50.

Conti said the course will be divided into two parts. The first will consist of two evenings of classroom instruction Monday and Tuesday. Students will learn the proper and safe handling of a snowmobile and will be taught how to make emergency repairs.

Students will also receive basic first aid and learn the proper hand signals for turns

and stopping. The course will run from 6:30 p.m. to 9:30 p.m. both days.

The second part will require the students to correctly handle and operate a snowmobile. Conti said driving tests would be given Jan. 15, if there is enough snow.

The test will require a student to correctly unload a snowmobile from a truck and start it. He or she will have to drive the snowmobile around obstacles, using the correct hand signals.

The students will also have to correctly change the snowmobile's drive belt and spark plug. Then they will have to load it correctly onto the truck.

Conti said the classroom part of the clinic will be given in the Gable Room of the Chevy Chase Country Club.

The practical exam will be given during the morning of Jan. 15 at the Cartriseal plant, 634 Glen, Wheeling. Students will be able to unload their snowmobiles in the plant parking lot and use an adjacent field for trial runs.



Magic? It's knot easy!



Magic.

The mere thought brings to mind flashy illusions of lions and tigers appearing and sawing lovely assistants in half.

Before the gaudy tricks come the basics and magician Joe Vyleta came to the Wheeling Park District magic clinic at Heritage Park to help children learn some easy rope tricks.

A simple puff of air should have made those knots disappear but blow as they might, only the master magician could make them vanish.





"ONE MORE FOR the road?;" Jamie Attenberg seems to be asking Jamie was at the Beer Can Swap held at Chevy Chase Country Club Saturday, March 4. The event was sponsored by the Indian Trails Library District, Wheeling Park District and Buffalo Grove Park District. (Photo by Lisa Ebright.)

JULY 20, 1978



UNDER THE WATCHFUL EYE of Judy Juergensen, left, Kelli Werba finishes her 59th lap at Neptune's pool during the Swim-a-Thon held Sunday, July 16 for the heart association. (Photo by Steve Donisch)



ADULTS



THE STAFF



EXERCISE FOR ALL



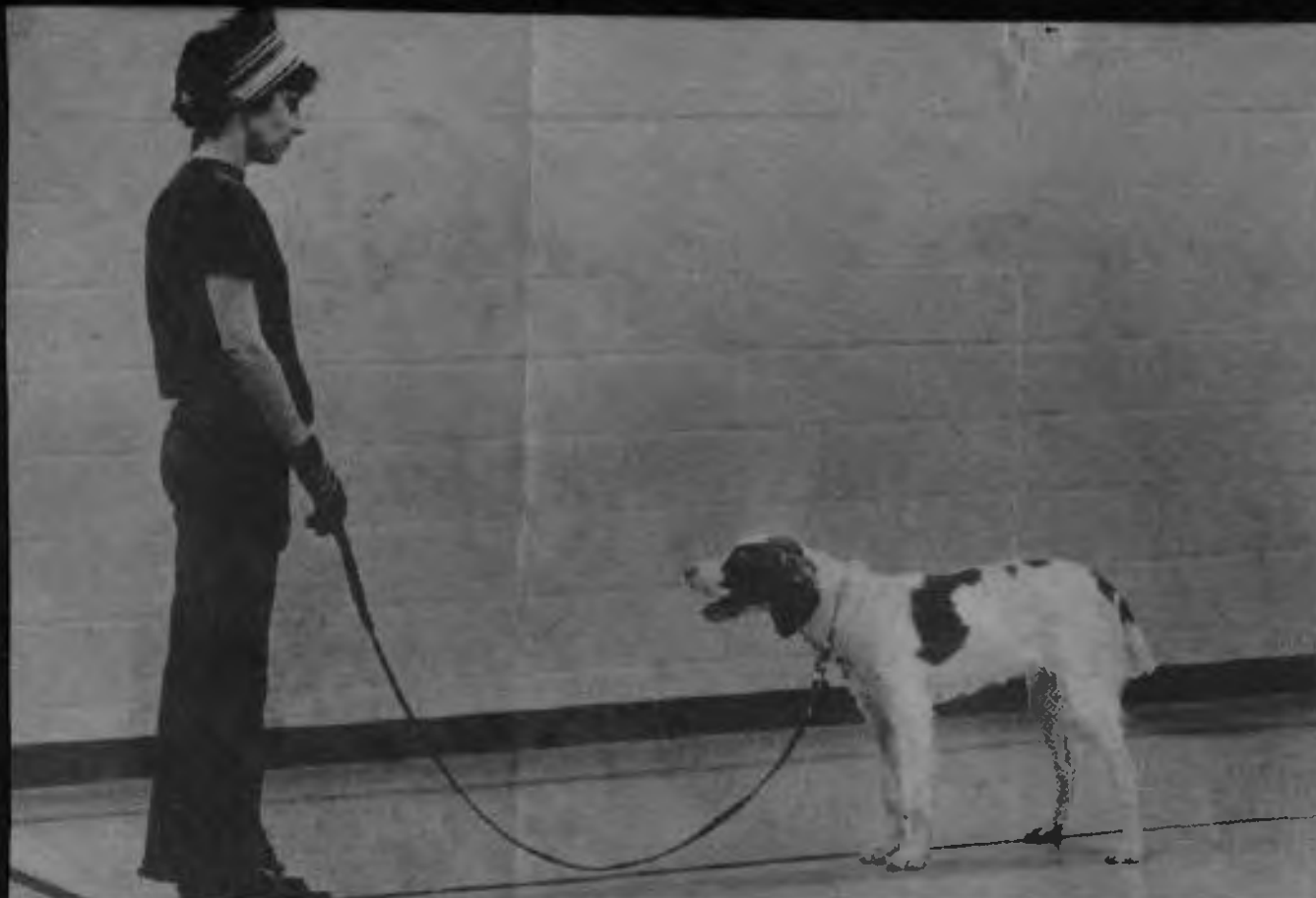

The Wulffs just part of the dog obedience training process

"DOG OBEDIENCE is fun."

With that maxim, Jerry Wulff and his wife, Helen, launched another dog obedience class last week at the Wheeling Park District's Heritage Park.

Wulff and the park district offer eight-week courses for dogs — and their owners — several times a year. Two classes are offered each time, one for beginners and one for the

advanced. The cost is \$15.

AMIDST A VARIETY of dogs, from poodle to doberman, and an even broader range of names, such as Gretta, Tuesday, Duchess, and Fern, Wulff encourages each dog owner to let the pet know who's really boss.

Wulff, a Skokie resident, got into dog training and dog obedience after taking a

similar class himself. He became so enthused about the value of such training, that he and his wife now offer courses regularly.

The beginners class went well, with only a few students having to be excused to relieve themselves. Wulff's techniques center on the owner taking charge of his dog and letting the dog know it.

But instead of causing problems, Wulff

said that such a philosophy, coupled with the obedience classes, become very enjoyable for the dogs especially, because it means an hour of uninterrupted attention for the dog from his owner.

"Before too long, your dog will be beating you to the car to come to the lessons," Wulff said.





FINGER-SNAPPING and heel-clicking Karen Blonn leads students in the Wheeling Park District's adult tap dance class through a new step. The class meets Tuesday nights at Heritage Park.



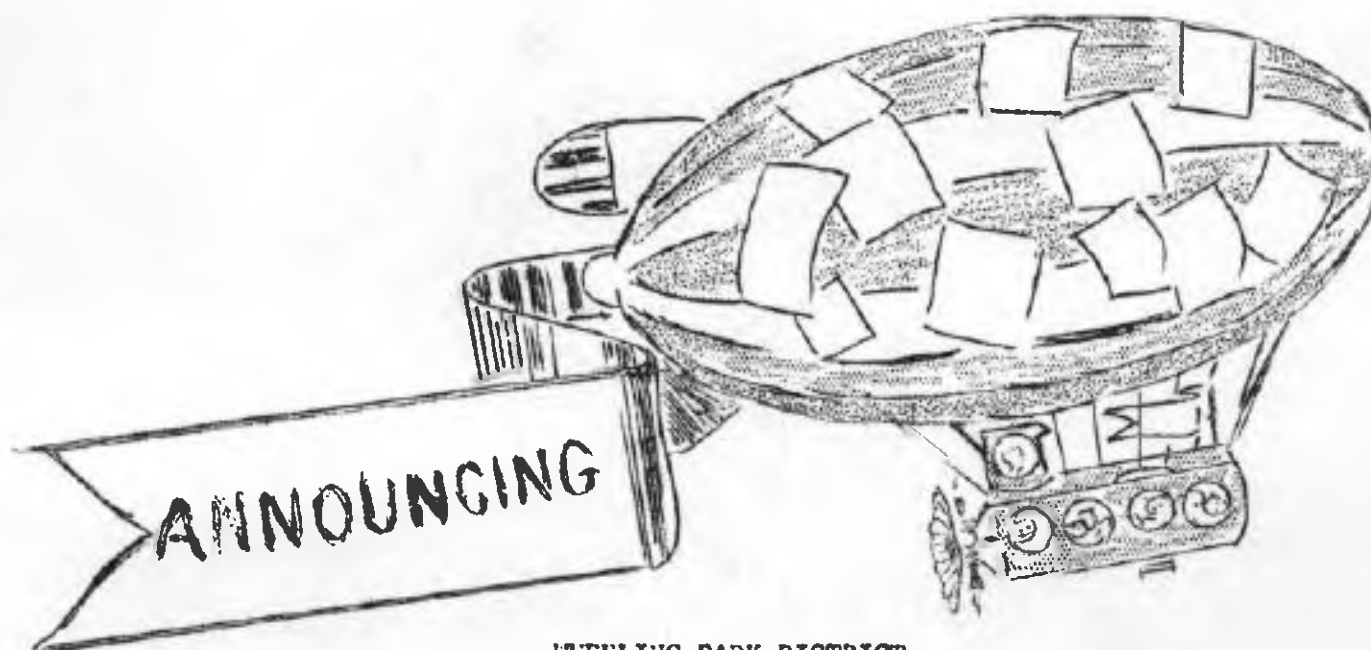

WHEELING PARK DISTRICT
FEMINIQUE PROGRAM

On Wednesday, October 5th, 1977, the Wheeling Park District will be going to Harriotts Lincolnshire Resort in Lincolnshire, Ill.

We will have a buffet luncheon starting at 12:00 noon which will include entrees such as beef, chicken, fish, hot vegetables, potatoes, and salads. After lunch we will be escorted to the Theatre, for the matinee showing of the "Music Man".

The cost is \$13.50 per person (\$13.00 for Senior Citizens). The cost includes theatre, buffet lunch, gratuity and transportation.

SCHEDULE

11:30 a.m.	Bus leaves Heritage Park
12:00 noon	Buffet Lunch
2:00 p.m.	Matinee Show "Music Man"
4:35 p.m.	Bus leaves Theatre
5:00 p.m.	Bus arrives Heritage Park

Sign-up is now being taken at Heritage Park, 222 S. Wolf Road

Sign-up deadline: Monday, October 3, 1977

HURRY ON IN. TIME IS RUNNING SHORT

WHEELING PARK DISTRICT
OCTOBER 1977

THE WHEELING PARK DISTRICT, BUFFALO GROVE PARK DISTRICT AND
INDIAN TRAILS PUBLIC LIBRARY ARE COMBINING EFFORTS TO GIVE A
FREE LECTURE A MONTH ON A WIDE VARIETY OF SUBJECTS. THE
LECTURES WILL BE HELD AT VARIOUS LOCATIONS IN THE AREA.

OUR SCHEDULE TILL MARCH IS:

NOVEMBER 15 - DREAM ANALYSIS
DECEMBER 6 - PYRAMID POWER
JANUARY 17 - HELP WITH YOUR INCOME TAX
FEBRUARY 21 - INDOOR GARDEN SWAP
MARCH 4 - BEER CAN SWAP

PLEASE CALL WHEELING PARK DISTRICT, 537-2222 FOR MORE INFORMATION.

SENIOR CITIZEN PROGRAMS

WHEELING PARK DISTRICT SENIOR CITIZEN NEWSLETTER



SENIOR CITIZENS

All of our adult recreational programs listed in the Summer brochure are available to Wheeling Park District residents over 50 years of age for one-half the stated price. In addition we are offering other leisure time activities that are listed separately. We hope you enjoy our programs and we ask you to let us know of any other interests we can help you pursue. Call 537-2222 if you desire further information.

A DAY OF NATURE FOR SENIOR CITIZENS

Join us on this beautiful morning hike through Lake County Forest Preserve District, Edward L. Ryerson Conservation Area in Deerfield.

We will go through the woods and spot birds that are currently using the area and looking at the wildflowers along the way.

Wear comfortable clothing and footwear. In case of rain, we will go another day that week! Bus transportation will be provided from Chamber Church.

This spectacular event is on Monday, July 17, from 9:30 to 11:00 a.m. and it is free.

SENIOR CITIZEN SWIM

The heated indoor pool will be yours for a morning dip. Come out and have a leisurely swim. Bus transportation will be provided from Chamber Park to the pool and back.

Bring a towel and swim suit to the community outdoor pool on Tuesday, June 13, Swim from 10:00 to 11:00 a.m. for only .50¢.



SENIOR CITIZEN LAS VEGAS DAY

The Wheeling Park District and The Chicago Sting (Professional Soccer Team) are presenting a special attraction. At the game, tickets for two to Las Vegas will be given to 40 lucky persons.

The game will feature the The Chicago Sting vs. Colorado.

If you have never seen a soccer game before, this is your opportunity to see the largest growing sport in America.

Come try your luck and see the largest growing sport in America on Sunday, July 9. V.I.P. tickets are \$7.00. The bus will leave Heritage Park at 12:45 P.M. and return at 5:45 P.M.

SENIOR CITIZEN SHUFFLEBOARD TOURNAMENT

A shuffleboard tournament will be held for senior citizens on Saturday, July 15. The event will be held at Chamber Park 251 N. Wolf Road. The fee will be \$1.00 per person. Prizes will be awarded to the champion and runner-up. Sign up will be taken at Heritage Park, 222 S. Wolf Road. The event is just for fun and all senior citizens are welcome to participate. Sign-up deadline is Wednesday, July 12. ALL REGISTRATION IS TAKEN AT HERITAGE PARK.

SENIOR CITIZEN CRAFT WORKSHOP

In this special one-day workshop you will make your own decoration or gift. Come join the fun and show your talents. At the Chamber Church on Monday, June 12, from 9:30 to 11:30 a.m. The \$2.00 fee includes all supplies.



MEET THE PILLOW people. One of them seems to be having trouble keeping his pants up. The pillow people are from the Wheeling park district camp program and entertained at a senior citizens picnic held Wednesday, July 26 at Chamber park. (Photo by Lisa Ebright)



M. RUFFIN (LEFT) and Tracy Falco look busy eating at the senior citizen picnic given last week by the Wheeling park district. Campers from the park district program were each assigned to a senior citizen for the duration of the picnic. (Photo by Lisa Ebright)



Daily Herald Photo

PICNICKERS MARLA Goldberg, left, and Myna Nielsen head for shelter when a wind storm Wednesday interrupted the Wheeling Park District picnic for senior and junior citizens. They gathered at Heritage Park, 222 S. Wolf Rd., for an old-fashioned picnic of games, skits and refreshments.

TEEN CENTER NEPTUNE'S DEN



SHOT AND A GOAL! Mark Pawlik, foreground, scores on Greg Biancalana during an air hockey game at Neptune's Den in Wheeling. The den is located above the

indoor pool at Wheeling High School and is run by the Wheeling Park District. It is open for students during lunch periods, after school and Sundays.



PARK DISTRICT GROUPS



BUBBLE BLOWING Chris Ambrose, 15, a Wheeling High School student, paints a jungle gym post while giving her bubble gum a real workout. Miss Ambrose braves the summer heat to do a variety of maintenance chores for the Wheeling Park District.

(Photo by Dom Najolia)





Santa, Mrs. Claus greet children in Lollipop Lane

Lollipop Lane is where it's at

Youngsters this week are whirling through "Lollipop Lane" to present their Christmas requests to Santa Claus.

Sponsored by the Wheeling Historical Society, the lane is open at the Chamber Park Community Church on north Wolf Road.

Santa and Mrs. Claus will be at "Lollipop Lane" from 6:30 to 8:30 p.m. today and from 2 to 5 p.m. Saturday and Sunday.

An open sleight, a replica of those made around 1900, is on display, courtesy of Sister Mary Bridget of Addolorata Villa.



Lights sparkle at Santa's Lollipop Lane in Wheeling.

NORTHWEST SPECIAL RECREATION ASSOCIATION

nwsra is:



Growing



Sharing

A helpful hand is appreciated when venturing into new situations.



Everyone hold tight for your ride on the Chicago Loop at "Old Chicago."



*Now you're ready to show
your talents to the world.*



*With a little concentration
and skill, all the pins will fall.*

LEARNING LIFETIME SKILLS THROUGH LEISURE EDUCATION

The concept of the leisure education program stems from the different experiences for children in special education. The goal of the Northwest Special Recreation Association leisure education program is to provide a third avenue of expression and experience for the children we serve. The feeling of the NWSRA therapeutic staff is that our program participants have had extensive and varied home and school experiences, but are lacking in social outlets, recreational skills and interests. By transporting the participant to various community facilities, during school hours, they are able to experience different leisure activities. Leisure Education programs include bowling, swimming, ice and roller skating, and racquet ball. Future programs could include hockey, cross-country skiing, and horseback riding.



*Campcraft skills can best be taught outdoors at Sunrise
Lake Camp, where everyone can get into the act.*





Recreation provides building blocks for mind, body rehabilitation

By TINA LABELLARTE

A young man recently spent his first paycheck on taking his parents out to dinner. It was more than a nice gesture. It was something the mildly handicapped youth never thought he'd be able to do.

The Northwest Special Recreation Association (NWSRA) gave the youth a chance to earn the cash by working at a day camp cooking hotdogs for more than 300 people.

"In administration we tend to justify programs by statistics. A real-life individual story like this makes one regain a perspective on what we're doing — serving people with special

needs," NWSRA Director Kevin Kendrigan said.

Although Kendrigan said work experience is necessary for the handicapped, NWSRA's major emphasis is on helping the handicapped spend leisure time.

"Housing, jobs, education, support and counseling are all necessary. We are a leisure service — an important part of the total picture," Kendrigan said.

NWSRA was established about five years ago and is run through 14 cooperating park districts in the Northwest suburbs. Participating districts include Buffalo Grove, Wheeling, Palatine,

Arlington Heights, Elk Grove, Hanover Park, Hoffman Estates, Mount Prospect, Prospect Heights, River Trails, Rolling Meadows, Salt Creek, Schaumburg and Streamwood.

"Our approach is that we are an extension of the local park district. We serve people with temporary or permanent special needs because recreational programming has to be available to all residents. If some residents have special needs it is the responsibility of government agencies to meet those needs," Kendrigan said.

Elena Ruane, the Palatine NWSRA representative who has been involved

with the association since its inception, said the group is highly successful.

"Programming for the handicapped is something park districts would have liked to fit into their programs, but weren't able to. Now special needs are being met through cooperation," she said.

The small number of people served and the high cost of providing programs in a single park district makes a regional type of association a necessity according to Kendrigan.

The 65 programs now offered by the NWSRA are directed toward area residents who are learning disabled, educable mentally handicapped, multiply handicapped, hearing impaired and visually impaired.

Buffalo Grove's representative Stan Crosland is concerned that the public doesn't understand who NWSRA serves.

"We serve far-reaching groups, not just the mentally handicapped which some people seem to think," Crosland said.

Kendrigan said the association offers as great a variety of programs as the limiting factors of age group, geographical location and interest allow.

Activities available include swimming, bowling, tennis, dance, guitar, piano, crafts and ceramics, ice skating, three-day amusement park vacation trips, ski trips and a social club for young adults.

Many programs are run in cooperation with the Northwest Suburban Special Education Organization (NSSEO). Kendrigan said most NWSRA program users first hear of the association through NSSEO, Clearbrook Center or other special interest groups for the handicapped.

Kendrigan said NWSRA strives to educate children about leisure at a young age.

"A normal child learns about leisure beginning at age one, but a handicapped child usually isn't exposed until age 12 or 14," Kendrigan said.

Leisure time must be dealt with as a handicapped person reaches adulthood.

"By then many can lose their parents when they are still dependent. They are unable to get jobs most of the time and are faced with 24-hour a day forced leisure," Kendrigan said.

Dave Philips, Wheeling's NWSRA representative, thinks leisure programming has to be a continuous process.

"It's up to the association to begin a



At the line...



STRIKE

**CHEVY
CHASE**

KILLIAN AND NUGENT

1000 N. W. 10th St. Miami, Fla. 33136

August 1, 1964

Mr. J. H. ...
...
...

Dear Sir:

MASTER REDEVELOPMENT PLAN

CHEVY CHASE GOLF CLUB

WHEELING PARK DISTRICT

WHEELING, ILLINOIS

Enclosed for you are the following report:

The purpose of this study was to develop the existing site plan and to make recommendations for the improvement of the site. The following items were included in the study:

1. To determine the existing site plan and to make recommendations for the improvement of the site.

2. To determine the existing site plan and to make recommendations for the improvement of the site.

3. To determine the existing site plan and to make recommendations for the improvement of the site.

4. To determine the existing site plan and to make recommendations for the improvement of the site.

5. To determine the existing site plan and to make recommendations for the improvement of the site.

6. To determine the existing site plan and to make recommendations for the improvement of the site.

7. To determine the existing site plan and to make recommendations for the improvement of the site.



Park board thanks voters

THE PARK BOARD wishes to express its appreciation to the electorate for the large plurality it gave the park district (four to one) to purchase the open space and facilities accompanying the Chevy Chase Country Club and the Childerley Retreat site.

Eighteen hundred and fifty two residents voiced their opinion and of that amount, approximately 1,445 citizens said yes.

To those people who were supportive of the referendum, thank you. To those residents who opposed the issues, thank you for voicing your opinion and taking the time to exercise your right to vote.

The majority of the voters have evidenced the need for more open spaces and less high density developed acreage, and have given us a mandate to proceed with the proper implementation of these newly acquired sites.

We look forward to the forthcoming challenges before us, ever mindful that you've made the commitment possible and we will continue to serve you as best as we can, ever mindful that open space and recreation are our primary concerns.

Wheeling Park District
Board of Commissioners
Frank Schnaittmann Lorraine E. Lark
Doris Kerr Robert E. Ross



Blue



Washroom Use.

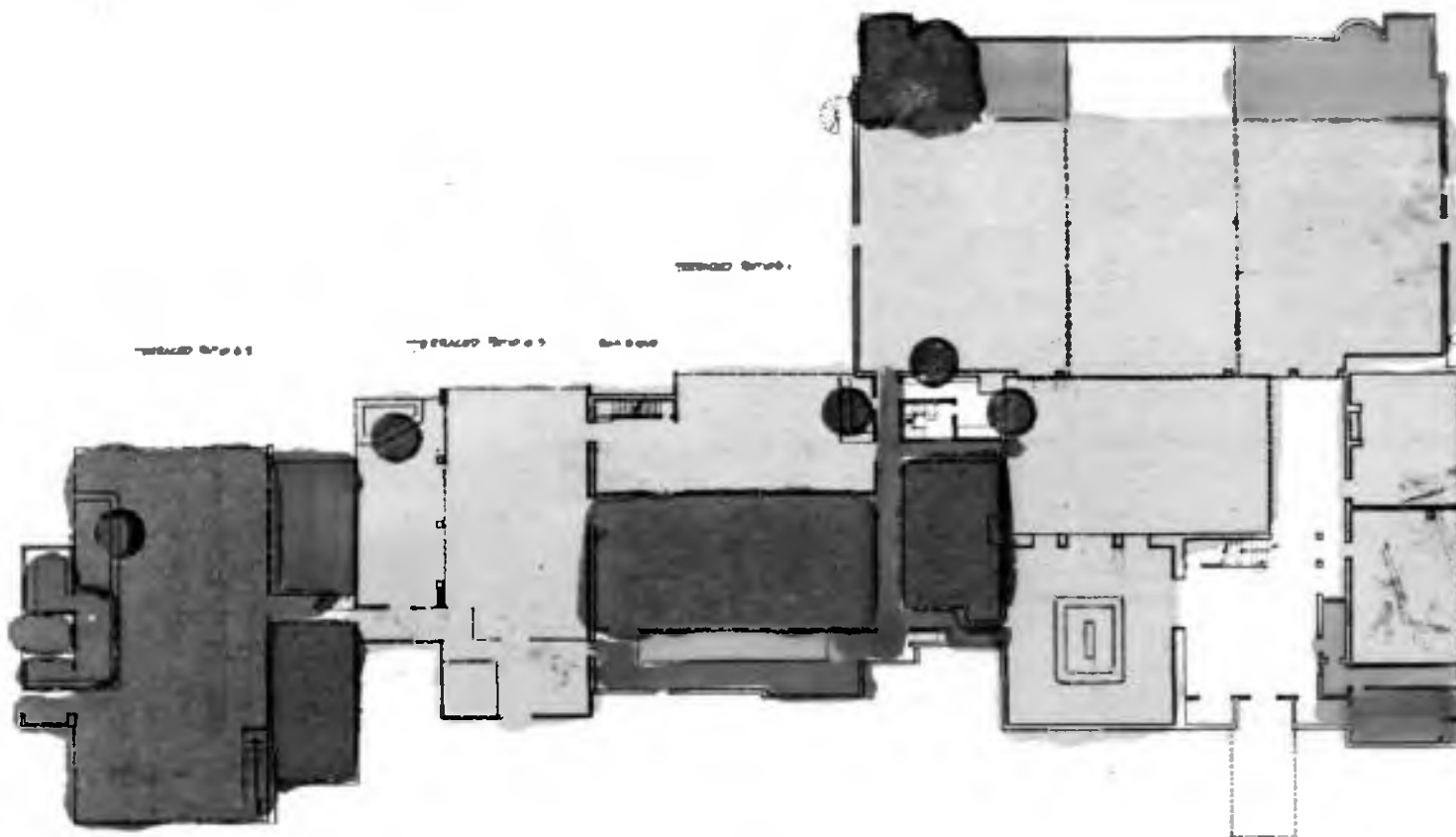

GRADE LEVEL SCHEMATIC PLAN

WHEELING PARK DISTRICT CHEVY CHASE CUSTOMER CONTRACT

ORGANIZATION _____ RESERVATION DATE/S _____
 ADDRESS _____ DAY/S _____
 CITY _____ ZIP _____ TIMES _____
 TELEPHONE _____ ROOM REQUESTED _____
 CONTACT PERSON _____ TYPE OF FUNCTION _____
 ADDRESS _____ NUMBER IN GROUP _____
 CITY _____ ZIP _____ GUARANTEED NUMBER _____
 HOME PHONE _____ TAKEN BY _____ DATE _____

ROOMS AVAILABLE:

	COMMERCIAL		PRIVATE		COMMUNITY	
	PRIME TIME	NON-PRIME TIME	PRIME TIME	NON-PRIME TIME	PRIME TIME	NON-PRIME TIME
Main Ballroom	\$ 600/Night	500/Night	\$500/Night	400/Night	\$ 400/Night	300/Night
Wayside Room	20/Hour	15/Hour	20/Hour	15/Hour	15/Hour	10/Hour
Hunt Room	15/Hour	10/Hour	15/Hour	10/Hour	10/Hour	7.50/Hour
The Abbey	25/Hour	20/Hour	25/Hour	20/Hour	20/Hour	15/Hour
Gable Room	20/Hour	15/Hour	20/Hour	15/Hour	15/Hour	10/Hour

NOTE: Main Ballroom fees is based on usage not to exceed 7 hours. In excess of 7 hours, room rental rate of \$50.00 per hour is applicable. Additional hours to be mutually acceptable.

REMARKS: _____

ROOM SELECTED: _____

FOOD MENU:

SERVING TIME _____



ROOM RENTAL _____
 PLUS FOOD BILL _____
 DIVIDED BY GUARANTEED NUMBER _____

BAR:

BAR OPEN _____

BAR CLOSED _____

BAR PRICE PER PERSON PACKAGE _____

COMMENTS: _____

BAR PRICE BY THE DRINK _____

TOTAL BAR \$ _____

OTHER COSTS:

TOTAL OTHER COSTS \$ _____

BEVERAGE TOTAL _____

FOOD TOTAL _____

SUB TOTAL \$ _____

GRATUITY _____

TAX (If applicable, Tax Exemption #) _____

SUB TOTAL \$ _____

ROOM RENTAL _____

OTHER CHARGES _____

SUB TOTAL \$ _____

TOTAL AMOUNT DUE \$ _____

LESS 25% DEPOSIT \$ _____

BALANCE DUE \$ _____

REFERRED TO CHEVY CHASE BY:

Newspaper _____ Yellow Pages _____ Friends/Relatives _____ Other _____

Attended a Previous Function _____ What ? _____

Customer or Authorized Representatives, Signatures: _____

Function Booked by: _____, Catering & Bar Coordinator

Date: _____

APPROVED BY: _____, Authorized Signature



FILL OUT AND RETURN THIS STUB TO:
IAPD, 300 E. Monroe, Springfield, IL 62701

Name _____
Title _____
Address _____
Phone _____
City, State, Zip _____
Legislative District # _____

- ☐ GOLF ONLY
☐ GOLF & DINNER
☐ DINNER ONLY
☐ GAS GOLF-CART

5451



FIRST ANNUAL I A P D Golf Invitational and Dinner

FRIDAY - AUGUST 4, 1978

at the magnificent Chevy Chase Country Club

1000 N. Milwaukee Avenue - Wheeling, IL

"A Wheeling Park District Facility"

GOLF
10:00 A.M.

COCKTAILS
5:30 P.M.

DINNER
6:30 P.M.

GOLF PRIZES — DOOR PRIZES — FUN

5451

Reveal \$1 million plan to improve golf course

By JOANNE KANTER
Correspondent

WHEELING—A \$1 million master plan for renovation of the Chevy Chase golf course has been presented to the Wheeling Park District Board of Commissioners.

Architect Richard Nugent of the firm of Killian & Nugent said the plan for renovation will take 15 to 20 years to complete and will be done in phases.

Nugent has redesigned several holes, changing them around, lengthening some and shortening others and calls for four tees on each hole which will give golfers the choice of playing a short- medium- or long-range game. The fourth tee will be for tournaments.

The architect said the golf course is typical of many courses built 50 years ago which were constructed in the expansionist days of the '20s and neglected during the depression, war years and post-war period.

The architect said the greens and tees have been redesigned to meet today's standards.

NUGENT SAID THE open character of the golf course, which has been produced by the lack of a consistent tree-planting program, in conjunction with the loss of many older trees, will be maintained. However, some plantings will be added to provide a protective barrier and to screen off objectionable views.

The greens are small by modern standards for public courses, said Nugent. However, he added that they are integral to the design and character of the course and have held up well over the years. In order to maintain continuity on the course, Nugent proposed maintaining the new greens at a similar size to the old ones.

Teeing areas will be enlarged and given pleasant curving shapes which will provide an aesthetic feature, according to Nugent.

Mounding will be used extensively in the renovation which will continue the "Scottish links" atmosphere of the course. Nugent said the mounds will also relieve the flatness of the course to some degree and will provide pro-

TECTIVE screening and serve as good golf hazards that are easy to maintain.

WATER WILL BE the prime hazard on the Chevy Chase golf course since lakes must be excavated in order to provide fill for the Johnson family, according to an agreement signed with the park district at purchase time.

Nugent said the course will be designed "to bring water into play in a variety of interesting ways." There will be water on par 3, 4 and 5 holes, tee shots across the water and approach shots across water.

The short course will be 5,310 yards, with the medium course designed for 6,180 yards and the long course, 6,660 yards. The tournament course will be 6,800 yards. Nugent suggested that people who play twilight golf might like the short course no matter how good golfers they are, as they will finish faster than on the other courses.

PHASE I, which will consist of building 12 small bridges, maintaining two bridges, rebuilding one green, three tees, three traps, three mounds, removing three traps, clearing trees, and work on the parking lot and clubhouse grounds, will cost an estimated \$136,985.

Phase II will consist of rebuilding six greens, 35 tees, and 10 mounds at a cost of \$338,700 and Phase III will consist of new irrigation for the tees, greens and fairways at a cost of \$299,775.

Phase IV will consist of building 12 greens, three traps, 12 mounds and cartpaths at a cost of \$305,125. The total cost is estimated at \$1,080,585.

Nugent said he arrived at the cost figures by taking figures for work performed at Sunset Golf Course in Highland Park last summer and adding 10% for inflation costs. He said it is expected the park district will provide some original money to begin work but that course fees should provide the rest of the funds.

Park district commissioners said they will set a date for a public meeting at which time residents may give input into the plan before it is approved.



GOLF COURSE

MASTER DEVELOPMENT PLAN

The golf course architectural firm of Killian and Nugent have completed the master redevelopment plan. The plan has been reviewed by the staff and many interested persons and approved by the Board of Commissioners of the Wheeling Park District.

PHASE I 1978

The first phase of redevelopment will include the following, on a priority basis.

1. Build a new green, traps, and irrigation around the green to the left of the present No. 4 green.
2. Build three new tees and irrigation to the tees in front of the present No. 5 tees. This work will begin in early June and be completed by late Fall.
3. New bridges over creeks.
4. Dredging and reshaping the creeks.
5. New tee signs.
6. Redevelopment of sand trap on the left side of No. 1 fairway.
7. Remove the sand trap on the right side of No. 1 fairway.
8. Placement of new trees on the left front corner of No. 1 tee.
9. Redevelopment of No. 1 tee.

GOLF COURSE MAINTENANCE

The golf course superintendent and his staff will be involved with all future capital improvements. Some additional work to be done in early Summer is as follows:

1. Redevelop all sand traps for conformity with the master plan.
2. Remove the traps that are not considered part of the future plan.
3. Improve some cart paths and redirect others.
4. Renumber the back nine.
5. Relocate the starter's station.
6. Aerate and fertilize greens, tees and fairways.
7. Improvements on the present manual irrigation system.

WHEELING PARK DISTRICT
WEEKDAY 10 PLAY PASS
DAY TIME (MONDAY-FRIDAY) 201
CHEVY CHASE GOLF COURSE
RESIDENTS ONLY - 1978 SEASON

NAME		ADDRESS		TELEPHONE	
AGE	FEMALE MALE	COLOR	HAIR	COLOR	EYES
1	2	3	4	5	6
7	8	9	10		
TO BE PRESENTED EACH TIME					
NON-TRANSFERRABLE					
9 HOLES - 1 Punch					
18 HOLES - 2 Punches					



I Play Golf At CHEVY CHASE

Wheeling Park District

TO: Board of Commissioners, Wheeling Park District
FROM: David F. Phillips, Superintendent of Parks and Recreation
Vernon Verstraete, Director of Chevy Chase Operations
RE: Golf Cars- Comparison Lease vs. Own
DATE: February 27, 1978

I. INTRODUCTION- The average Chicagoland figures for golf car usage is between 110-120 rounds per car per season. The type of golf car we purchase will not affect the total number of cars rented because a golfer will not make his/her decision to rent a car on the brand name. If the cars are well maintained and in good operational order to go 18 holes the cars will be used regardless of their power source (gas or electric), age, name brand or other outside criteria.

It should be stressed that golf cars whether leased or owned, while being a service to the golfer, are from our golf course ownership point of view, a source of much needed added revenue.

This study attempts to determine our best approach to providing this service and adding to the revenue of our golf course operation. We seek to prove that owning golf cars is more cost effective than leasing cars.

II. HISTORICAL BACKGROUND -1977 SEASON - We leased gas cars from a golf course golf car leasing firm with a 50% -50% split on rental revenue. Their contract was extended from the previous owner's commitment for the season.

	PREVIOUS OWNER* 4/1/-5/30/77	WHEELING PARK DIST. 7/1/77-11/30/77	COMBINED EXPERIENCE
Rental Paid to Leasing Company	8,707.77	15,719.50 **	24,427.27
Other Expenses (Gas, Oil, Keys)	?	1,874.00	?
Total Expenses	8,707.77	17,593.50	26,301.27
Less Total Rental Revenue	18,027.04	30,827.50	48,854.54
Net Gain	9,319.27	13,234.00	22,553.27

NOTE: * All previous owner figures are determined based on known Wheeling Park District facts and known golf car company records.

** Includes 1030.00 paid for extra car rental.

III. BANK LOAN- Director of Chevy Chase Operations Verstraete and I have discussed with the Board the possibility of purchasing 40 golf cars. To cover the initial expenditure required contact was made with the Wheeling Trust and Savings Bank on a short term loan. Our projected retirement program would cover a 5 year period, with an interest rate received of 5½%. Annual interest due would be based on the actual outstanding principle.

As bids received varied from \$62,000 to \$72,000 to purchase these 40 cars, the following debt retirement schedules would be applicable based on acceptance of the low, or high bids.

WHEELING PARK DISTRICT
SUMMARY OF BIDDER SURVEY
COMPILED BY DAVID F. PHILLIPS, SUPR.

QUESTIONS	NADLER HARLEY-DAVIDSON	KHRAN'S HARLEY-DAVIDSON	-POLARIS E-Z-GO	NAPERVILLE INDUSTRIAL MARKATEER/WESTINGHOUSE	BOYLAN CLUB CAR	BOYLAN MELEX
1. Service & Parts Shipping Location	Aurora	Woodstock	Lake Zurich	Naperville	Bensenville	Bensenville
2. Electrical Charge (Av. holes)	36	45	36	36	75-105 /12 hr charge	45-54 holes-1st year 36-45 holes-2nd year
3. Response time for Service/parts	48 hrs/service ship imm/parts	48 hrs/service ship 24 hrs/parts	24 hrs	24 hours	24 hrs(6 days)	24 hrs (6 days)
4. What parts do you not stock? & shipment time	- 48 hrs or less unless ord on Fri.	Main frame & body sec. 5-10 days normal	1-2 days	Body Parts Same day ship-except for Body Parts- 2 weeks	Same day Ship.	Same day shipment
5. 5 year trade-in value % of purchase price	35%	35%	30%	30%	35%	25%
6. What can we as a purchaser expect on 1st year, 2nd year, 3rd year costs on a per car basis for parts, service & typical maintenance on your cars	1st - warranty 2nd - \$165 av. 3rd - \$165 4th - \$165 5th - \$165	warranty \$65 \$325 \$100 \$150	warranty warranty \$45 \$55 \$75	warranty 0-\$30 \$234 \$70-140 \$300	warranty warranty \$250.00 \$10 \$265	warranty \$10.00 \$250.00 \$10-15 \$265
5 year total	\$660	\$640	\$175*	\$604-704	\$525	\$535-540
	x 40 cars	x 40 cars	x 40 cars	x 40 cars	x 40 cars	x 40 cars
Projected Fleet cost for Parts,service & typical maintenance	\$26,400	\$25,600	\$27,000 <i>+ 500 / 2.4 hrs</i>	\$24,160 - \$28,160	\$21,000**	\$21,400-21,600
Combined average \$24,960						
7. Average Gross Annual Income to be expected per car	\$1200 x 40 \$48,000	\$1100-1200 \$44-48,000	\$1265-1380 \$50,600-55,200	\$900-1200 1st year \$36,000-48,000	Depends on rounds and our fee	140 rounds**** x \$10/round \$1400 \$56,000

Cherry Chase

WORLD'S FINEST COUNTRY CLUB



the famous
Grill Room
menu

G-R-I-L-L R-O-O-M

D-I-N-N-E-R

1. FRIED CHICKEN, Country Style.....\$ 2.66

Sunny Acres Farm Premium Chicken
Special Strain
Raised Especially for Distinctive Eating

2. FRENCH FRIED JUMBO GULF SHRIMP, served with pestful sauce \$3.25
3. BAKED SUGAR CURED COUNTRY HAM, candied sweet potato..... 3.50
4. BROILED WHITEFISH..... 3.75
5. ROAST PRIME RIB OF BEEF AU JUS 4.50
6. BROILED SIRLOIN STEAK (U. S. PRIME)..... 6.50
7. BROILED SIRLOIN BUTT STEAK (U. S. PRIME)..... 3.65

The above includes

CHEVY CHASE SPECIAL SALADS
Whipped or French Fried
Potatoes

Homemade Baking Powder Biscuits
Homemade Corn Bread

Coffee - Tea - Grade "A" Milk

DESSERTS

Pies Baked in our own Kitchen

All pies (except Strawberry)	30¢	Homemade Strawberry Short-	
Strawberry Pie.....	35¢	cake topped with whipped	
		cream.....	50¢

Chocolate or Strawberry Sundae 40¢
Chocolate, Vanilla, Strawberry Ice Cream or Sherbert 25¢

CHEESE: Camembert 40¢ Requefort 35¢ Liederkranz 35¢
(Served with toasted crackers)

Child's portion (Under 10 years of age) Entree except Steak
and Roast Beef, served with milk, ice cream and cookie \$1.35

The above prices are our O.P.S. Ceiling
Prices or lower. A list of our ceiling
prices for each item is available for
your inspection.

Please be patient, your
dinner is cooked to order.

We regret we cannot be responsible
for loss or exchange of personal
property

From the Grill Bar

Cocktails

Martini	60	Whiskey Sour	60
Manhattan	60	Rum Sour	60
Daiquiri	60	Tom Collins	60
Bacardi	60	John Collins	60
Old Fashioned	60	Rum Collins	60
Sloe Gin Fizz	60	Rob Roy	60
Gin Rickey	60	Stinger	70
Cuba Libre	60	Alexander	70
Dubonnet Cocktail	60	Pink Lady	70
Frozen Daiquiri	70	Clover Club	70

Bonded Bourbons

Old Fitzgerald	65	I. W. Harper	65
Old Taylor or Old Forester	65	Early Times	65
Old Grand-Dad	65	Fleischmann's	65

Straight Bourbons

Early Times	60	Beam's (Pin Bottle)	65
Old Quaker	60	Bar Whiskey	45
Walker's De Luxe	60	Old Overholt Rye	60

Scotches

Black & White or Teacher's	60	Johnnie Walker's Black Label	75
Dewar's White Label	60	Haig and Haig (Pinch)	75
Johnnie Walker's, Red	60	Peter Mackenzie (12 yrs. old)	75

Brandies

Hine ★★★	75	Hennessy ★★★	80
Monnet or Courvoisier	80	Metaxa ★★★	80

Cordials

Benedictine and Brandy	75	Cointreau	70
Blackberry	60	Crede de Cacao	60
Drambuie	75	Crede de Menthe	60
Grand Marnier	75	Cherry Heering	75

Champagne and Burgundy

Domestic Champagne	6.00	Domestic Sparkling Burgundy	6.00
Imported Champagne	12.00	Imported Sparkling Burgundy	12.00

Bottled Beer and Ale

Pabst Blue Ribbon or Schlitz	30	Old Style Lager (8 oz.)	25
Miller High Life	30	Budweiser	30
Coca-Cola	15	Seven-Up	15

CHEVY CHASSEL

WHEELING PARK DISTRICT

ISSUE 4 NEWSLETTER AUGUST 1978

GOLF COURSE DEVELOPMENT

Work will begin as soon as possible on building a new green on number four fairway, dogleg left. The present green will be used until the new green is ready for play.

A new tee will be constructed on fairway number four to the north of the present tee. This will add yardage to this hole to permit a par five, number five tee will be moved forward and shorten, the yardage to become a par four hole.

Work will continue to develop the fairway sand traps.

CHEVY CHASE SCRAMBLE TOURNAMENT

Get your foursome together and enter this tournament. This should be a lot of fun for all and the foursome total handicap must be a minimum of 45 strokes.

Every team has a chance to win. We are limited to 15 teams! 1st tee time 7:00 a.m. to 8:52 a.m. Pick up an entry blank at the Pro-Shop. REMEMBER..1st 15 teams entry blanks received will play.

PRIZES, FOOD AND REFRESHMENTS ARE INCLUDED IN ENTRY FEE.

TIP FROM THE PRO SHOP

Improve your game with GOLF LESSONS, Private or Group...talk to the Pro-Shop for time and dates.

GOLF OUTINGS

We still have times and dates for Golf Outings. Call 537-2930 to check for a date for your outing.

FOR GOLF, BUSINESS OR PARTY TIME....
CALL NOW 537-2930

Parks help kids get into swing

Although golf is a sport that has long been enjoyed by adults, its popularity with the young has increasingly grown. That's what the Wheeling Park District had in mind when setting up its special golf programs for the young people. Registration for both the junior and youth day programs is on a first come first serve basis and is taken in person at Heritage Park, 222 S. Wolf Road. A fee of \$5 buys a six-week program featuring golf etiquette, basic lessons and rules of the course. The junior duffers tee off on Friday June 23. The 12 and under age group will meet each Friday until July 28 at 9 a.m. at Chevy Chase Golf Club. The youth program is designed for the 13-16 age group and meets from 8 to 10 a.m. each Monday beginning June 19 and ending July 24. The fee and location is the same as for the juniors. The youth day group will learn the establishment of handicaps, as well as golf etiquette, basic lessons and rules of the course.

